



sneddons
solicitors & estate agents



21 Ash Grove

Blackburn, Bathgate, EH47 7QJ

Offers over £120,000



Welcome to this charming property located in the picturesque Ash Grove, Blackburn, Bathgate. This delightful house boasts a cosy reception room, perfect for relaxing or entertaining guests. With two bedrooms, there is ample space for a small family or for those who enjoy having a guest room or home office. The property also features a well-appointed bathroom, ensuring convenience and comfort for the residents.

Nestled in a tranquil neighbourhood, this house offers a peaceful retreat from the hustle and bustle of city life. The location provides a perfect blend of suburban serenity and easy access to urban amenities, making it an ideal choice for those seeking a balanced lifestyle.

Whether you are looking to step onto the property ladder or searching for a new place to call home, this house in Ash Grove presents a wonderful opportunity. Don't miss the chance to make this property your own and enjoy the warmth and comfort it has to offer.



Description

Presented to the market in walk-in condition, this lovely mid-terrace family home is situated in a quiet cul-de-sac within the town of Blackburn. This property is ideal for first-time buyers or those looking to downsize.

Key Features:-

Reception Hallway: Welcoming entrance leading to the main living areas.

Open-Plan Lounge, Dining, and Kitchen: Spacious and versatile, perfect for modern living and entertaining.

Modern Kitchen: Stylish and functional with ample wall and base units, complementary worktops, a ceramic hob, and an electric oven.

Two Double Bedrooms: Both bedrooms are located on the upper level and feature built-in wardrobes for ample storage.

Shower Room: Finished to a good standard, completing the accommodation.

Rear Garden: Enclosed landscaped garden with a mixture of mature plants, flowers and shrubs

Front Garden: Landscaped garden with a mixture of mature plants, flowers and shrubs

The property benefits from Double Glazing and Electric Heating.

This charming home offers a comfortable and convenient lifestyle in a peaceful setting. Don't miss the opportunity to make it your own!

Local Area

The popular West Lothian village of Blackburn is situated 2 miles from Bathgate and 5 miles from Livingston. Close to local amenities it has a variety of sports and leisure opportunities. Bathgate has a good range of independent shops, some major retailers and services. Livingston Town Centre offers excellent supermarkets, retail shopping, transport and recreational facilities. For the commuter a regular bus services links to Bathgate and Livingston. Bathgate rail station is a 5-minute drive away which links east to Edinburgh, west to Glasgow and similarly the M8 motorway affords good links to all major parts central Scotland.

Lounge 14'4" x 10'5" (4.38 x 3.18)

Kitchen Diner 13'5" x 9'5" (4.1 x 2.88)

Bedroom 1 10'7" x 10'5" (3.24 x 3.18)

Bedroom 2 9'9" x 7'9" (2.98 x 2.38)

Shower Room 8'0" x 5'6" (2.46 x 1.68)

Contact Us

To arrange a viewing or for further details please call 01501 733200 or email property@sneddons.com.

Area Map



Floor Plans

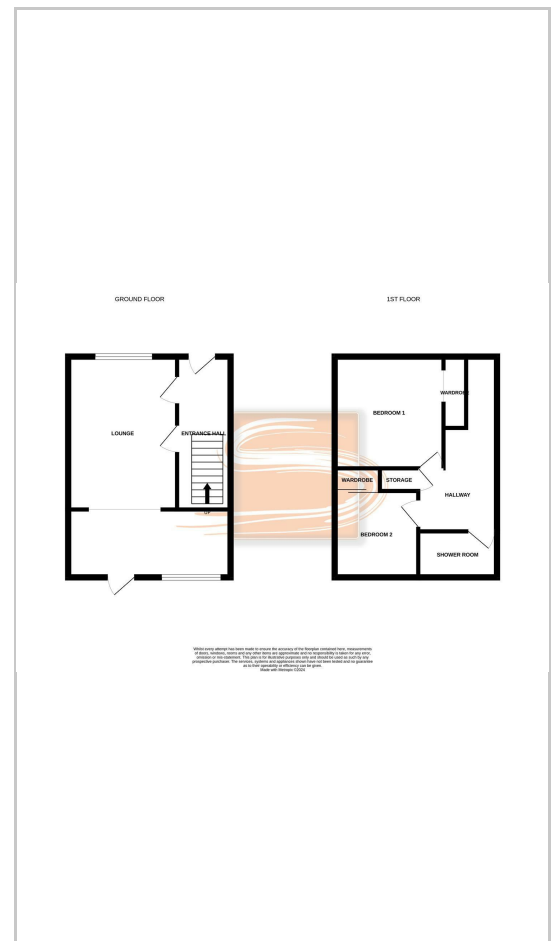

Energy Efficiency Graph

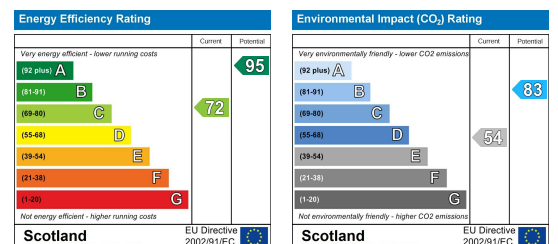

These particulars, whilst believed to be accurate are set out as a general outline only for guidance and do not constitute any part of an offer or contract. Intending purchasers should not rely on them as statements of representation of fact, but must satisfy themselves by inspection or otherwise as to their accuracy. No person in this firm's employment has the authority to make or give any representation or warranty in respect of the property.

47/49 West Main Street, Armadale, West Lothian, EH48 3PZ

Tel: 01501 733200 Email: property@sneddons.com www.sneddons.com