



Connells

Stable Cottage Up Street
Dummer Basingstoke

Stable Cottage Up Street Dummer Basingstoke RG25 2AG

for sale
£375,000



Property Description

Offered to the market with no onward chain is this semi detached, two bedroom, Grade II listed cottage in the sought after village location of Dummer. This quaint cottage is perfect for those looking to escape the hustle and bustle of city life and relax in the quiet of the countryside.

The ground floor comprises of a living room with an open fire place, dining room, kitchen and bathroom, with exposed beams. As you move upstairs you will find the property boasts two bedrooms and a large storeroom.

The exterior of the property offers a side garden which flows through to the rear garden that also includes two large outhouse storage rooms.

Lounge

13' 8" x 11' 9" (4.17m x 3.58m)

Single glazed window to front, open fire

Dining Room

9' 9" into recess x 8' 9" (2.97m into recess x 2.67m)

Single glazed window to rear, cupboard housing boiler, understairs storage cupboard, fire blanket

Kitchen

8' 8" x 9' 10" (2.64m x 3.00m)

Single glazed window to rear, single bowl with mixer tap and drainer, roll top work surface, built in storage, built in oven and hob, space for under counter fridge and freezer, cupboards under and over

Cloakroom

Single glazed window to side, low level wc

Bathroom

Single glazed window to side, heated towel rail, vanity wash hand basin, paneled bath with shower over

Bedroom One

9' 5" x 12' 3" (2.87m x 3.73m)
Single glazed window to side, airing cupboard

Bedroom Two

8' 11" max x 7' 11" max (2.72m max x 2.41m max)
Single glazed window to front, built in cupboard

Store

9' x 6' 9" (2.74m x 2.06m)
Single glazed window to rear, restricted head height

Outside

Wood Store

5' 1" x 3' 4" (1.55m x 1.02m)
Outbuilding 1

17' 5" x 10' 9" (5.31m x 3.28m)
Window to side, Door to side

Outbuilding 2

11' 2" x 17' 3" (3.40m x 5.26m)
Windows to side, door to side

Rear Garden

Shed, mostly laid to lawn







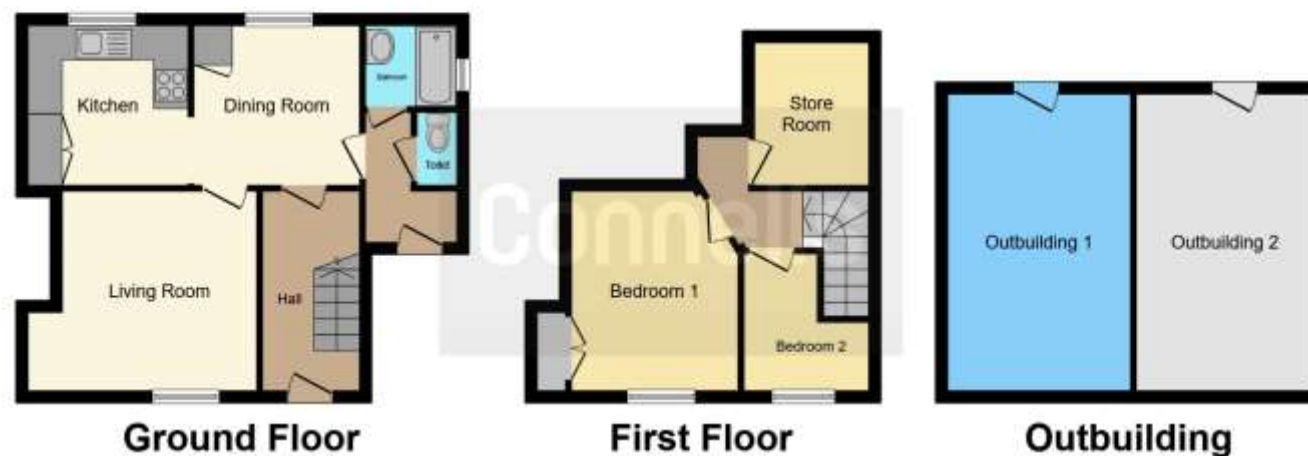

This floor plan is for illustrative purposes only. It is not drawn to scale. Any measurements, floor areas (including any total floor area), openings and orientation are approximate. No details are guaranteed, they cannot be relied upon for any purpose and they do not form part of any agreement. No liability is taken for any error, omission or misstatement. A party must rely upon its own inspection(s). Powered by www.focalagent.com

To view this property please contact Connells on

T 01256 398237
E basingstokesouth@connells.co.uk

56 Broadmere Road Beggarwood
 BASINGSTOKE RG22 4AQ

EPC Rating: E

Tenure: Freehold

view this property online connells.co.uk/Property/KSH105339



1. MONEY LAUNDERING REGULATIONS Intending purchasers will be asked to produce identification documentation at a later stage and we would ask for your co-operation in order that there will be no delay in agreeing the sale. 2. These particulars do not constitute part or all of an offer or contract. 3. The measurements indicated are supplied for guidance only and as such must be considered incorrect. Potential buyers are advised to recheck measurements before committing to any expense. 4. We have not tested any apparatus, equipment, fixtures, fittings or services and it is in the buyers interest to check the working condition of any appliances.

Connells Residential is registered in England and Wales under company number 1489613, Registered Office is Cumbria House, 16-20 Hockliffe Street, Leighton Buzzard, Bedfordshire, LU7 1GN. VAT Registration Number is 500 2481 05.

See all our properties at www.connells.co.uk | www.rightmove.co.uk | www.zoopla.co.uk

Property Ref: KSH105339 - 0006