



Flat

12, THE HYDE, HENDON, NW9 6GD

Per Month
£2,200

Available: 9th May 2025

FEATURES

- Two double bedroom
- Close to transport links
- Bicycle storage
- Modern
- Communal roof terrace
- Newly Refurbished



Huddletons

2 Bedroom Flat located in London

This fantastic two-bedroom apartment is situated in Holocene Court, a modern, custom-built development in Hendon, NW9. It features an eco-friendly design with a spacious open-plan layout and a sleek, contemporary kitchen.

Conveniently located, the property is close to the shops and services along Edgware Road, with frequent bus routes into Central London and Brent Cross. Additionally, the peaceful outdoor areas and picturesque views of Welsh Harp are just a short distance away.

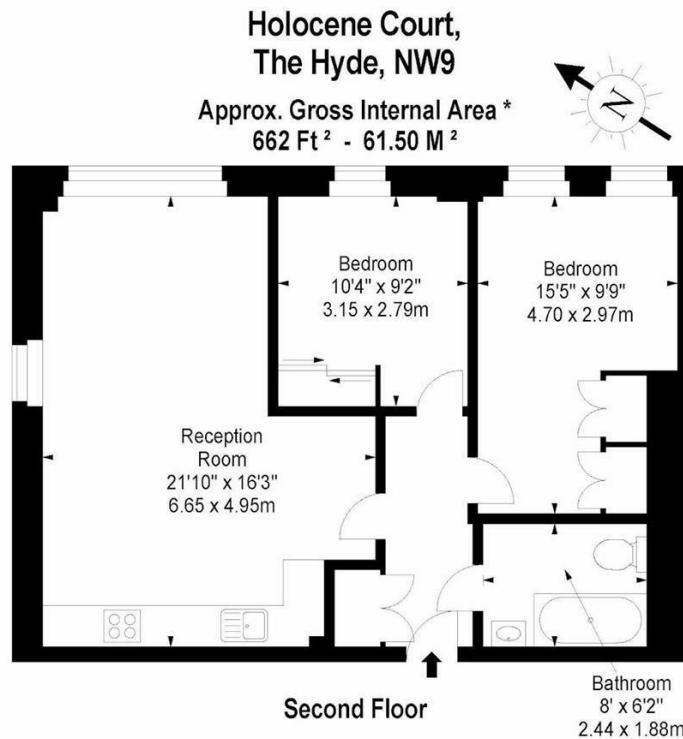

Every attempt has been made to ensure the accuracy of this floor plan however, measurements are approximate and for illustration purposes only. Measured in accordance with the RICS code of measuring practice. Not to scale

Call us on

0207 205 4411

info@huddletons.com

<http://www.huddletons.com>

Council Tax Band

B

Energy Efficiency Rating		
	Current	Potential
Very energy efficient - lower running costs		
(92 plus) A		
(81-91) B	82	82
(69-80) C		
(55-68) D		
(39-54) E		
(21-38) F		
(1-20) G		
Not energy efficient - higher running costs		
England & Wales	EU Directive 2002/91/EC	

Agents Note: Whilst every care has been taken to prepare these particulars, they are for guidance purposes only. All measurements are approximate and are for general guidance purposes only and whilst every care has been taken to ensure their accuracy, they should not be relied upon and potential buyers are advised to recheck the measurements.

Huddletons