



Flat

**5, 19 CRESCENT
ROAD, N8 8AL**

Per Month
£2,700

Available: 18th June 2025

FEATURES



Huddletons

2 Bedroom Flat located in London

Call us on
0207 205 4411
info@huddletons.com
<http://www.huddletons.com>

A fantastic two double bedroom flat of a lovely period building moments from Crouch End Broadway.

Property comprises of three double bedrooms, two bathrooms (one ensuite), open plan living room with large windows that allow natural light to flood the space, separate kitchen and wrap around terrace with large communal garden.

Ample storage space with two additional cupboards. The property comes fully furnished with beds, wardrobes etc.

Council Tax Band

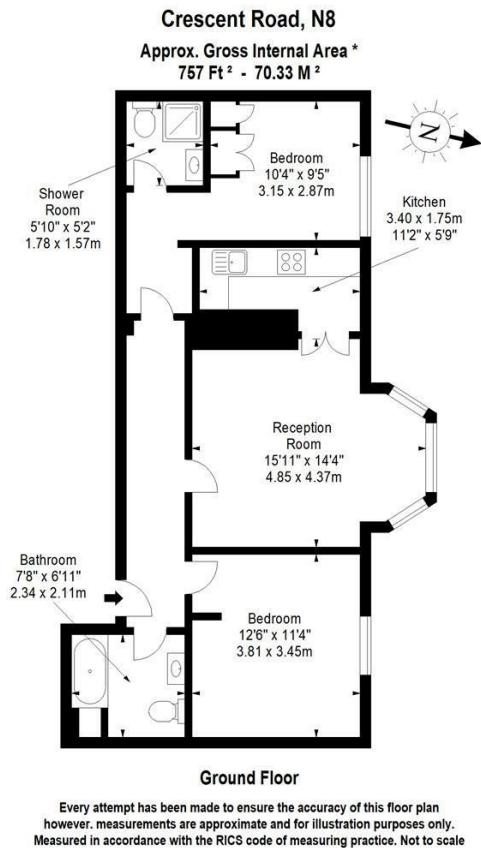

Energy Efficiency Rating		
	Current	Potential
Very energy efficient - lower running costs		
(92 plus) A		
(81-91) B		
(69-80) C		
(55-68) D		
(39-54) E		
(21-38) F		
(1-20) G		
Not energy efficient - higher running costs		
England & Wales		EU Directive 2002/91/EC

Agents Note: Whilst every care has been taken to prepare these particulars, they are for guidance purposes only. All measurements are approximate and are for general guidance purposes only and whilst every care has been taken to ensure their accuracy, they should not be relied upon and potential buyers are advised to recheck the measurements.

Huddletons