



Flat

**56, OAKLEY SQUARE,  
NW1 1NJ**

PCM  
**£1,850**

Available: 30th June 2025

### FEATURES

- One Double Bedroom
- Open Plan Kitchen and Living Room
- Top Floor Flat
- 2 Minute Walk from Mornington Crescent Tube
- Built-in Wardrobes with Ample Storage Space
- Views Overlooking Green Space of Oakley Square
- Flooded with Natural Light
- Fantastic Local Amenities & Transport Links



**Huddletons**

# 1 Bedroom Flat located in London

Huddletons are pleased to offer this beautifully presented 1 Bedroom top floor flat located within a short walk of Regents Park, Primrose Hill and Camden Town. Set on the top floor of this period building overlooking the green space of Oakley Square.

Call us on  
**0207 205 4411**  
[info@huddletons.com](mailto:info@huddletons.com)  
<http://www.huddletons.com>

**Council Tax Band**

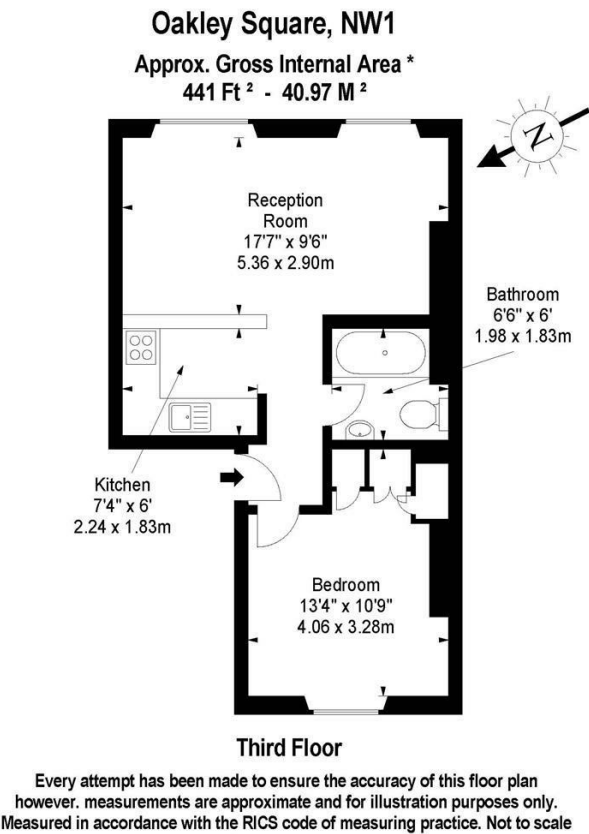

Energy Efficiency Rating		
	Current	Potential
Very energy efficient - lower running costs		
(92 plus) <b>A</b>		
(81-91) <b>B</b>		
(69-80) <b>C</b>		
(55-68) <b>D</b>		
(39-54) <b>E</b>		
(21-38) <b>F</b>		
(1-20) <b>G</b>		
Not energy efficient - higher running costs		
<b>England &amp; Wales</b>		EU Directive 2002/91/EC

Agents Note: Whilst every care has been taken to prepare these particulars, they are for guidance purposes only. All measurements are approximate and are for general guidance purposes only and whilst every care has been taken to ensure their accuracy, they should not be relied upon and potential buyers are advised to recheck the measurements.

# Huddletons