



Apartment

**23, NEWMAN STREET,  
W1T 1PN**

Per Calendar  
**£3,000**

Available: 20th August 2024

### FEATURES

- Luxury One Bedroom Apartment
- Stylish Kitchen and Bathroom Suites
- Extensive Private Decked Terrace
- Manhattan Style
- Excellent Transport Links
- Fantastic Local Amenities



**Huddletons**

# 1 Bedroom Apartment located in London

Luxury one bedroom Manhattan style apartment with an extensive private decked terrace. This beautiful apartment features stylish kitchen and bathroom suites along with comfort cooling. Located moments from Soho and Tottenham Court Road.

Call us on

0207 205 4411

[info@huddletons.com](mailto:info@huddletons.com)

<http://www.huddletons.com>

Council Tax Band

Newman Street, London

£585 PW

West One, W1T  
Approx. Gross Internal Area  
424 Sq Ft - 39.39 Sq M.

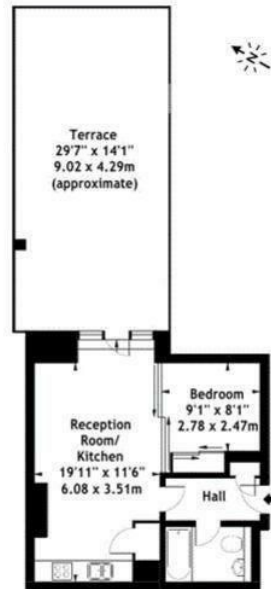

First Floor

Energy Efficiency Rating		Current	Potential
<i>Very energy efficient - lower running costs</i>			
(92 plus) A			
(81-91) B			
(69-80) C			
(55-68) D			
(39-54) E			
(21-38) F			
(1-20) G			
<i>Not energy efficient - higher running costs</i>			
<b>England &amp; Wales</b>		EU Directive 2002/91/EC	

Agents Note: Whilst every care has been taken to prepare these particulars, they are for guidance purposes only. All measurements are approximate and are for general guidance purposes only and whilst every care has been taken to ensure their accuracy, they should not be relied upon and potential buyers are advised to recheck the measurements.

# Huddletons