



CLIVEPEARCE
Now you're moving

3 Bedrooms

Bungalow

Asking Price

£395,000

Located in

Truro



www.clivepearceproperty.com



Gloweth View

Truro | Cornwall | TR1 3JZ

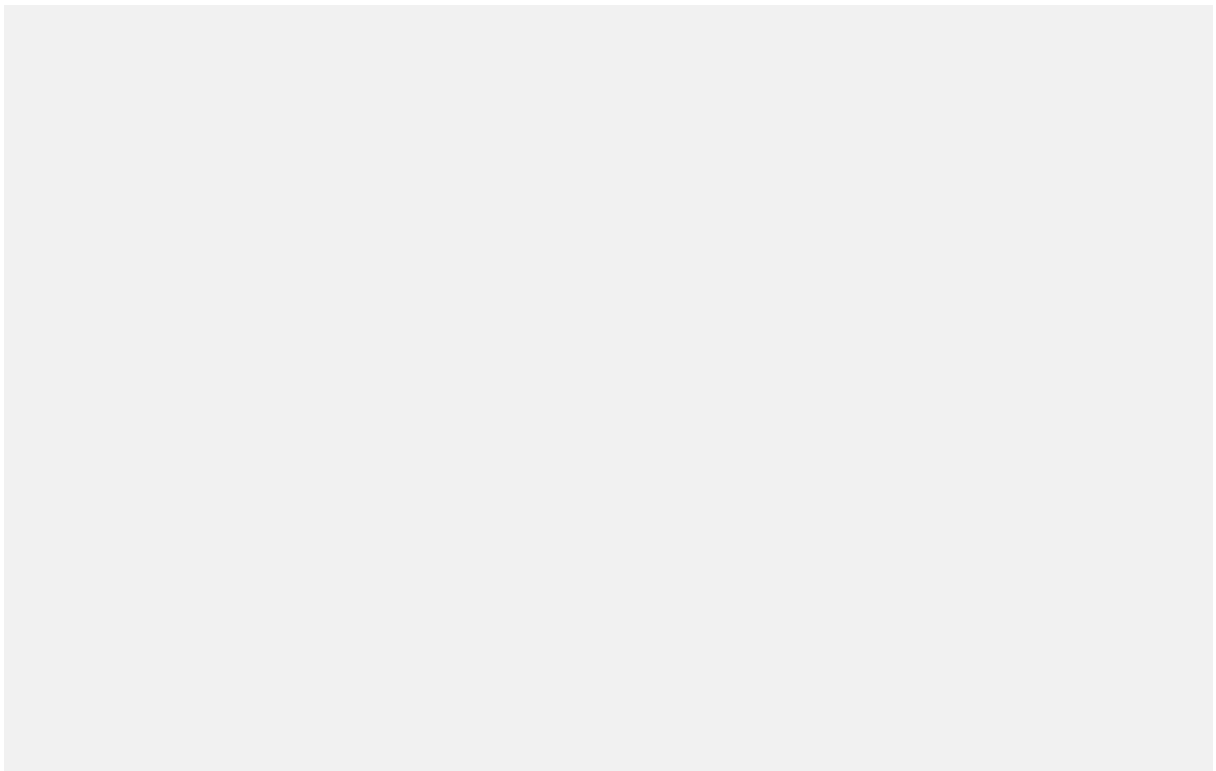

Gloweth View

£395,000 Freehold



- Three bedroom detached bungalow
- Stylish fitted kitchen with integrated appliances
- Conservatory with views
- Excellent location - close to hospital and college
- Brick paved driveway with ample parking
- Main bedroom en-suite
- Established rear garden

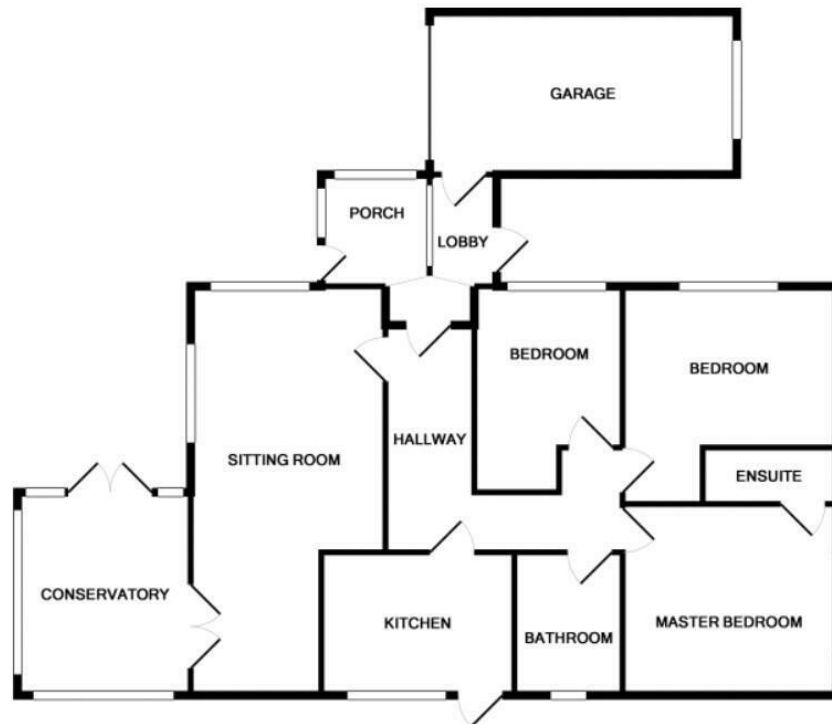

Council Tax Band D

Local Authority

Agents Note: Whilst every care has been taken to prepare these particulars, they are for guidance purposes only. All measurements are approximate and are for general guidance purposes only and whilst every care has been taken to ensure their accuracy, they should not be relied upon and potential buyers/tenants are advised to recheck the measurements.

Energy Efficiency Rating		
	Current	Potential
Very energy efficient - lower running costs		
(92 plus) A		
(81-91) B		84
(69-80) C		
(55-68) D	65	
(39-54) E		
(21-38) F		
(1-20) G		
Not energy efficient - higher running costs		
England & Wales		EU Directive 2002/91/EC

31 Lemon Street
Truro
Cornwall
TR3 7QB



CLIVEPEARCE
Now you're moving

hello@clivepearceproperty.com

01872 272622

www.clivepearceproperty.com