



CLIVEPEARCE
Now you're moving

2 Bedrooms

Maisonette

Asking Price

£187,500

Located in

Truro



www.clivepearceproperty.com



The Square

Truro | Cornwall | TR3 7AY



A stylish and spacious two double bedroom maisonette apartment with updated kitchen. Parking and communal garden. Excellent location.

The Square

£187,500 Share of Freehold



- Attractive maisonette apartment
- Updated fitted kitchen
- Lovely location
- Communal garden
- Electric heating
- Two bedrooms
- Open plan living
- Parking
- Central village location

GROUND FLOOR
390 sq.ft. (36.2 sq.m.) approx.

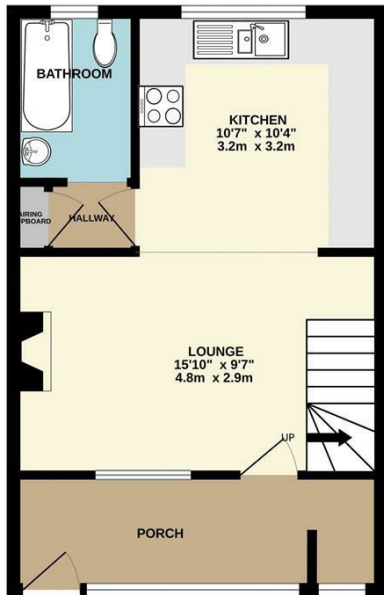

1ST FLOOR
306 sq.ft. (28.4 sq.m.) approx.

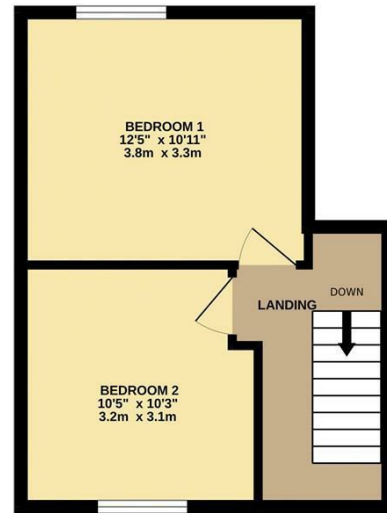

TOTAL FLOOR AREA : 696 sq.ft. (64.6 sq.m.) approx.
Whilst every attempt has been made to ensure the accuracy of the floorplan contained here, measurements of doors, windows, rooms and any other items are approximate and no responsibility is taken for any error, omission or mis-statement. This plan is for illustrative purposes only and should be used as such by any prospective purchaser. The services, systems and appliances shown have not been tested and no guarantee as to their operability or efficiency can be given.
Made with Metropia, ©2025

Council Tax Band A

Local Authority

Agents Note: Whilst every care has been taken to prepare these particulars, they are for guidance purposes only. All measurements are approximate and are for general guidance purposes only and whilst every care has been taken to ensure their accuracy, they should not be relied upon and potential buyers/tenants are advised to recheck the measurements.

Energy Efficiency Rating		
	Current	Potential
Very energy efficient - lower running costs		
(92 plus) A		
(81-91) B		
(69-80) C		
(55-68) D		
(39-54) E		
(21-38) F		
(1-20) G		
Not energy efficient - higher running costs		
England & Wales	EU Directive 2002/91/EC	

31 Lemon Street
Truro
Cornwall
TR3 7QB



CLIVEPEARCE
Now you're moving

hello@clivepearceproperty.com

01872 272622

www.clivepearceproperty.com