



4 Lower Rosewin Row, Truro

£199,950



CLIVEPEARCE

01872 272622 | hello@clivepearceproperty.com



£199,950

One of Truro's hidden treasures! Acity cottage located on a traffic free terrace within a couple of minutes walk of the centre. Delightful garden, two bedrooms, bathroom, living room, dining room and kitchen.

Property Description

Why You'll Like It

A truly delightful city cottage which is tucked away on a pretty terrace and with a few moments stroll of the city centre. Stepping inside the property, a vestibule opens through to the living space and you'll immediately be aware of the lovely high ceilings. A window over looks the front garden and has a view of the cathedral spires and the fireplace provides a focal point. The dining area is open plan to the lounge and just off it is a kitchen which has pine front cabinets and workspace. Upstairs you'll find two good sized bedrooms and a bathroom with a white suite. Electric heating is installed. The garden to the front of the property is most attractive and has a usefully brick outbuilding.

Where It Is

One of Truro's most prized southerly facing terraces of character cottages with exceptional views having the beauty of Truro Cathedral as the focal point. Located in a conservation area, a short distance up hill from the city centre on the Northern side of Truro, this location is very convenient for those wishing to walk into the town. There is a very well managed and highly regarded pub, The Rising Sun a short distance away and the favoured Archbishop Benson Primary School is also in this part of the city.

Services and Tenure

Freehold Council Tax Band B Mains electric, water and drains.

Important Information

Clive Pearce Property, their clients and any joint agents give notice that: 1. They are not authorised to make or give any representations or warranties in relation to the property either here or elsewhere, either on their own behalf or on behalf of their client or otherwise. They assume no responsibility for any statement that may be made in these particulars. These particulars do not form part of any offer or contract and must not be relied upon as statements of fact. 2 It should not be assumed that the property has all necessary planning, building regulation or other consents and Clive Pearce Property have not tested any services, equipment or facilities. Purchasers must satisfy themselves by inspection or otherwise. 3. Photos and Videos: The photographs and/or videos show only certain parts of the property as they appeared at the time they were taken. Areas, measurements and distances given are approximate only. Any computer generated image gives only an indication as to how the property may look and this may change at any time. Any reference to alterations to, or use of, any part of the property does not mean that any necessary planning, building regulations or other consent has been obtained. A buyer must find out by inspection or in other ways that these matters have been properly dealt with and that all information is correct. Information on the website about a property is liable to be changed at any time.

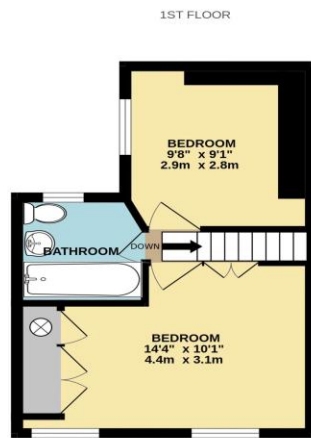
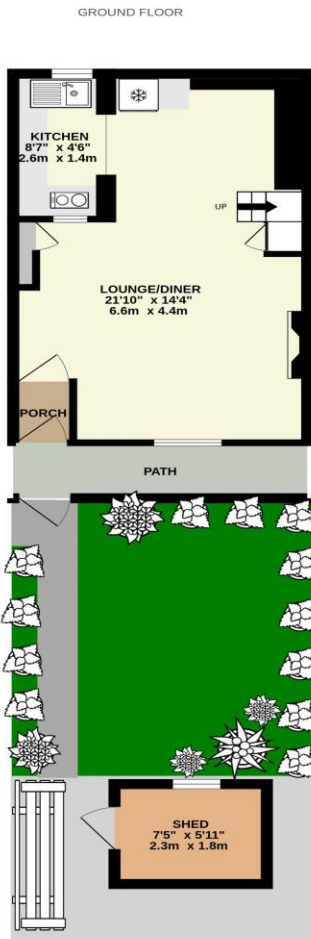

4 LOWER ROSEWIN ROW, TRURO, TR1 1EN

Whilst every attempt has been made to ensure the accuracy of the floorplan contained here, measurements of doors, windows, rooms and any other items are approximate and no responsibility is taken for any error, omission or mis-statement. This plan is for illustrative purposes only and should be used as such by any prospective purchaser. The services, systems and appliances shown have not been tested and no guarantee as to their operability or efficiency can be given.
Made with Metropix ©2023

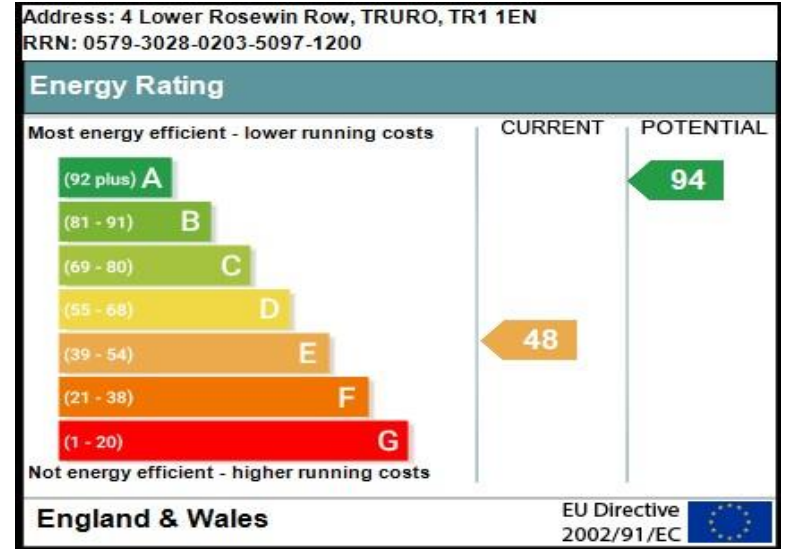

These details are for guidance only and complete accuracy cannot be guaranteed. If there is at any point, which is of particular importance, verification should be obtained. They do not constitute a contract or part of a contract. All measurements are approximate. No guarantee can be given with regard to planning permissions or fitness for purpose. No apparatus, equipment, fixture or fitting has been tested. Items shown in photographs are NOT necessarily included. Interested Parties are advised to check availability and make an appointment to view before travelling to see a property.

31 Lemon Street Truro Cornwall TR1 2LS
01872 272622 | hello@clivepearceproperty.com



CLIVEPEARCE