

HUNTERS[®]

HERE TO GET *you* THERE



Hulse Lodge

Southampton, SO15 2LA

£795 Per Calendar Month



One bedroom flat offered unfurnished enjoying a highly convenient position for Bedford Place, Southampton City Centre and Southampton Common. Situated in Banister Park, the property comprises entrance hall, kitchen, lounge, bedroom and bathroom. Benefits include secure block entry, double glazing, balcony, communal gardens and bike storage. Southampton City Centre and Train Station are 15 minutes walk from the property.

Council Tax Band A
EPC C



Area Map



Floor Plans

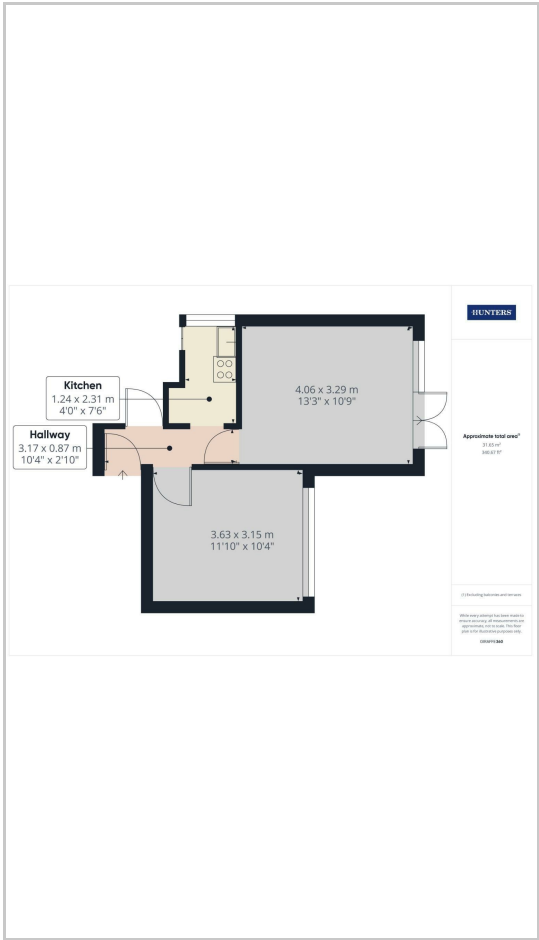

Energy Efficiency Graph

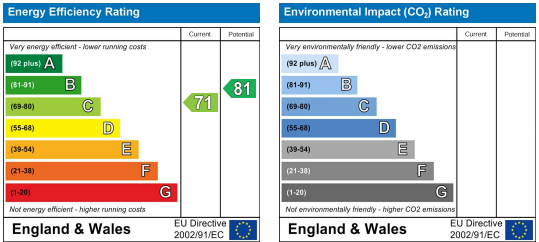

These particulars are intended to give a fair and reliable description of the property but no responsibility for any inaccuracy or error can be accepted and do not constitute an offer or contract. We have not tested any services or appliances (including central heating if fitted) referred to in these particulars and the purchasers are advised to satisfy themselves as to the working order and condition. If a property is unoccupied at any time there may be reconnection charges for any switched off/disconnected or drained services or appliances - All measurements are approximate.

THINKING OF SELLING? If you are thinking of selling your home or just curious to discover the value of your property, Hunters would be pleased to provide free, no obligation sales and marketing advice. Even if your home is outside the area covered by our local offices we can arrange a Market Appraisal through our national network of Hunters estate agents.