



Price £340,000

Teesdale , Far Westrip, Stroud, GL6 6HE

- THREE BEDROOMS
- STUNNING VIEWS
- ELEVATED POSITION
- GARAGE AND PARKING
- GENEROUS GARDEN
- VIEWING ESSENTIAL

17 KESTREL COURT, WATERWELLS DRIVE, QUEDGELEY GL2 2AT

E: info@glos-property.co.uk | GLOUCESTER: 01452 835736 | CHELTENHAM: 01242 644202 | STROUD: 01453 383004



Situated in an elevated position, this fabulous detached home enjoys far reaching views across the Stroud valley. The internal accommodation comprises, Entrance Hall, open plan Living/Dining Room with cast iron log burning stove, fitted kitchen, three bedrooms and a family bathroom. The property also benefits from double glazing throughout.

Outside the property benefits from an integral single garage (15'8" x 12'5") with up and over door, power and light, gas, water meter and Worcester combination gas fired boiler. There is additional parking for two vehicles in front of the garage. Steps lead to the front of the bungalow with a large entertaining patio which enjoys extensive views over the surrounding valley. Side pedestrian access leading to a terraced garden with lawns, well stocked flower borders and vegetable plot. The garden backs onto open fields and enjoys valley views.

Located within a short distance of several well-regarded primary schools including Foxmoor and Randwick C of E, both rated as outstanding by Ofsted, and Cashes Green, we highly advise an early viewing on this fantastic home.



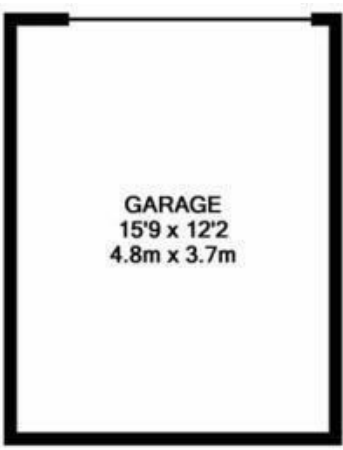

GARAGE
15'9" x 12'2"
4.8m x 3.7m

GARAGE
APPROX. FLOOR
AREA 191 SQ.FT.
(17.8 SQ.M.)

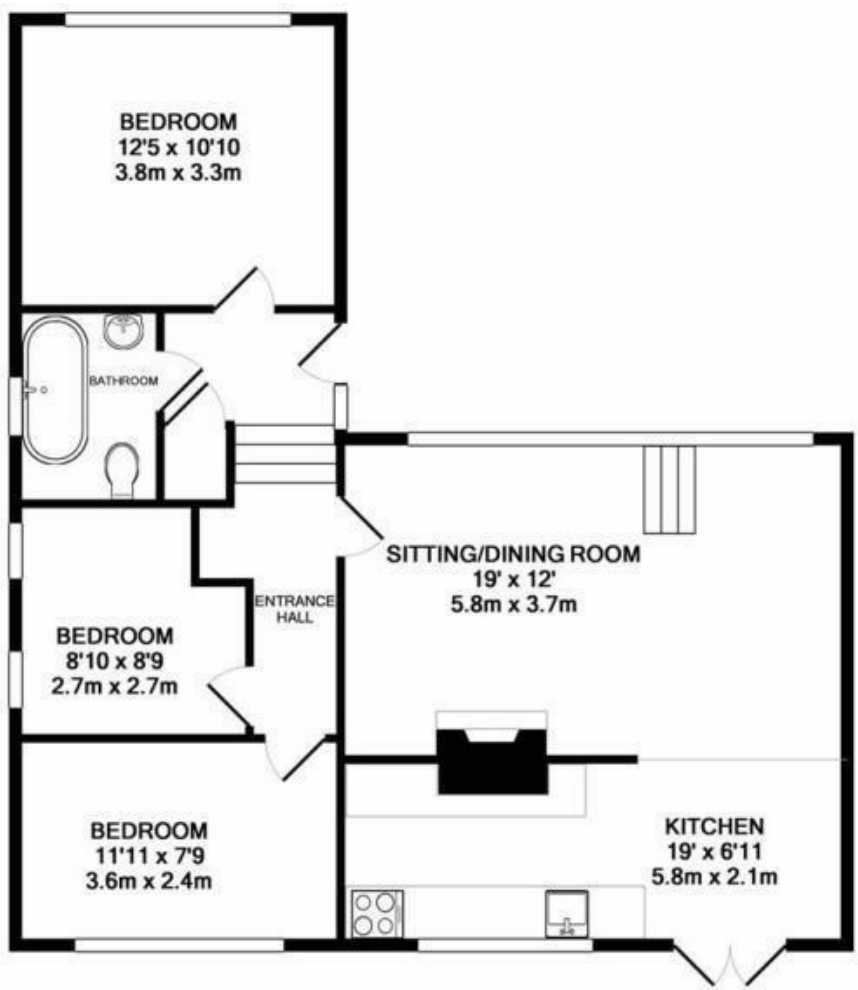

BEDROOM
12'5" x 10'10"
3.8m x 3.3m

BATHROOM

BEDROOM
8'10" x 8'9"
2.7m x 2.7m

BEDROOM
11'11" x 7'9"
3.6m x 2.4m

ENTRANCE HALL

SITTING/DINING ROOM
19' x 12'
5.8m x 3.7m

KITCHEN
19' x 6'11"
5.8m x 2.1m

GROUND FLOOR
APPROX. FLOOR
AREA 776 SQ.FT.
(72.1 SQ.M.)
TEESDALE, FAR WESTRIP, STROUD, GL6 6HE
TOTAL APPROX. FLOOR AREA 968 SQ.FT. (89.9 SQ.M.)
Made with Metropix ©2017



Entrance

Via door into entrance hall.

Living room/Dining room

19' x 12'

Kitchen

19' x 6'11

Bedroom one

12'5 x 10'10

Bedroom two

11'11 x 7'9

Bedroom three

8'10 x 8'9

Bathroom

Outside

Rear garden mostly laid to lawn

