



See More Online

# KFB: Key Facts For Buyers

A Guide to This Property & the Local Area

**Thursday 27<sup>th</sup> November 2025**

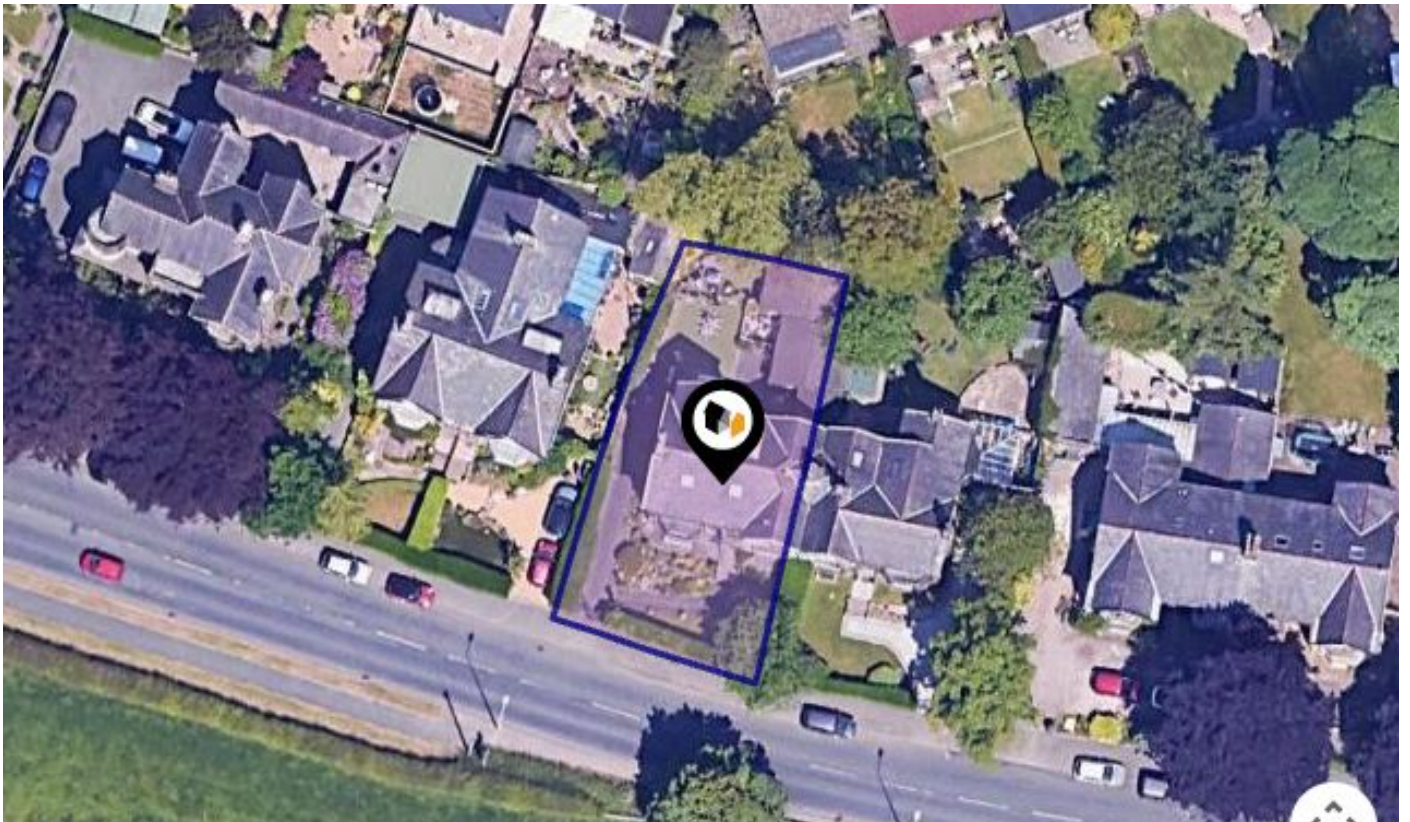

**WHALLEY ROAD, PADIHAM, BURNLEY, BB12**

## Pendle Hill Properties

154 Whalley Road Read BB12 7PN

01282 772048

india@pendlehillproperties.co.uk

www.pendlehillproperties.co.uk



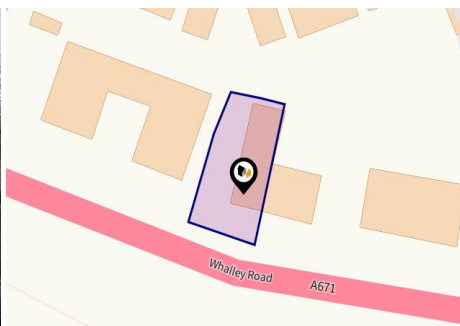

## Property

<b>Type:</b>	Semi-Detached	<b>Tenure:</b>	Leasehold
<b>Bedrooms:</b>	9	<b>Start Date:</b>	25/07/1907
<b>Floor Area:</b>	3,930 ft <sup>2</sup> / 365 m <sup>2</sup>	<b>End Date:</b>	01/05/2902
<b>Plot Area:</b>	0.13 acres	<b>Lease Term:</b>	999 years (less 10 days) from 1 May 1903
<b>Year Built :</b>	1900-1929	<b>Term Remaining:</b>	877 years
<b>Council Tax :</b>	Band E		
<b>Annual Estimate:</b>	£3,002		
<b>Title Number:</b>	LA397053		

## Local Area

<b>Local Authority:</b>	Lancashire
<b>Conservation Area:</b>	No
<b>Flood Risk:</b>	
• Rivers & Seas	Very low
• Surface Water	Very low

### Estimated Broadband Speeds (Standard - Superfast - Ultrafast)

<b>15</b> mb/s	<b>50</b> mb/s	<b>2000</b> mb/s

### Mobile Coverage: (based on calls indoors)



### Satellite/Fibre TV Availability:



There have been multiple title plans detected at this address. Here, we have compiled the available information about these plans and - where applicable for leasehold plans - the term lengths related to them.

## Freehold Title Plan

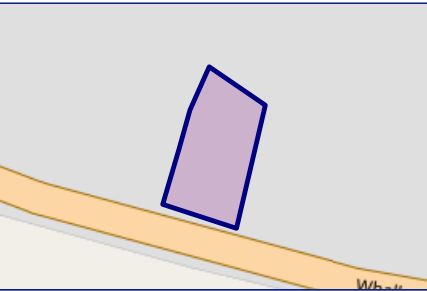

**LAN117252**

## Leasehold Title Plan

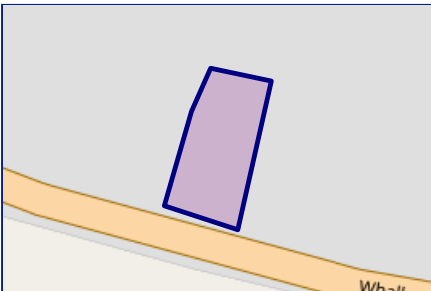

**LA397053**

Start Date: 04/02/1904  
End Date: 01/11/2900  
Lease Term: 999 years from 1 November 1901  
Term 875 years  
Remaining:

Start Date: 25/07/1907  
End Date: 01/05/2902  
Lease Term: 999 years (less 10 days) from 1 May 1903  
Term 877 years  
Remaining:





**WHALLEY ROAD, PADIHAM, BURNLEY, BB12**

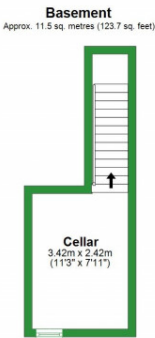

Total area: approx. 365.2 sq. metres (3931.4 sq. feet)

**WHALLEY ROAD, PADIHAM, BURNLEY, BB12**

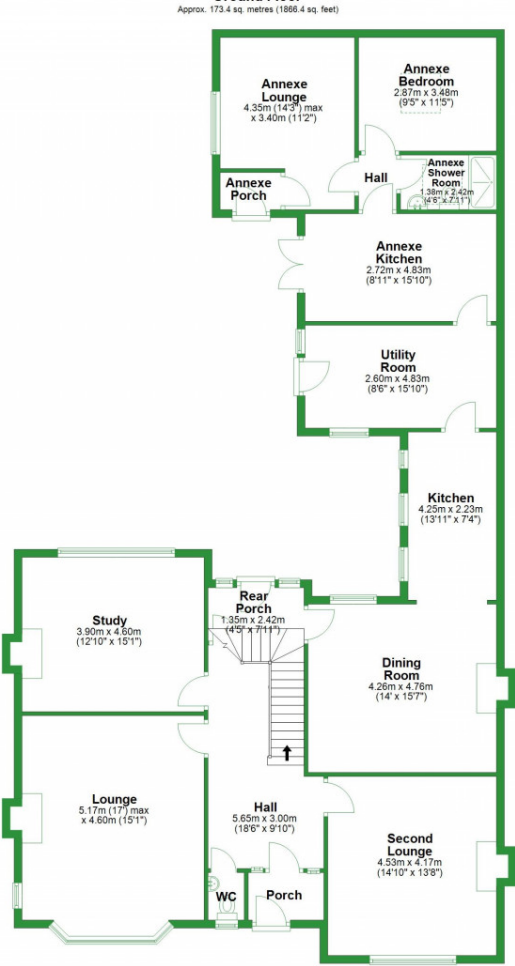

**WHALLEY ROAD, PADIHAM, BURNLEY, BB12**

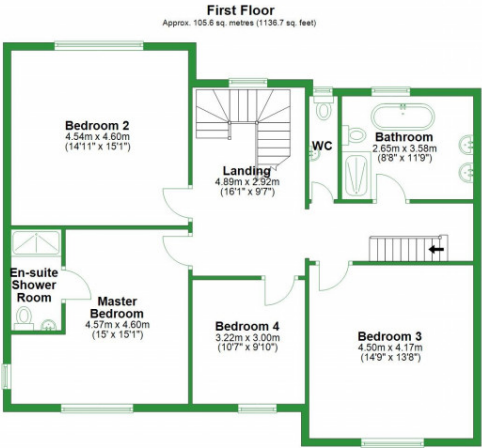

**WHALLEY ROAD, PADIHAM, BURNLEY, BB12**

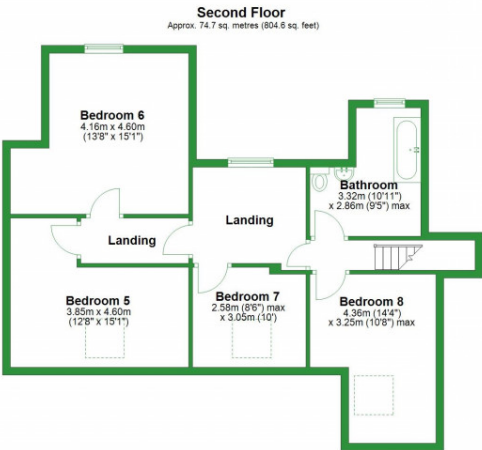



# Market

## House Price Statistics

10 Year History of Average House Prices by Property Type in BB12

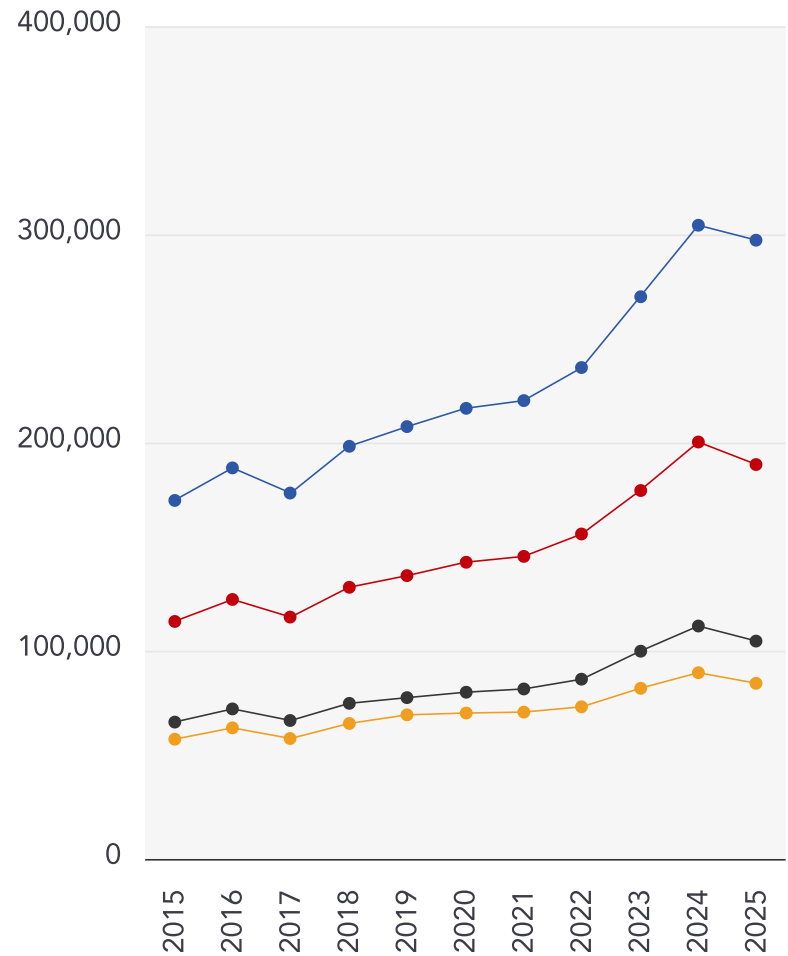

Detached

**+72.58%**

Semi-Detached

**+66.06%**

Terraced

**+59.19%**





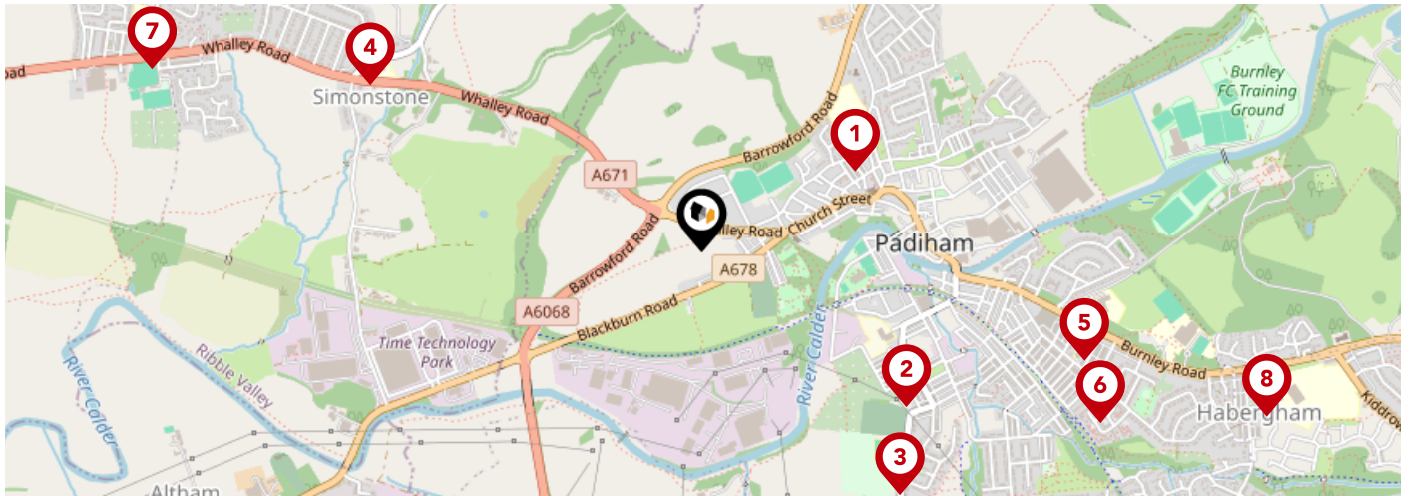

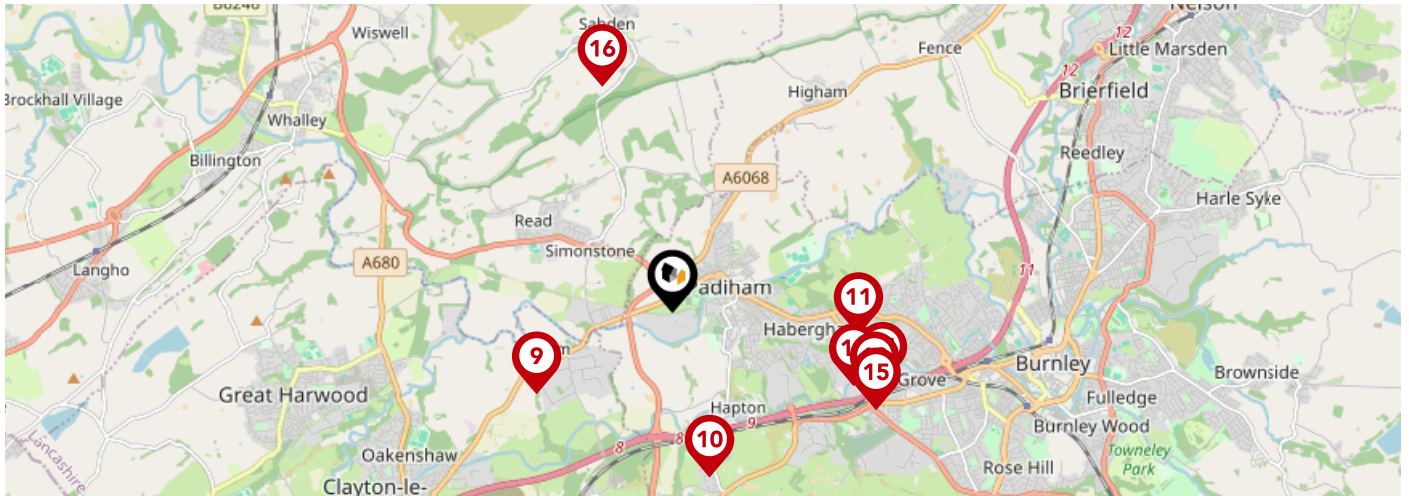

Flat

**+46.72%**



		Nursery	Primary	Secondary	College	Private
<b>1</b>	<b>Padiham St Leonard's Voluntary Aided Church of England Primary School</b> Ofsted Rating: Good   Pupils: 328   Distance:0.38	<input type="checkbox"/>	<input checked="" type="checkbox"/>	<input type="checkbox"/>	<input type="checkbox"/>	<input type="checkbox"/>
<b>2</b>	<b>Padiham Green Church of England Primary School</b> Ofsted Rating: Requires improvement   Pupils: 197   Distance:0.57	<input type="checkbox"/>	<input checked="" type="checkbox"/>	<input type="checkbox"/>	<input type="checkbox"/>	<input type="checkbox"/>
<b>3</b>	<b>St John the Baptist Roman Catholic Primary School, Padiham</b> Ofsted Rating: Good   Pupils: 226   Distance:0.69	<input type="checkbox"/>	<input checked="" type="checkbox"/>	<input type="checkbox"/>	<input type="checkbox"/>	<input type="checkbox"/>
<b>4</b>	<b>Simonstone St Peter's Church of England Primary School</b> Ofsted Rating: Good   Pupils: 133   Distance:0.81	<input type="checkbox"/>	<input checked="" type="checkbox"/>	<input type="checkbox"/>	<input type="checkbox"/>	<input type="checkbox"/>
<b>5</b>	<b>Padiham Primary School</b> Ofsted Rating: Good   Pupils: 289   Distance:0.87	<input type="checkbox"/>	<input checked="" type="checkbox"/>	<input type="checkbox"/>	<input type="checkbox"/>	<input type="checkbox"/>
<b>6</b>	<b>Whitegate Nursery School</b> Ofsted Rating: Outstanding   Pupils: 118   Distance:0.95	<input checked="" type="checkbox"/>	<input type="checkbox"/>	<input type="checkbox"/>	<input type="checkbox"/>	<input type="checkbox"/>
<b>7</b>	<b>Read St John's CofE Primary School</b> Ofsted Rating: Good   Pupils: 194   Distance:1.27	<input type="checkbox"/>	<input checked="" type="checkbox"/>	<input type="checkbox"/>	<input type="checkbox"/>	<input type="checkbox"/>
<b>8</b>	<b>Burnley High School</b> Ofsted Rating: Good   Pupils: 607   Distance:1.29	<input type="checkbox"/>	<input type="checkbox"/>	<input checked="" type="checkbox"/>	<input type="checkbox"/>	<input type="checkbox"/>



		Nursery	Primary	Secondary	College	Private
	<b>Altham St James Church of England Primary School</b> Ofsted Rating: Good   Pupils: 79   Distance:1.39	<input type="checkbox"/>	<input checked="" type="checkbox"/>	<input type="checkbox"/>	<input type="checkbox"/>	<input type="checkbox"/>
	<b>Hapton Church of England/Methodist Primary School</b> Ofsted Rating: Good   Pupils: 124   Distance:1.48	<input type="checkbox"/>	<input checked="" type="checkbox"/>	<input type="checkbox"/>	<input type="checkbox"/>	<input type="checkbox"/>
	<b>St Joseph's Park Hill School</b> Ofsted Rating: Not Rated   Pupils: 128   Distance:1.65	<input type="checkbox"/>	<input checked="" type="checkbox"/>	<input type="checkbox"/>	<input type="checkbox"/>	<input type="checkbox"/>
	<b>Burnley Lowerhouse Junior School</b> Ofsted Rating: Requires improvement   Pupils: 204   Distance:1.71	<input type="checkbox"/>	<input checked="" type="checkbox"/>	<input type="checkbox"/>	<input type="checkbox"/>	<input type="checkbox"/>
	<b>St Augustine of Canterbury RC Primary School, A Voluntary Academy</b> Ofsted Rating: Good   Pupils: 208   Distance:1.92	<input type="checkbox"/>	<input checked="" type="checkbox"/>	<input type="checkbox"/>	<input type="checkbox"/>	<input type="checkbox"/>
	<b>Rosegrove Nursery School</b> Ofsted Rating: Outstanding   Pupils: 91   Distance:1.95	<input checked="" type="checkbox"/>	<input type="checkbox"/>	<input type="checkbox"/>	<input type="checkbox"/>	<input type="checkbox"/>
	<b>Rosegrove Infant School</b> Ofsted Rating: Good   Pupils: 156   Distance:1.98	<input type="checkbox"/>	<input checked="" type="checkbox"/>	<input type="checkbox"/>	<input type="checkbox"/>	<input type="checkbox"/>
	<b>St Mary's Roman Catholic Primary School, Sabden</b> Ofsted Rating: Good   Pupils: 62   Distance:2.07	<input type="checkbox"/>	<input checked="" type="checkbox"/>	<input type="checkbox"/>	<input type="checkbox"/>	<input type="checkbox"/>

# Area

## Transport (National)

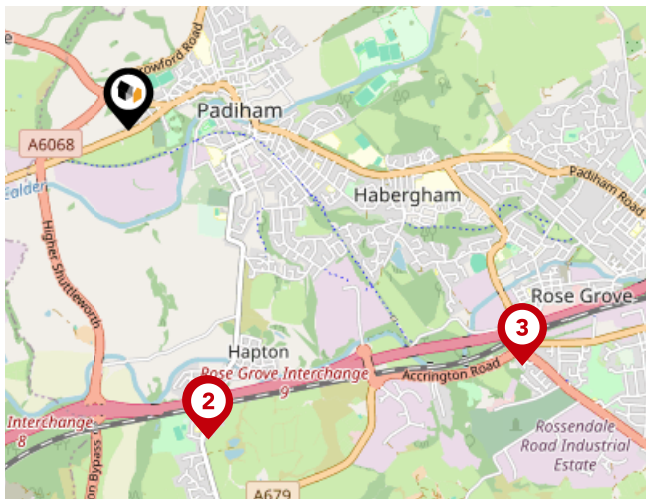

### National Rail Stations

Pin	Name	Distance
1	Hapton Rail Station	1.39 miles
2	Hapton Rail Station	1.4 miles
3	Rose Grove Rail Station	2.02 miles

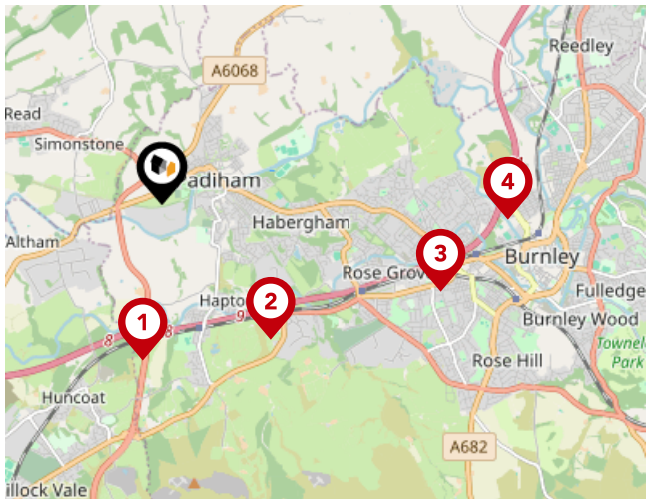

### Trunk Roads/Motorways



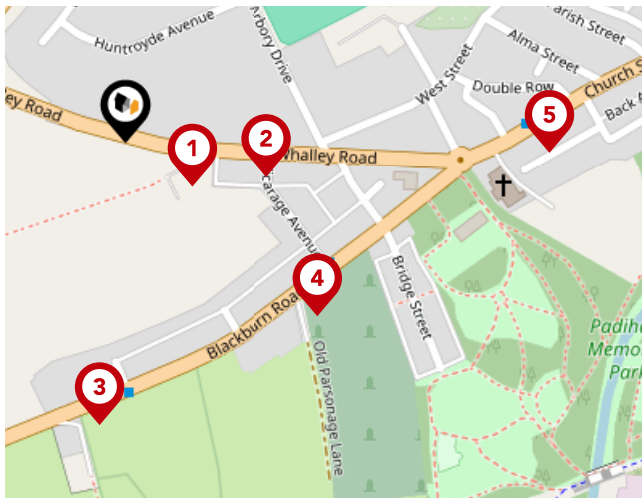

Pin	Name	Distance
1	M65 J8	1.38 miles
2	M65 J9	1.51 miles
3	M65 J10	2.56 miles
4	M65 J11	3.03 miles
5	M65 J7	3.67 miles

# Area

## Transport (Local)



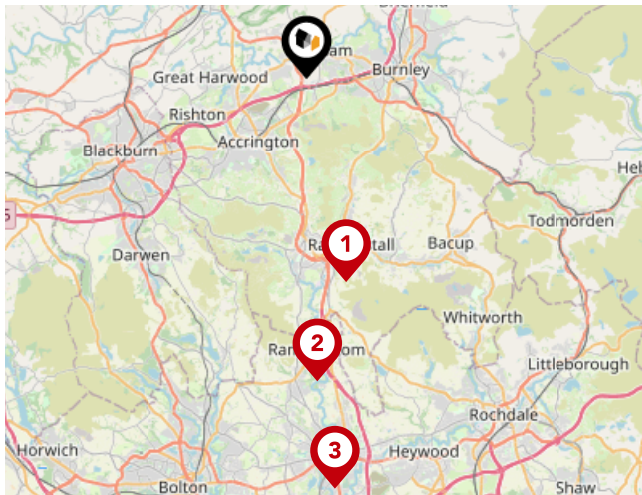

### Bus Stops/Stations

Pin	Name	Distance
	Vicarage Avenue	0.04 miles
	Vicarage Avenue	0.08 miles
	Princess Street	0.16 miles
	Cemetery	0.14 miles
	Memorial Park	0.23 miles



### Local Connections

Pin	Name	Distance
	Rawtenstall (East Lancashire Railway)	7.23 miles
	Ramsbottom (East Lancashire Railway)	10.61 miles
	Bury Bolton Street (East Lancashire Railway)	14.39 miles





### **Pendle Hill Properties**

---

If you are looking for exceptional service, high level sales skills and a team driven by success look no further than Pendle Hill Properties.

At Pendle Hill Properties we pride ourselves on offering the very best personal service and help buyers, sellers, landlords and tenants alike achieve their aims.

From the very first moment you call us you will feel secure in the knowledge that you are in safe and reliable hands. We take away the stress of property selection and buying and make the whole process simple and painless. Not only that but we have access to a team of partners who can provide legal, mortgage and financial advice, surveys, and provide a range of products tailored to your needs. In short Pendle Hill Properties is your one stop property shop.

### Testimonial 1



A super big Thank you to Andrew and all the team at Pendle Hill Properties for selling my house quickly. The service and communication from this company was second to none. Highly recommended. 5 star review from me.

### Testimonial 2



Moved to Pendle Hill properties after a really poor experience with a previous agent and immediately saw a difference from the photographs and marketing, to the number of viewings. Andrew worked hard to get our sale to completion and was always contactable for any queries. Would recommend.

### Testimonial 3



We used Pendle Properties to both sell our home, and rent our new home. It's a family-run company, and that really comes over in the service. You get that personal touch that is so often missing from high street estate agents. They care about their service. Our property in Cliviger was advertised and sold within 10 weeks, thanks to some great promotion across all platforms. They are strong and creative on social media. All in all, we'd highly recommend!

### Testimonial 4



Hi, So Andrew and Thomas took on a very niche house. They were aligned with the way I wanted to house marketed right from the offset. Always available to contact even out of work hours. Due diligence on buyers made to a high level. A very personal approach to dealing with buyers and vendors. Succeeded in the sale of our house. Recommended their services. Thanks



/PendleHillProperties/



/pendlehillproperties/



/PendleHillProps



/company/pendle-hill-properties/

# Pendle Hill Properties

## Data Quality

We are committed to comprehensive property data being made available upfront to make the home buying and selling process quicker, easier and cheaper. This is why we have partnered with Sprift, the UK's leading supplier of property-specific data.



### **Contains public sector information licensed under the Open Government License v3.0**

The information contained within this report is for general information purposes only.

Sprift Technologies Ltd aggregate this data from a wide variety of sources and while we endeavour to keep the information up to date and correct, we make no representations or warranties of any kind, express or implied, about the completeness, accuracy, reliability, of the information or related graphics contained within this report for any purpose.

Any reliance you place on such information is therefore strictly at your own risk. In no event will we be liable for any loss or damage including without limitation, indirect or consequential loss or damage, or any loss or damage whatsoever arising from loss of data or profits arising out of, or in connection with, the use of this report.



#### **Pendle Hill Properties**

154 Whalley Road Read BB12 7PN

01282 772048

india@pendlehillproperties.co.uk

www.pendlehillproperties.co.uk



Valuation Office  
Agency

