



Hirwaun Road

Hirwaun, Aberdare, CF44 9HP

£189,995



Hirwaun Road in the sought after location of Hirwaun, Aberdare, this spacious dormer semi-detached bungalow presents an exciting opportunity for builders and investors alike. With three bedrooms and a generous layout, this property is ripe for renovation and transformation.

Upon entering, you are greeted by a welcoming entrance hallway that leads to a large lounge, perfect for family gatherings or quiet evenings. The kitchen and dining room provide ample space for culinary adventures, while the additional sitting room offers a versatile area that can be tailored to your needs. The bathroom is conveniently located, and a downstairs bedroom adds to the practicality of the layout. Upstairs, two attic rooms await your creative touch, offering potential for additional living space. The property boasts large front gardens, providing a delightful outdoor space for relaxation or play. An entrance drive at both the front and rear allows for parking for multiple vehicles, ensuring convenience for residents and guests.

Situated in a popular location, this bungalow enjoys good access to road links leading to Swansea and Merthyr Tydfil, making it an ideal base for commuting. With the potential to be sold as two separate family homes or as a single project, this property offers a wealth of possibilities. Whether you are looking to create your dream home or invest in a promising project, this bungalow on Hirwaun Road is a must-see. Embrace the opportunity to breathe new life into this charming residence and make it your own.



Entrance Hall
Radiator.

Bedroom 11'8 x 11'11 (3.56m x 3.63m)
Radiator. Window to front aspect.

Dining Room 11'4 x 11'10 (3.45m x 3.61m)
Radiator. Double doors.

Bathroom 8'8 x 5'3 (2.64m x 1.60m)

Lounge 24'11 x 13'2 (7.59m x 4.01m)
Radiators x 3. Stairs to first floor. Windows to front and side aspect.

kitchen 14'1 x 8'9 (4.29m x 2.67m)
Window to rear aspect. Radiator.

Sitting Room 15'4 x 9'4 (4.67m x 2.84m)
Window and door to rear garden. Radiator.

Landing

Attic Room 1 12'4 x 17'4 (3.76m x 5.28m)

Attic Room 2 6' x 12'4 (1.83m x 3.76m)

Outside

Disclaimer

N.B Whilst these particulars are intended to give a fair description of the property concerned, their accuracy is not guaranteed and any intending purchaser must satisfy himself by inspection or otherwise, as to the correctness of statements contained herein.

The particulars do not constitute an offer or contract, and statements herein are made without responsibility, or warranty on the part of the Vendor or Manning Estate Agents, neither of whom can hold themselves responsible for expenses incurred should the property no longer be available. Items shown in photographs are NOT included unless specifically mentioned in particulars. They may however be available by separate negotiation.

The Property Misdescription Act 1991

The Agent has not tested any apparatus, equipment, fixtures and fittings or services and so cannot verify that they are in working order or fit for the purpose. A buyer is advised to obtain verification from their Solicitor or Surveyor. References to the Tenure of the property are based on information supplied by the seller. The Agent has not sight of the title documents. A Buyer is advised to obtain verification from their Solicitor.

You may download, store and use the material for your own personal use and research. You may not republish, retransmit, redistribute or otherwise make the material available to any party or make the same available on any website

Area Map



Floor Plans

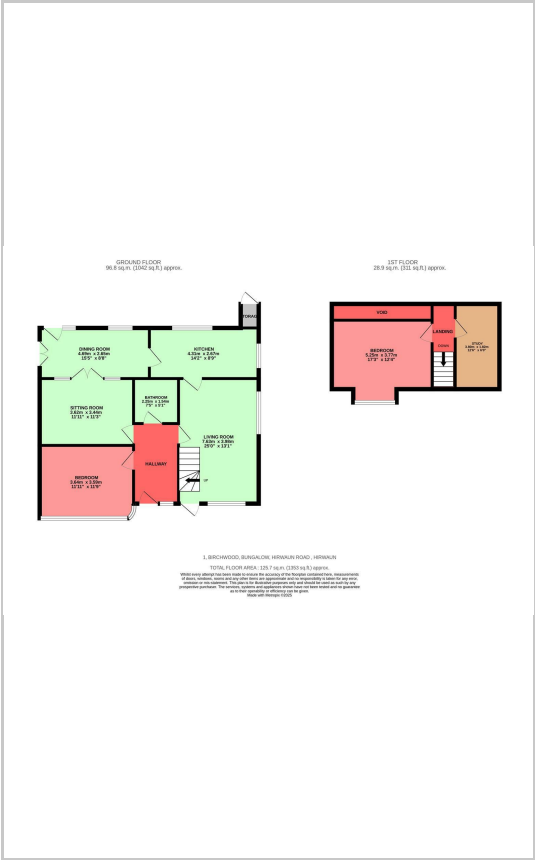

Energy Efficiency Graph

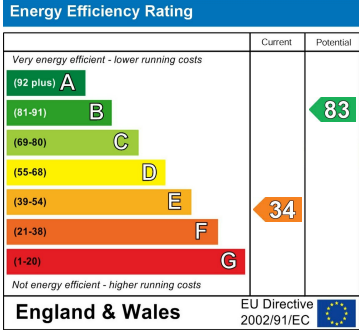

These particulars, whilst believed to be accurate are set out as a general outline only for guidance and do not constitute any part of an offer or contract. Intending purchasers should not rely on them as statements of representation of fact, but must satisfy themselves by inspection or otherwise as to their accuracy. No person in this firms employment has the authority to make or give any representation or warranty in respect of the property.