



3 Fern Crescent  
, Aberdare, CF44 8YA  
£359,995





# 3 Fern Crescent, Aberdare, CF44 8YA

- \*\* IMMACULATE 4 BEDROOM WELL ESTABLISHED DETACHED FAMILY HOME
- \*\* PRIME RESIDENTIAL LOCATION WITHIN WALKING DISTANCE OF SCHOOLS AND COUNTRY PARK
- \*\* RECENTLY REFURBISHED AND TASTEFULLY MODERNISED MUST SEE HOME
- \*\* ENTRANCE HALL. SITTING ROOM. DOWNSTAIRS W.C/UTILITY ROOM
- \*\* OPEN PLAN WELL EQUIPPED FITTED KITCHEN/DINING AND LIVING AREA IN ONE LIGHT AND AIRY SPACE
- \*\* UPSTAIRS MODERN LUXURY FAMILY BATHROOM. 4 BEDROOMS AND EN-SUITE SHOWER ROOM
- \*\* UNDERFLOOR HEATING TO GROUND FLOOR. UPVC DOUBLE GLAZED WINDOWS AND DOORS
- \*\* ENTRANCE DRIVE WITH AMPLE OFF ROAD PARKING. WORKSHOP/BIKE STORAGE
- \*\* LANDSCAPED WELL STOCKED AND MATURE GARDENS ENJOYING VIEWS TOWARDS THE COUNTRY PARK



## Front Porch

## Hallway

## Lounge

10'10 x 12'0 (3.30m x 3.66m)

## Cloakroom/Utility

## Oen plan fitted kitchen/Dining and living area

10'1 x 14'8 (3.07m x 4.47m)

## Living Area

11' x 15'7 (3.35m x 4.75m)

## Dining Area/Garden Room

11'5 x 10'4 (3.48m x 3.15m)

## Landing

## Bedroom 1

11'6 x 12'2 (3.51m x 3.71m)

## Ensuite Shower Room

## Bedroom 2

11'2 x 12'3 (3.40m x 3.73m)

## Bedroom 3

8'11 x 8'7 (2.72m x 2.62m)

## Bedroom 4

8'11 x 7'10 (2.72m x 2.39m)

## Modern spacious bathroom

9'5 x 5'0 (2.87m x 1.52m)

## Outside Garden

## Workshop/Bike Storage

18'5 x 8'9 (5.61m x 2.67m)

## Disclaimer

## Area Map



## Floor Plan

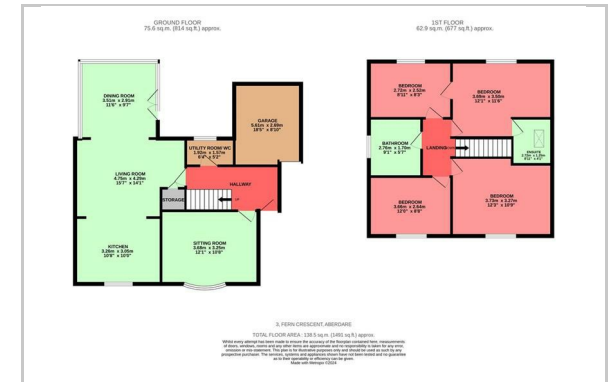

## Energy Efficiency Graph

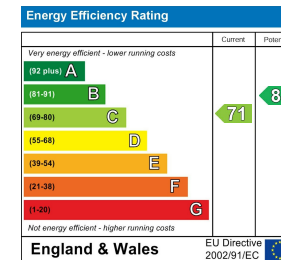

These particulars, whilst believed to be accurate are set out as a general outline only for guidance and do not constitute any part of an offer or contract. Intending purchasers should not rely on them as statements of representation of fact, but must satisfy themselves by inspection or otherwise as to their accuracy. No person in this firm's employment has the authority to make or give any representation or warranty in respect of the property.