

**RUSH
WITT &
WILSON**



Proposed North Elevation

1:100 scale



MATERIAL KEY:

Roof - Clay tile.
Walls - Brick and flint matching existing to fill in opening, oak cladding.
Doors and Windows - Timber effect windows



Proposed South Elevation

**Holly Barn Worsham Lane, Bexhill-On-Sea, East Sussex TN40 2QP
£525,000**

A brand new beautiful two bedroom detached single storey barn is nearing completion, forming part of this private development, situated in this picturesque rural location, boasting a tranquil environment, overlooking and backing onto fields and adjoining countryside. Thoughtfully designed throughout, full of character and charm, the property comprises, large modern open plan kitchen/living room, two bedrooms, modern fitted bathroom suite and ensuite to master bedroom. Other benefits include electric under floor heating system, double glazed windows and doors, stunning views from every window and a further benefit of a 10 year ABC builders warranty, outstanding insulation throughout with great energy efficiency. Externally, the property boasts a beautifully landscaped private front gardens. Whether you are looking for a weekend getaway or a permanent residence, this barn conversion project offers a unique opportunity to enjoy the beauty of the countryside while still benefiting from modern amenities. Viewing comes highly recommended by Rush, Witt & Wilson. Please Note: Internal & External photos are for illustration purposes only and may not reflect the exact finished build.



Entrance Hallway

Open Plan Living/ Dining/ Kitchen

Bedroom One

En-Suite

Bedroom Two

Bathroom

Outside

Private Gardens

Off Road Parking

Agents Note

None of the services or appliances mentioned in these sale particulars have been tested. It should also be noted that measurements quoted are given for guidance only and are approximate and should not be relied upon for any other purpose.



UNIT 5

2 bed 3 people
Total GIA
92 sqm

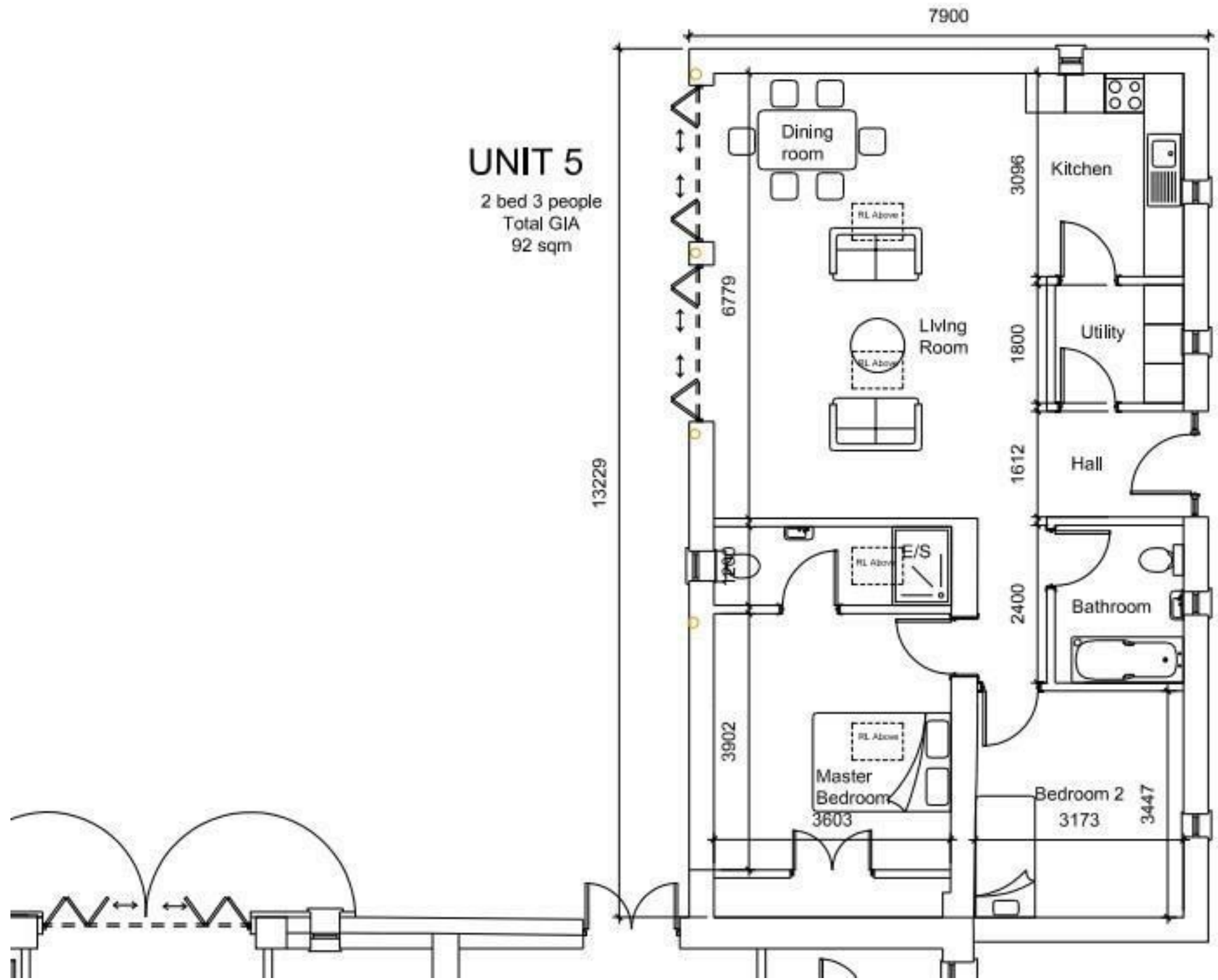

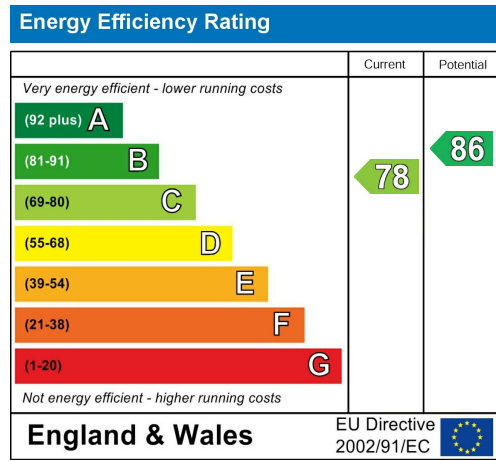
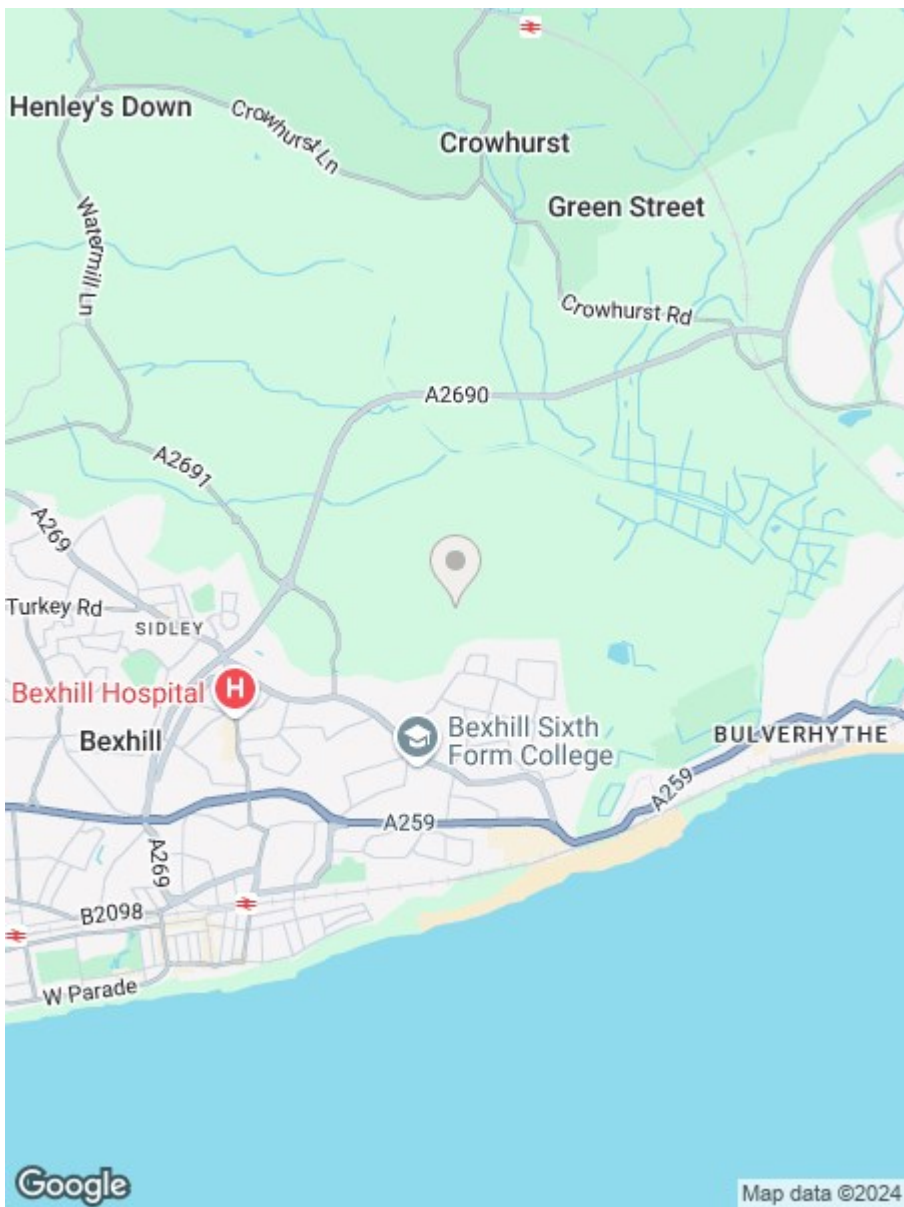

**RUSH
WITT &
WILSON**

Residential Estate Agents
Lettings & Property Management



3 Devonshire Road
Bexhill-on-Sea
East Sussex
TN40 1AH
Tel: 01424 225588
bexhill@rushwittwilson.co.uk
www.rushwittwilson.co.uk