

**RUSH  
WITT &  
WILSON**



RUSH  
WITT &

**6 Nightingale Cottages New Cut, Westfield, TN35 4RL**  
**Offers In The Region Of £280,000**



Nestled in the charming village of Westfield, this delightful end-terraced cottage presents an exceptional opportunity for those seeking a blend of comfort and tranquillity. The property boasts three well-proportioned bedrooms and two bathrooms, making it ideal for families or those wishing to enjoy extra space. Upon entering, you are welcomed into a spacious lounge/orangery, which features a striking log burner, perfect for cosy evenings. This inviting space overlooks the beautifully maintained gardens, allowing for a seamless connection with nature. The separate kitchen-breakfast room is well-equipped, providing a lovely area for family meals and entertaining guests. The ground floor also includes a versatile study that can serve as a third bedroom, complete with an en suite shower room for added convenience. Ascending to the first floor, you will find two generous double bedrooms, accompanied by another shower room, ensuring ample facilities for all residents. The property occupies a corner plot, enhancing its appeal with stunning gardens that are both private and secluded. The outdoor space is adorned with a variety of mature shrubs and plants, creating a serene environment. There are also inviting seating areas and even a chicken coop, perfect for those with a penchant for gardening or a desire for a self-sufficient lifestyle. Backing onto woodland, this home offers a peaceful retreat from the hustle and bustle of everyday life. Additionally, the property includes allocated parking for two vehicles, ensuring convenience for residents and guests alike. This charming cottage in a semi-rural location is a rare find, combining modern living with the beauty of nature, making it a must-see for prospective buyers.













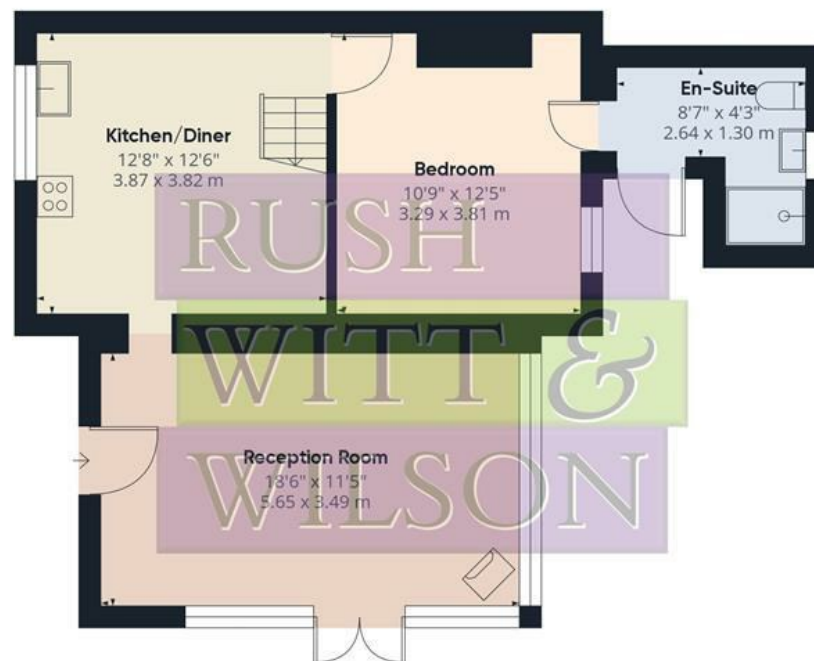

Floor 0



Floor 1

**Approximate total area<sup>(1)</sup>**

836.89 ft<sup>2</sup>

77.75 m<sup>2</sup>

(1) Excluding balconies and terraces

While every attempt has been made to ensure accuracy, all measurements are approximate, not to scale. This floor plan is for illustrative purposes only.

Calculations are based on RICS IPMS 3C standard.

**GIRAFFE 360**

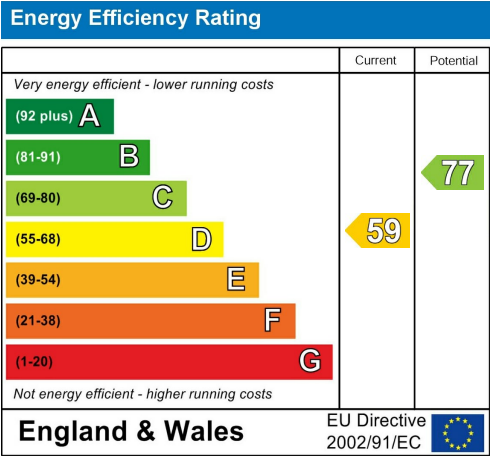
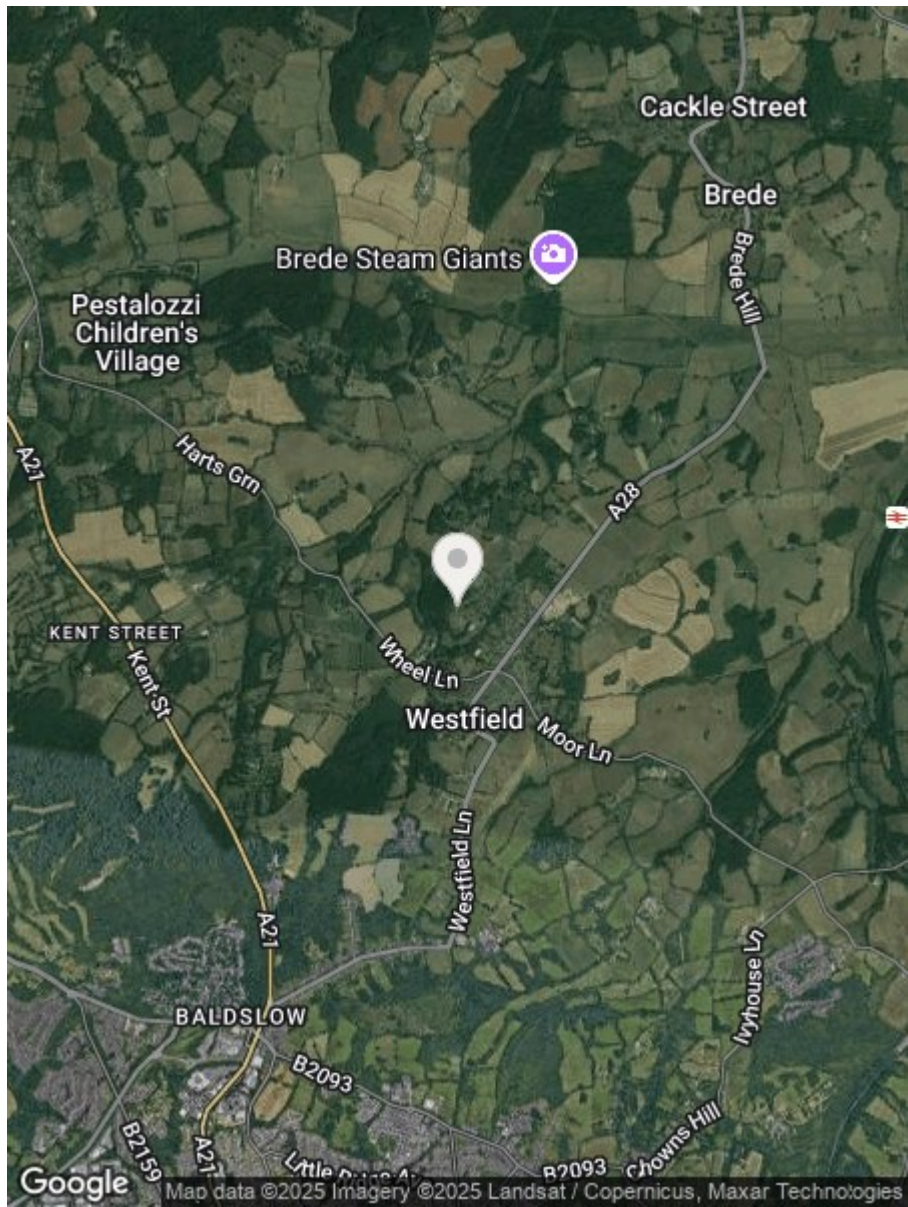

**RUSH  
WITT &  
WILSON**

**Residential Estate Agents**  
**Lettings & Property Management**



**Rother House Havelock Road**  
**Hastings**  
**East Sussex**  
**TN34 1BP**  
**Tel: 01424 442443**  
**hastings@rushwittwilson.co.uk**  
**www.rushwittwilson.co.uk**