

**RUSH  
WITT &  
WILSON**



RUSH  
WITT &  
WILSON

**2 Lydd Close, St. Leonards-On-Sea, TN38 9AD**  
**Guide Price £280,000**



**\*\* GUIDE PRICE £280,000 - £290,000 \*\*** Nestled in the charming Lydd Close, St. Leonards-On-Sea, this well-presented three-bedroom terraced house offers a delightful blend of modern living and convenience. Built in 2008 by the reputable Jones Homes, this property is perfect for families or individuals seeking a comfortable home in a friendly neighbourhood. Upon entering, you will find a spacious reception room that invites natural light, creating a warm and welcoming atmosphere. The modern fitted kitchen is equipped with integrated appliances, and offers an open plan feel. The property boasts three well-sized bedrooms, providing ample space for relaxation and rest. The bathroom is thoughtfully designed to cater to your daily needs. One of the standout features of this home is the garage, complemented by a block-paved driveway. The rear garden is a true gem, featuring a patio area and raised decking, perfect for outdoor entertaining or simply enjoying the fresh air. With rear access and a door leading to the garage. Located within close proximity to local shops and the highly regarded Robsack Wood Primary Academy School, this home is ideally situated for families and professionals alike. This terraced house presents an excellent opportunity for those looking to settle in a modern development in West St. Leonards. Don't miss your chance to make this lovely house your new home.











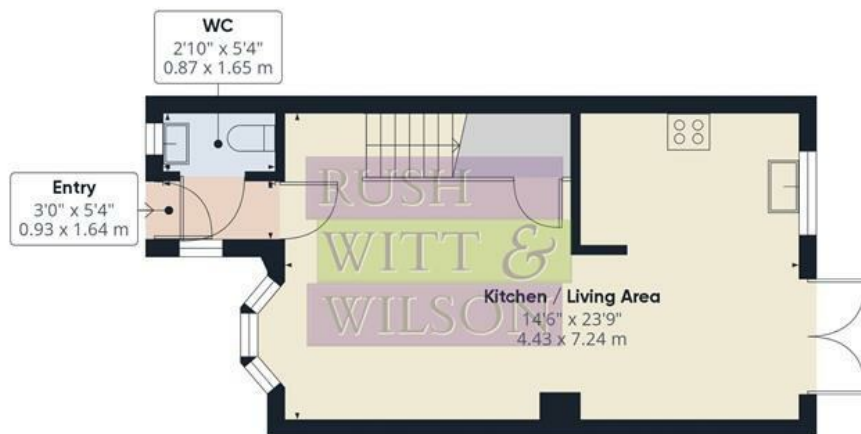

Floor 0 Building 1



Floor 1 Building 1



Floor 0 Building 2

**Approximate total area<sup>(1)</sup>**

838.39 ft<sup>2</sup>

77.89 m<sup>2</sup>

(1) Excluding balconies and terraces

While every attempt has been made to ensure accuracy, all measurements are approximate, not to scale. This floor plan is for illustrative purposes only.

Calculations were based on RICS IPMS 3C standard. Please note that calculations were adjusted by a third party and therefore may not comply with RICS IPMS 3C.



