

**RUSH
WITT &
WILSON**



**RUSH
WITT &**

135b Emmanuel Road, Hastings, TN34 3LE
Offers In Excess Of £140,000

****CHAIN FREE**** Nestled in the charming Emmanuel Road of Hastings, this delightful one bedroom GARDEN APARTMENT offers a perfect blend of comfort and convenience. With its own private entrance and original features, this property exudes character and warmth. Situated in the sought-after West Hill area, this flat is ideally located between the vibrant Town Centre and the historic Old Town, allowing for easy exploration of all that Hastings has to offer. The bay fronted living room welcomes you with natural light, creating a bright and inviting atmosphere in this lower ground floor apartment. The modern kitchen boasts ample storage and worktop space, seamlessly flowing into a convenient utility area. At the rear of the flat, you'll find a bathroom with a neutral suite, providing a tranquil space for relaxation. Step outside to discover a charming Westley facing garden, perfect for enjoying the outdoors in a low-maintenance setting. Whether you're a first-time buyer, downsizer, or investor, this property offers a wonderful opportunity to own a piece of Hastings' rich history and vibrant community. Don't miss out on making this lovely flat your new home!

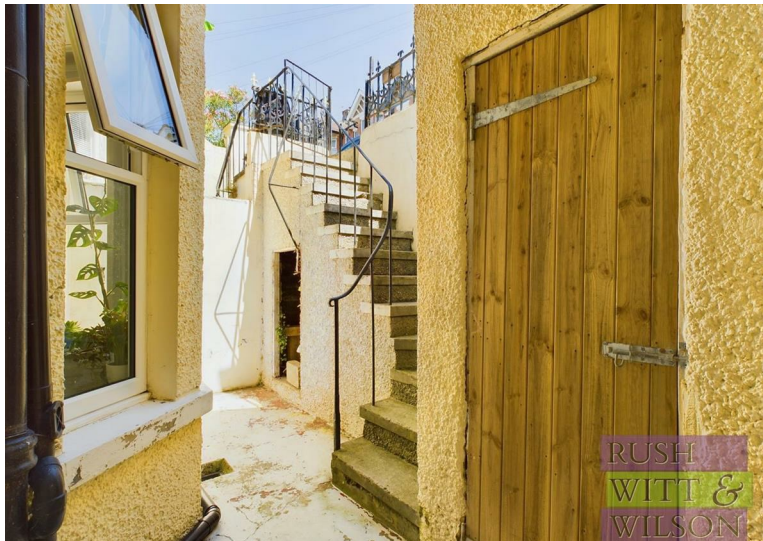





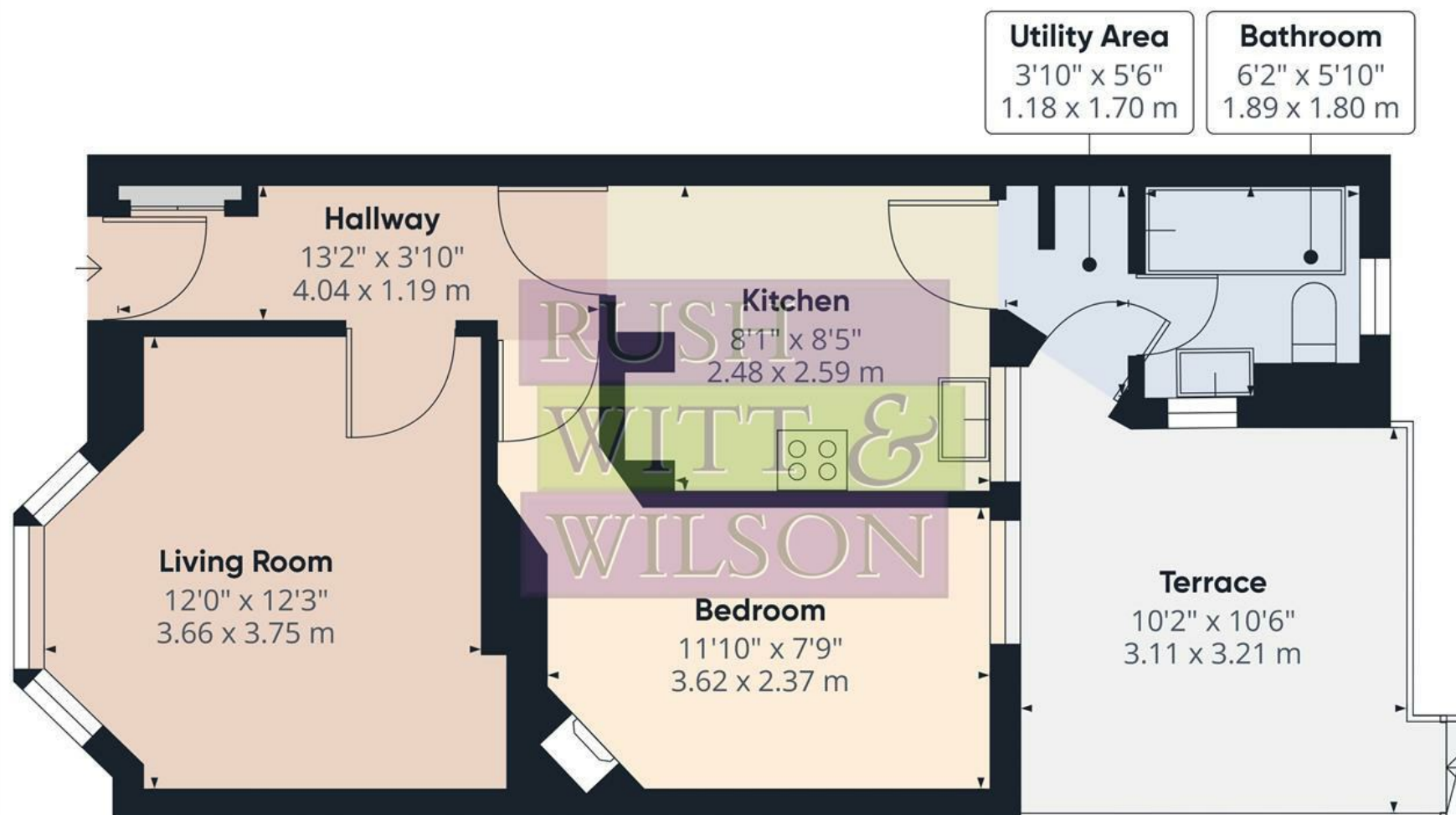

Approximate total area⁽¹⁾

430.66 ft²

40.01 m²

(1) Excluding balconies and terraces

While every attempt has been made to ensure accuracy, all measurements are approximate, not to scale. This floor plan is for illustrative purposes only.

GIRAFFE 360

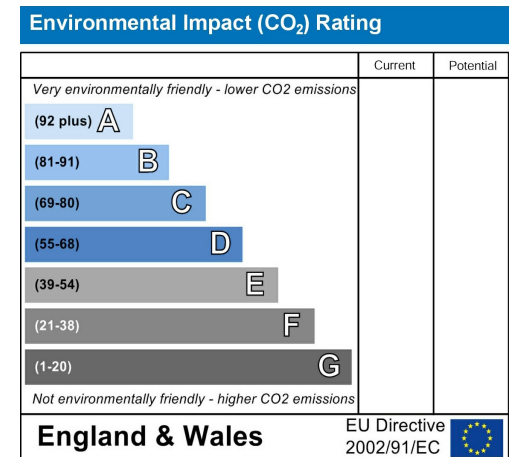
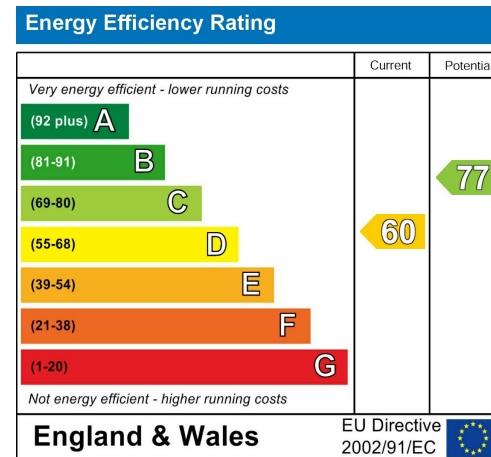
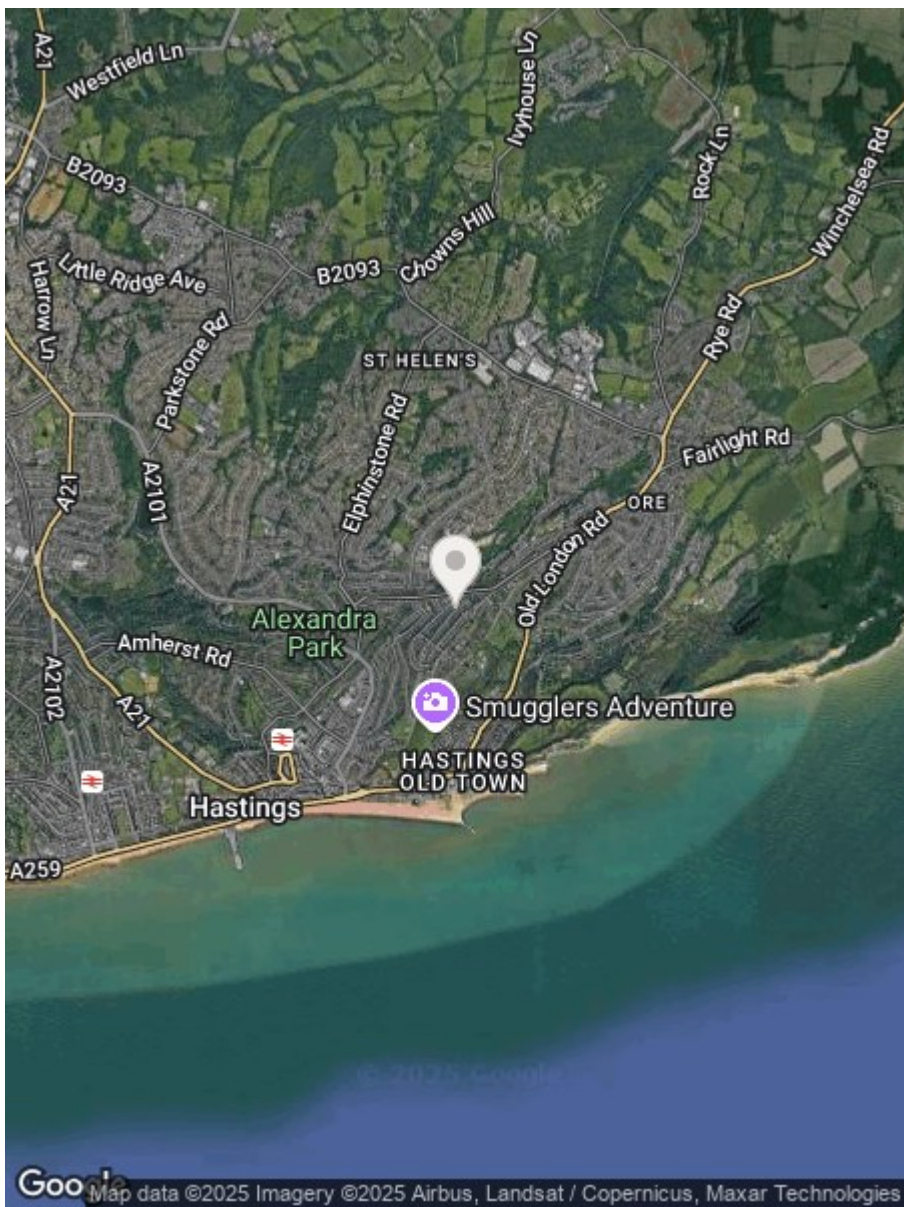

**RUSH
WITT &
WILSON**

Residential Estate Agents
Lettings & Property Management



Rother House Havelock Road
Hastings
East Sussex
TN34 1BP
Tel: 01424 442443
hastings@rushwittwilson.co.uk
www.rushwittwilson.co.uk