

RUSH  
WITT &  
WILSON



RUSH  
WITT &

**27 Heathlands, Westfield, TN35 4QZ**  
**£350,000**



**A spacious and extended three bedroom semi-detached home located in a highly sought after residential area within Westfield Village. Accommodation comprises of a generous living room, kitchen/breakfast room with door to the rear garden and a cloakroom/wc. To the first floor, a bright landing serves three spacious bedrooms and a well appointed bathroom suite. Outside the property offers a private and low maintenance rear garden. To the front it offers off road parking and an attached single garage. The highly regarded village of Westfield offers a local convenience store, butchers, surgery, pub serving food and well regarded Primary School, just a short distance to the A21 and 5 miles from Battle mainline railway station.**











RUSH  
WITT &  
WILSON



RUSH  
WITT &  
WILSON



RUSH  
WITT &  
WILSON



RUSH  
WITT &  
WILSON



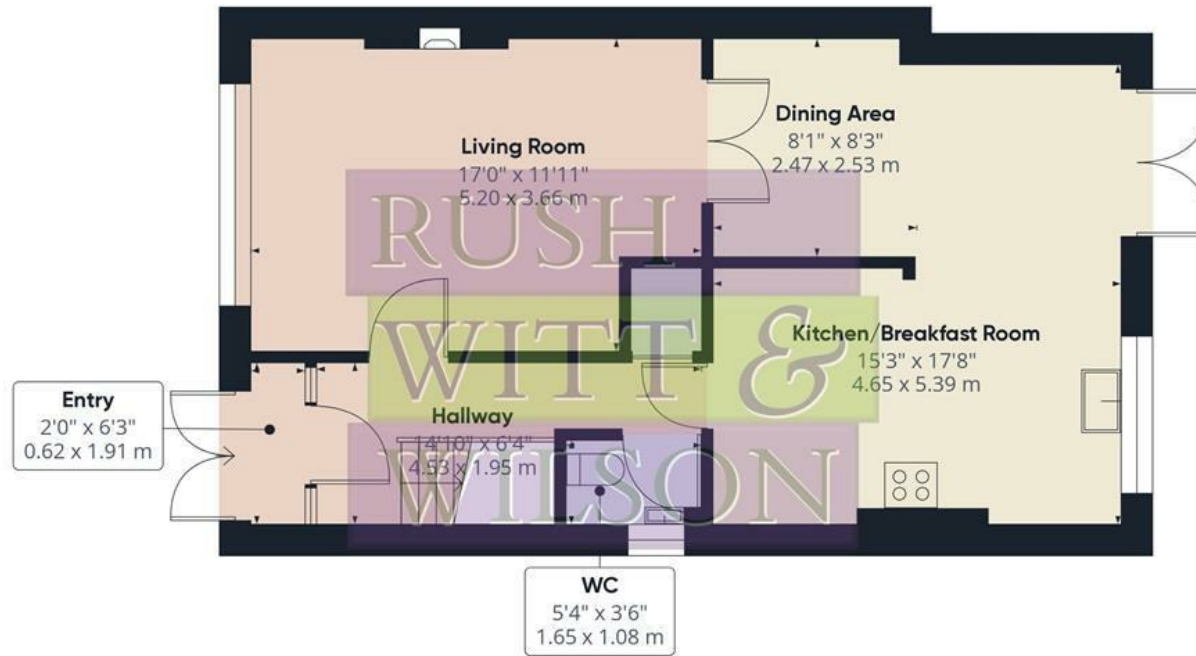

Floor 0

Approximate total area<sup>(1)</sup>

1033.12 ft<sup>2</sup>

95.98 m<sup>2</sup>



Floor 1

(1) Excluding balconies and terraces

While every attempt has been made to ensure accuracy, all measurements are approximate, not to scale. This floor plan is for illustrative purposes only.

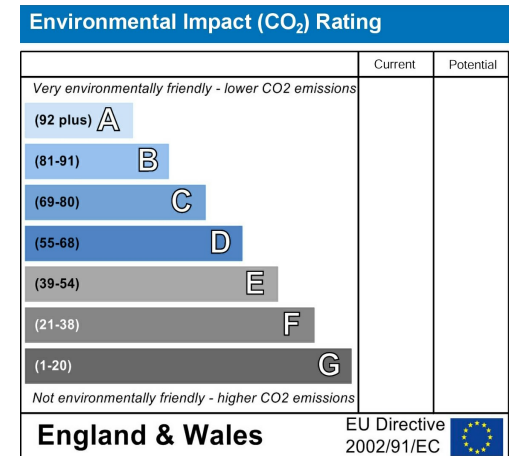
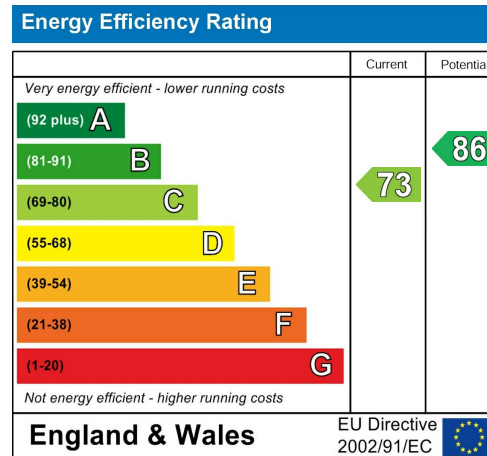
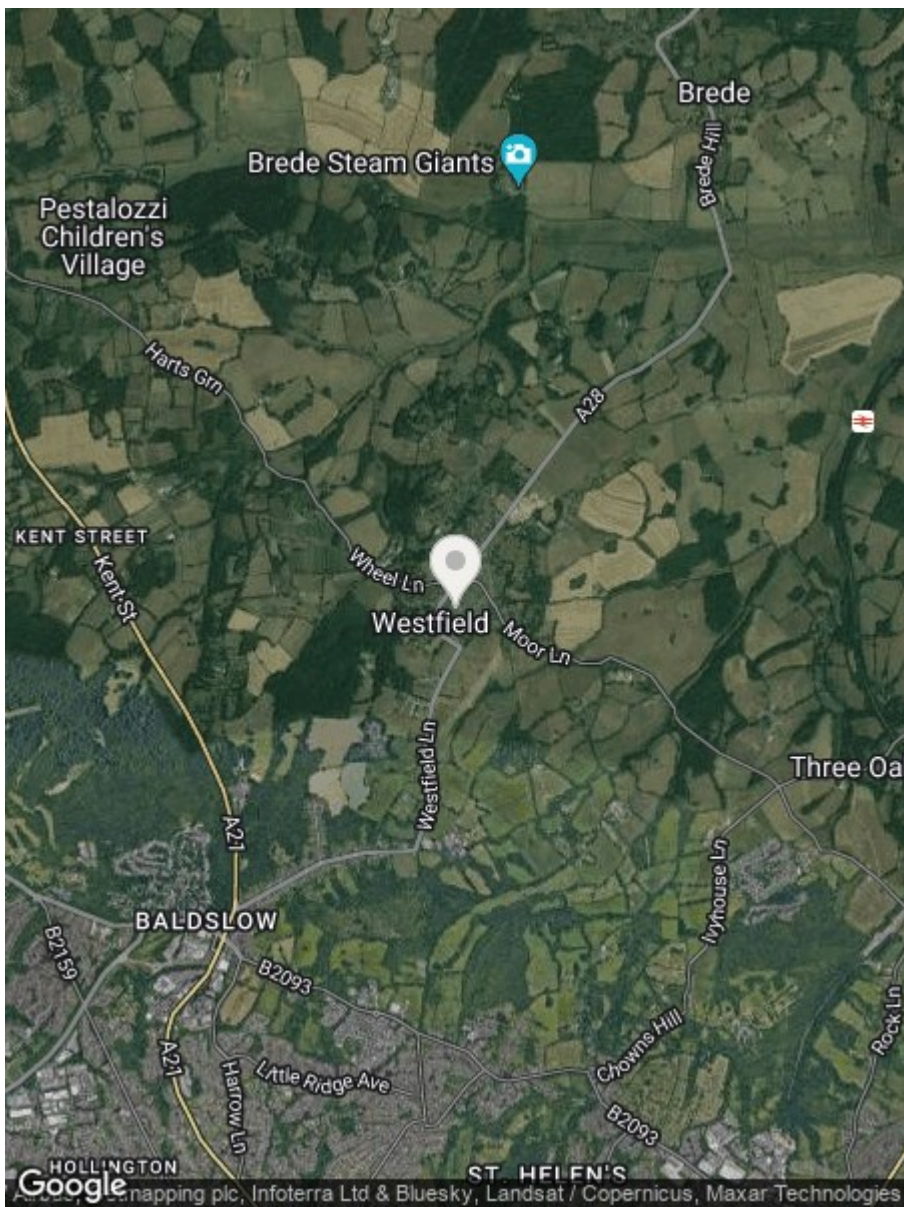

**RUSH  
WITT &  
WILSON**

**Residential Estate Agents**  
Lettings & Property Management



**Rother House Havelock Road**  
Hastings  
East Sussex  
TN34 1BP  
Tel: 01424 442443  
hastings@rushwittwilson.co.uk  
www.rushwittwilson.co.uk