

**RUSH
WITT &
WILSON**



**RUSH
WITT &**

**Rose Cottage, 4B Gillsmans Hill, St. Leonards-On-Sea, TN38 0SP
Offers In Excess Of £295,000**

Presenting a two-storey, three bedroom terrace property, sprawled over a generous 1063.94 square feet. This characterful weather-boarded home is newly refurbished throughout and features a beautifully designed kitchen with integrated appliances, a cloakroom/wc and a well-appointed living room. Ascending to the upper floor you will be greeted by three well proportioned double bedrooms of which the master features a stylish en-suite and a marvellous family bathroom suitable for any families needs. Finally the rear garden is fully enclosed and offers a small patio area with an area of garden set beyond. The property is being sold chain free and is an excellent choice for those who value privacy coupled with a practical layout.









Floor 0

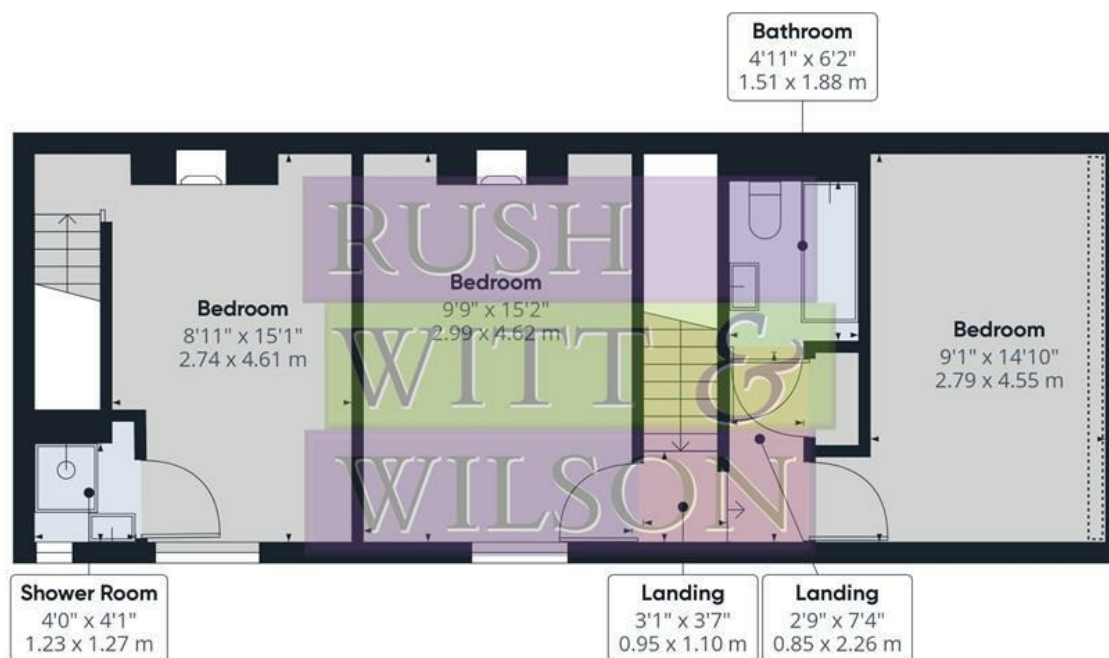

Floor 1

Approximate total area⁽¹⁾

1063.94 ft²

98.84 m²

Reduced headroom

9.45 ft²

0.88 m²

(1) Excluding balconies and terraces

Reduced headroom
(below 1.5m/4.92ft)

While every attempt has been made to ensure accuracy, all measurements are approximate, not to scale. This floor plan is for illustrative purposes only.

GIRAFFE 360

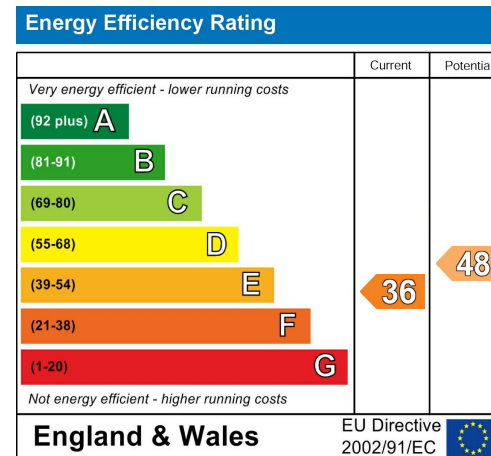
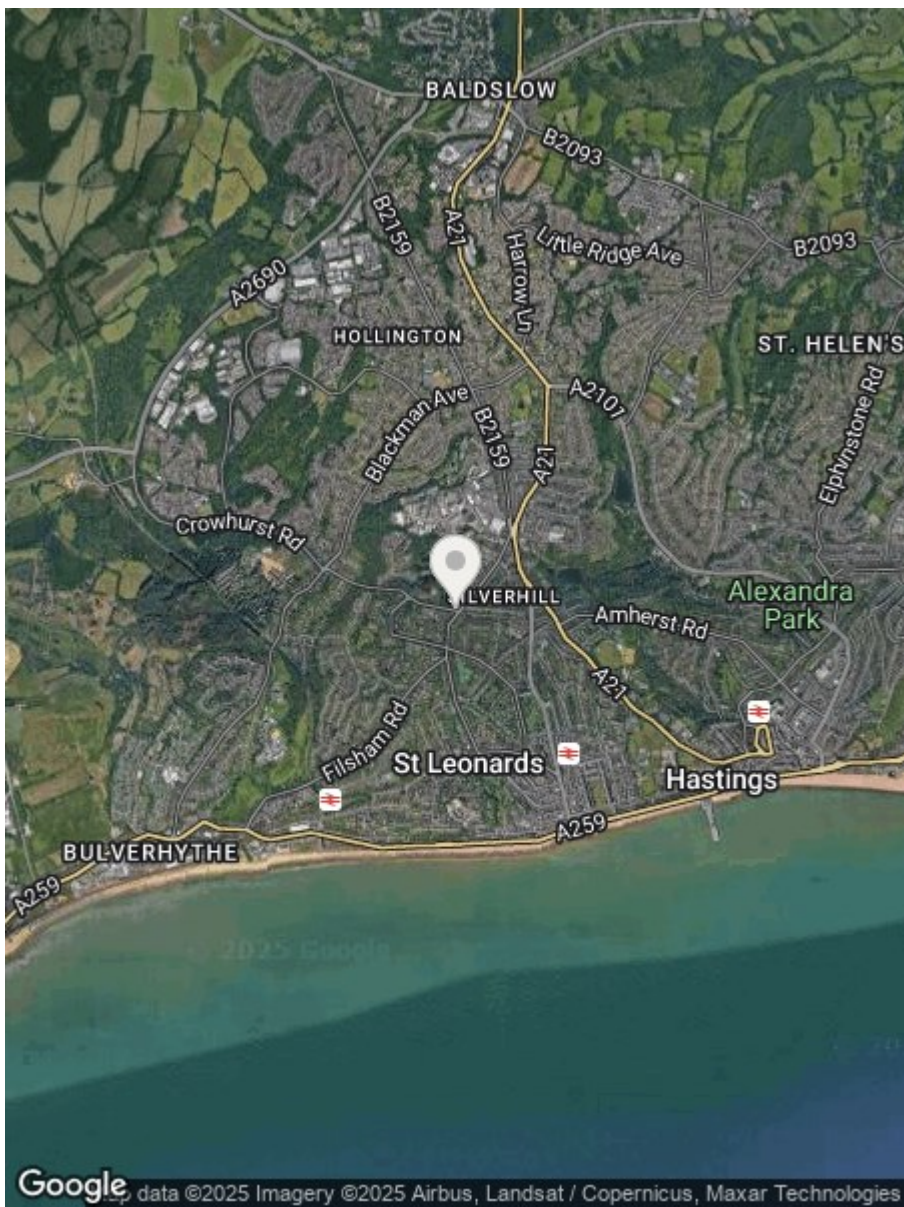

**RUSH
WITT &
WILSON**

Residential Estate Agents
Lettings & Property Management



Rother House Havelock Road
Hastings
East Sussex
TN34 1BP
Tel: 01424 442443
hastings@rushwittwilson.co.uk
www.rushwittwilson.co.uk