

RUSH
WITT &
WILSON



RUSH
WITT &

22 Linton Crescent, Hastings, East Sussex TN34 1TJ
£550,000

*****360° HDR VIRTUAL TOUR*****

Rush Witt & Wilson welcome to the market this elegant Victorian townhouse situated in a sought after crescent directly opposite Linton Gardens favoured for its immediate ease of access to the town centre, mainline railway station, seafront and the pier whilst enjoying a quiet and peaceful setting. The property enjoys a versatile arrangement of accommodation arranged over four floors comprising in principle of a living room, dining room, modern fitted kitchen/breakfast room with integrated appliances and a spiral staircase leading to the rear garden. To the first floor a beautiful bath/shower room, separate wc, two double bedrooms with bedroom two giving access to the rear garden via the French doors, to the second floor three further bedrooms and access to the spacious loft room. Enjoying many character features to include fireplaces to its principle rooms, high ceilings, attractive coving and beautiful views. Early internal viewings come highly recommended via appointed sole agents Rush Witt & Wilson for this property that is offered for sale with no onward chain.







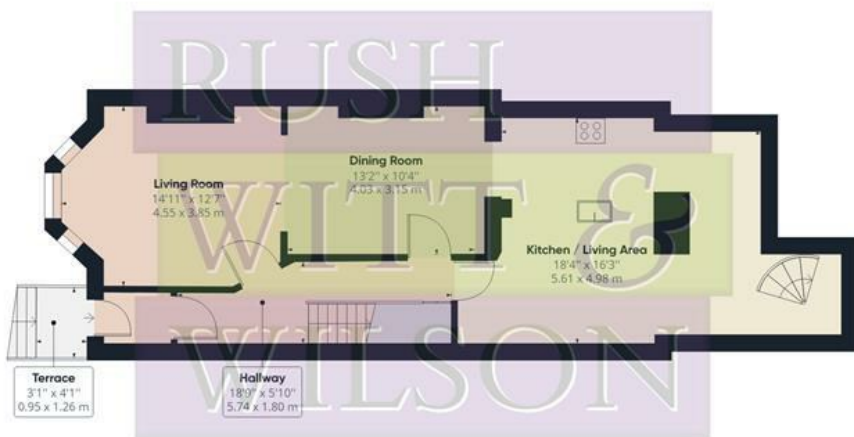

Floor 0



Floor 1



Floor 2

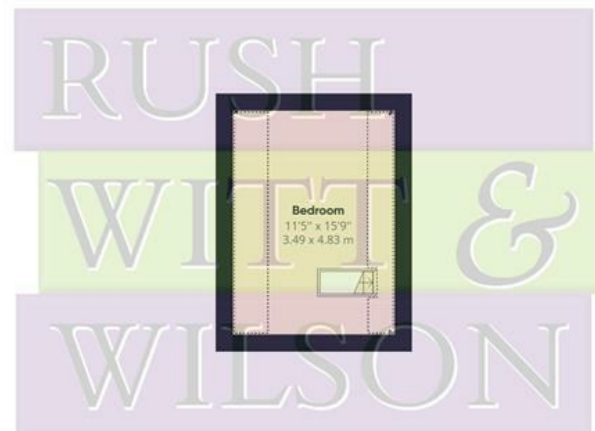

Floor 3

Approximate total area⁽¹⁾

1832.37 ft²

170.23 m²

Reduced headroom

68.10 ft²

6.33 m²

(1) Excluding balconies and terraces

 Reduced headroom (below 1.5m/4.92ft)

While every attempt has been made to ensure accuracy, all measurements are approximate, not to scale. This floor plan is for illustrative purposes only.

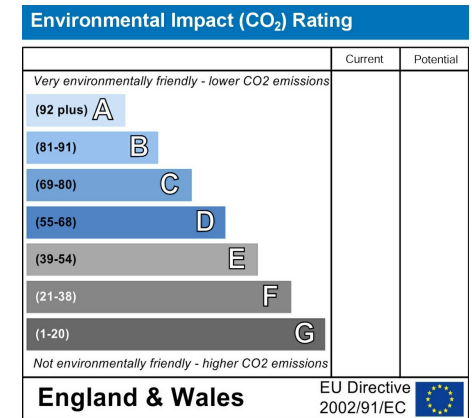
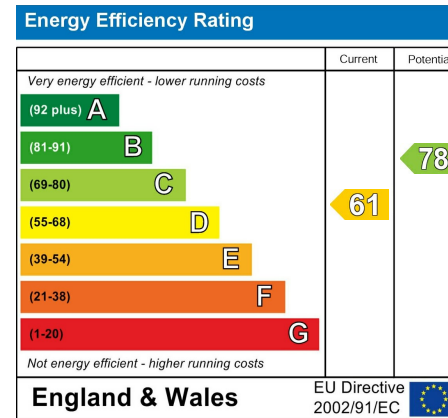
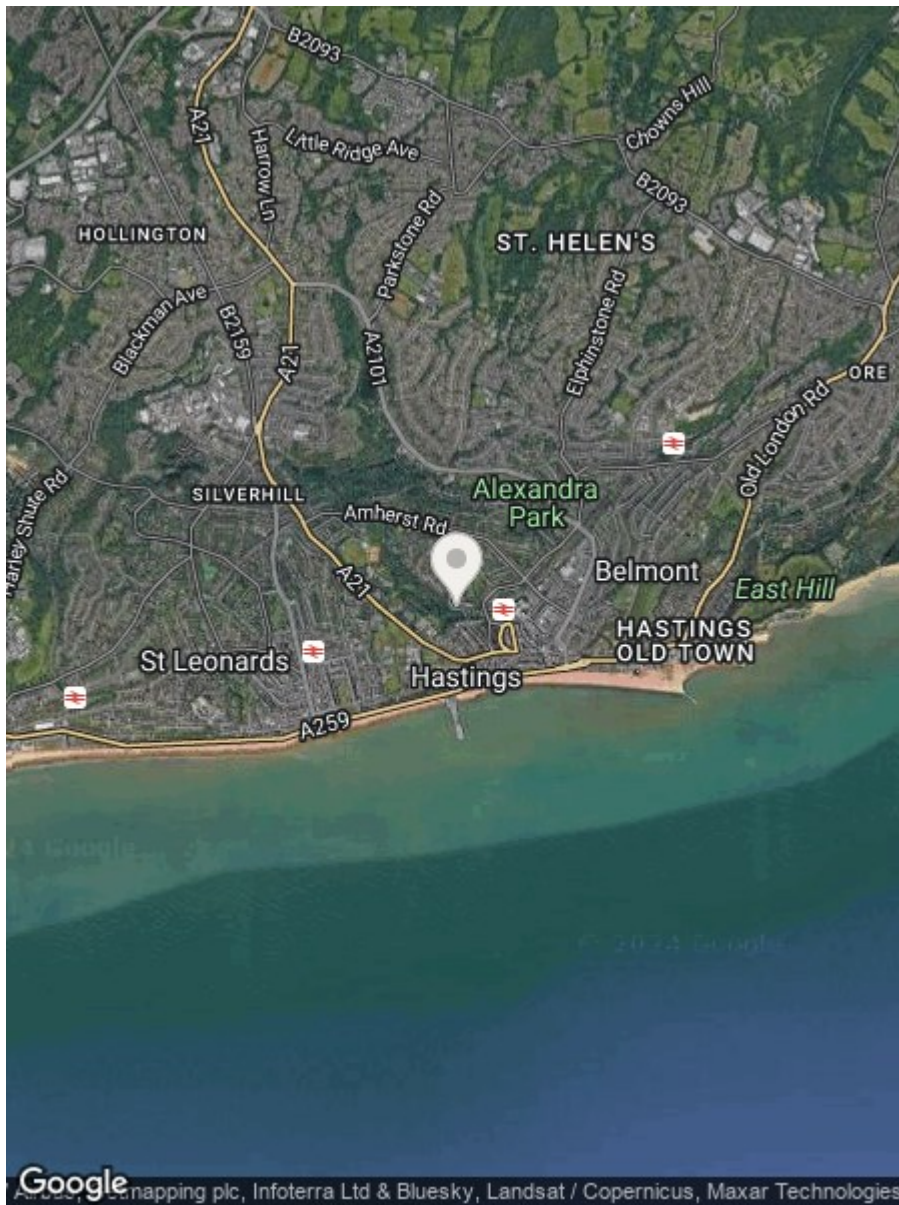

**RUSH
WITT &
WILSON**

Residential Estate Agents
Lettings & Property Management



Rother House Havelock Road
Hastings
East Sussex
TN34 1BP
Tel: 01424 442443
hastings@rushwittwilson.co.uk
www.rushwittwilson.co.uk