



**JAMES
ANDERSON**



FOR SALE

£1,900 Per Month

Rosemary Gardens, Mortlake, SW14

Per Month

A well presented ground floor two bedroom apartment which offers a great location close to Mortlake Station. The living space offers a good sized living room, two bedrooms, hallway with storage, fully fitted kitchen and a modern bathroom. Further benefits include residents parking and well maintained communal gardens. Rosemary Gardens is a very convenient location close to Mortlake Green, Mortlake Station and a few minutes walk from Thomson House Primary School.



Two Bedrooms



One Bathroom



Part Furnished



Modern Kitchen



EPC C | Council Tax Band C | Minimum Term 12 Months



Mortlake Station



Thomson House Primary School



Close to Mortlake Green



Ground Floor Apartment



Deposit £2192.30 | Holding Deposit £438.46



OPEN 7 DAYS A WEEK • Weekdays until 9pm • Weekends until 5pm

0208 876 6611

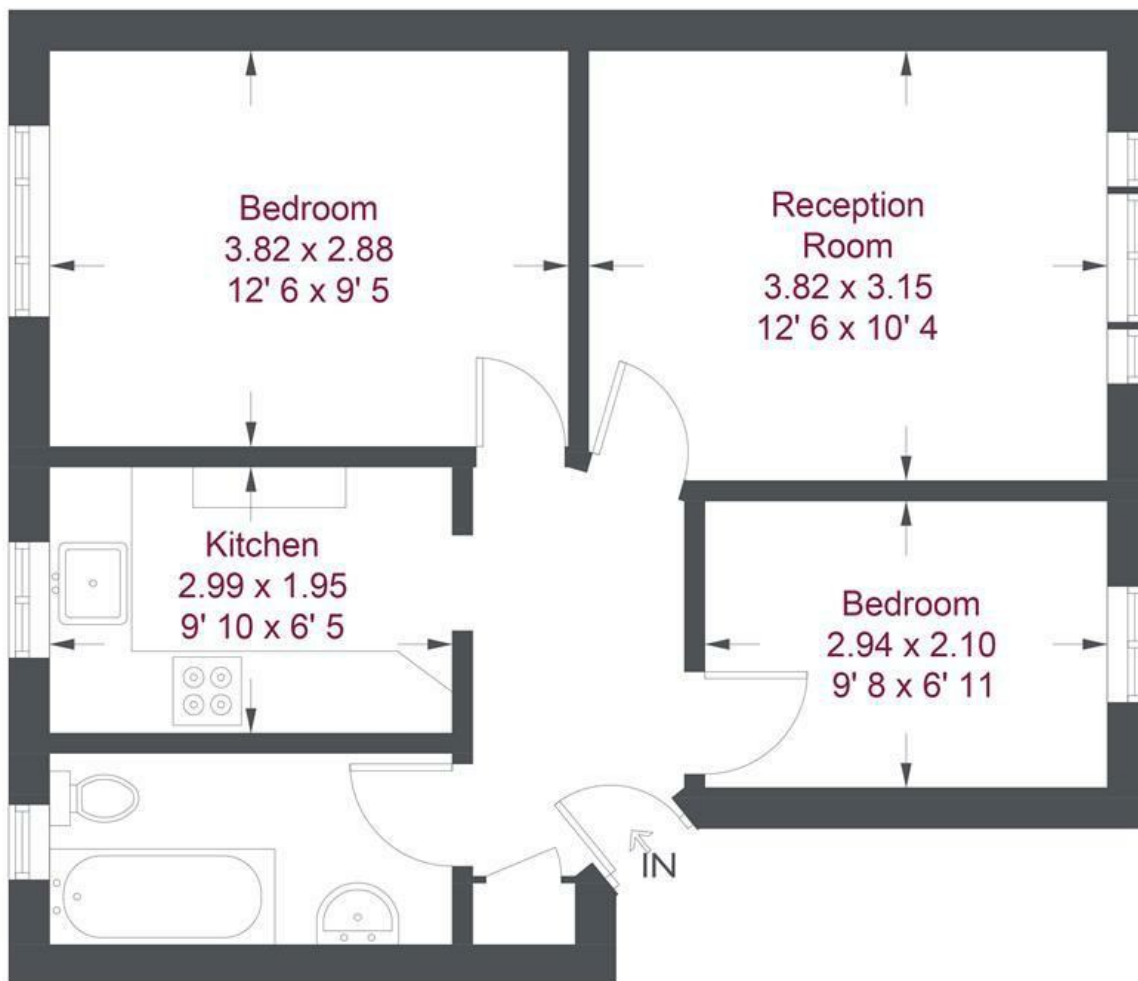

Ground Floor

Rosemary Gardens

Approximate Gross Internal Area = 518 sq ft / 48.1 sq m

Not to scale, for guidance only and must not be relied upon as a statement of fact
 All measurements and areas are approximate only and have been prepared in accordance with the current edition of the RICS Code of Measuring Practice

| Energy Efficiency Rating | | |
|--|-------------------------|-----------|
| | Current | Potential |
| <i>Very energy efficient - lower running costs</i> | | |
| (92 plus) A | | |
| (81-91) B | | |
| (69-80) C | | |
| (55-68) D | | |
| (39-54) E | | |
| (21-38) F | | |
| (1-20) G | | |
| <i>Not energy efficient - higher running costs</i> | | |
| England & Wales | EU Directive 2002/91/EC | |

| Environmental Impact (CO ₂) Rating | | |
|---|-------------------------|-----------|
| | Current | Potential |
| <i>Very environmentally friendly - lower CO₂ emissions</i> | | |
| (92 plus) A | | |
| (81-91) B | | |
| (69-80) C | | |
| (55-68) D | | |
| (39-54) E | | |
| (21-38) F | | |
| (1-20) G | | |
| <i>Not environmentally friendly - higher CO₂ emissions</i> | | |
| England & Wales | EU Directive 2002/91/EC | |

