

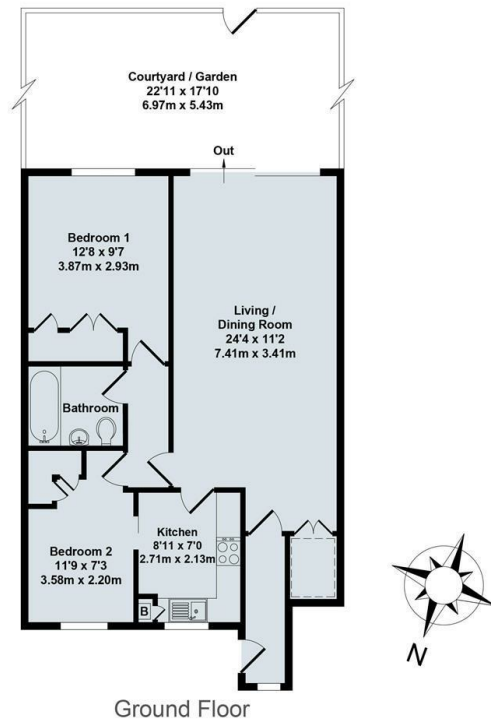

## 8 Rose Court, Hillsborough Road, Cowley, Oxford, OX4 3TA

£1,500 PCM - 6th December 2025.

- Two bedroom maisonette
- Gas CH
- EPC rating
- Ground floor
- Small garden
- Council Tax Band C
- Unfurnished with appliances
- Allocated parking for 1 car
- Mains gas electricity and water



Total Approx. Floor Area 651 Sq.Ft. (60.50 Sq.M.)  
All items illustrated on this plan are included in the "Total Approx Floor Area"

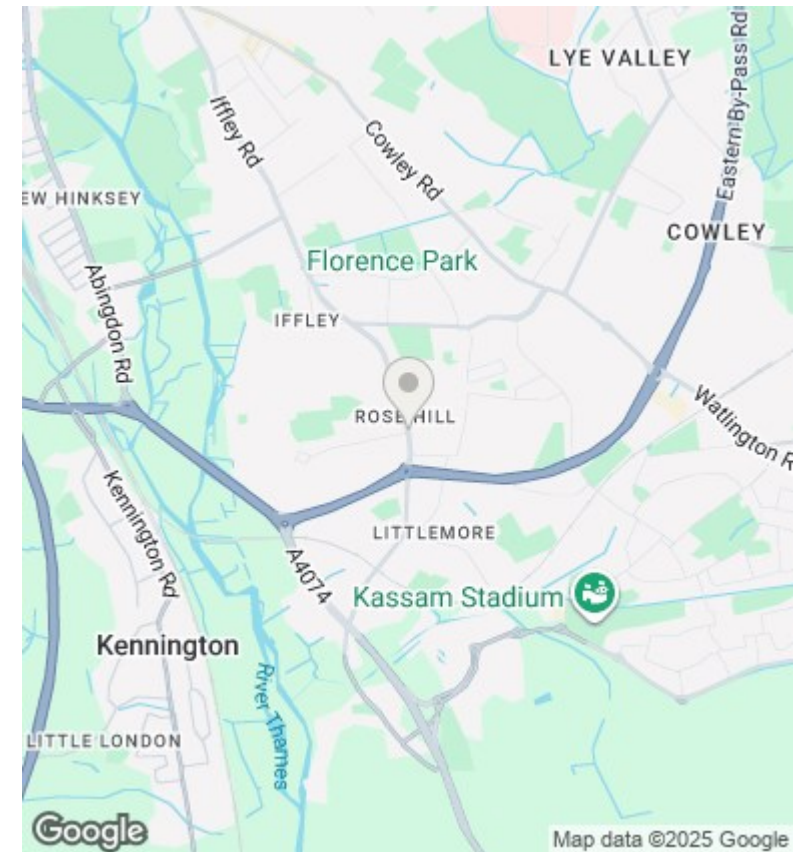

## Directions

## Viewings

Viewings by arrangement only. Call 01865 515900 to make an appointment.

## Council Tax Band

C

## EPC Rating:

C

Energy Efficiency Rating		
	Current	Potential
Very energy efficient - lower running costs		
(92-plus) A		
(81-91) B		
(69-80) C	73	77
(55-68) D		
(39-54) E		
(21-38) F		
(1-20) G		
Not energy efficient - higher running costs		
England & Wales	EU Directive 2002/91/EC	