



## 103 Chorefields, Kidlington, OX5 1SY

£1,500 - 1st July 2025.

- Two bedroom bungalow
- Gas CH
- Off street parking and garage
- Mains gas electricity and water
- Semi-detached
- Conservatory
- EPC rating D
- Unfurnished with kitchen appliances
- Rear garden
- Council Tax Band D

# 103 Chorefields, Kidlington OX5 1SY

A two bedroom semi-detached bungalow located within walking distance of the village centre and buses to Headington hospitals, Oxford Parkway and City centre. Double bedroom with fitted wardrobes, Single bedroom with fitted wardrobes, Shower room, Living/Dining room with electric fire, Fully fitted kitchen with electric oven, induction hob, fridge/freezer, washing machine and integrated dishwasher. Conservatory. Gas central heating. Boarded loft. Rear garden. Garage. Off street parking.



Council Tax Band: D













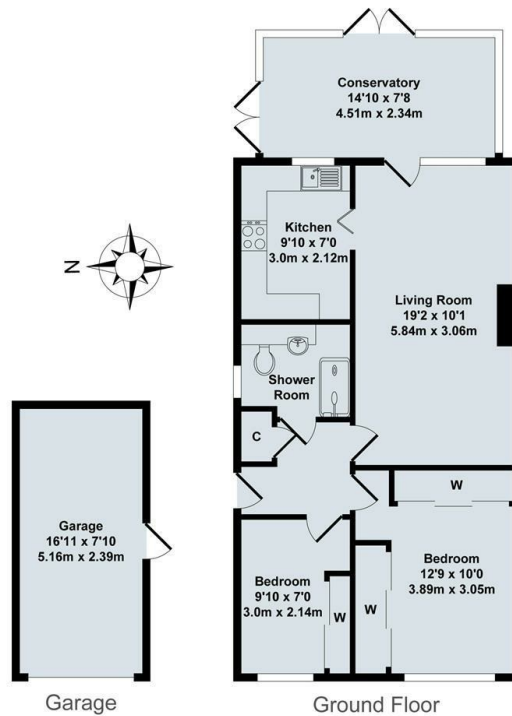

Total Approx. Floor Area 816 Sq.Ft. (75.80 Sq.M.)  
All items illustrated on this plan are included in the "Total Approx Floor Area"

## Directions

## Viewings

Viewings by arrangement only. Call 01865 515900 to make an appointment.

## Council Tax Band

D

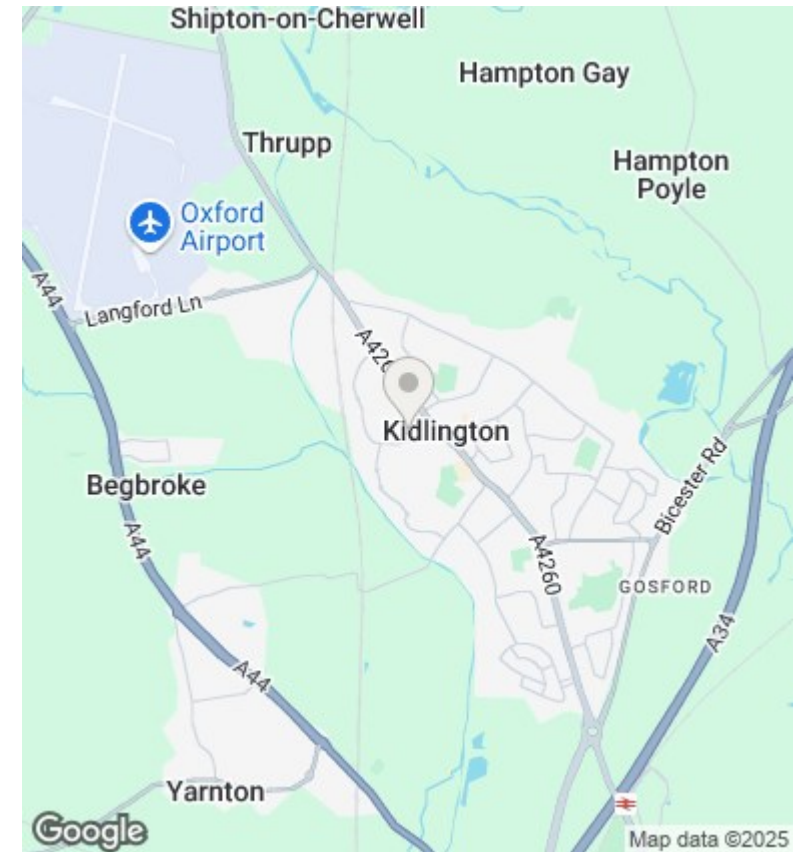

Energy Efficiency Rating		
	Current	Potential
Very energy efficient - lower running costs		
(92 plus) <b>A</b>		<b>84</b>
(81-91) <b>B</b>		
(69-80) <b>C</b>	<b>65</b>	
(55-68) <b>D</b>		
(39-54) <b>E</b>		
(21-38) <b>F</b>		
(1-20) <b>G</b>		
Not energy efficient - higher running costs		
England & Wales		EU Directive 2002/91/EC