

28g Westminster Way, Oxford, OX2 0LW

£1,400 PCM - 27th August 2025

- First floor
- White goods included
- Communal gardens
- Mains gas electricity and water
- One bedroom
- Gas CH
- EPC rating B
- Unfurnished
- Allocated parking for 1 car
- Council Tax Band B

28g Westminster Way, Oxford OX2 0LW

Built in 2016, a one bedroom first floor apartment finished to a high standard and available unfurnished. Easy access to Oxford and the City Centre. Gas CH, Appliances included - oven, gas hob, fridge/freezer, dishwasher and washer/dryer, Communal garden. Parking for one car.

NOTE: Photos taken prior to current tenancy



Council Tax Band: B



Built in 2016, a one bedroom first floor apartment finished to a high standard and available unfurnished. Easy access to Oxford and the City Centre. Double Bedroom with fitted wardrobes. Shower room, Open plan style Living/Dining room/Kitchen - fully fitted with oven, gas hob, fridge/freezer, dishwasher and washer/dryer, Gas central heating, Communal garden. Parking for one car.

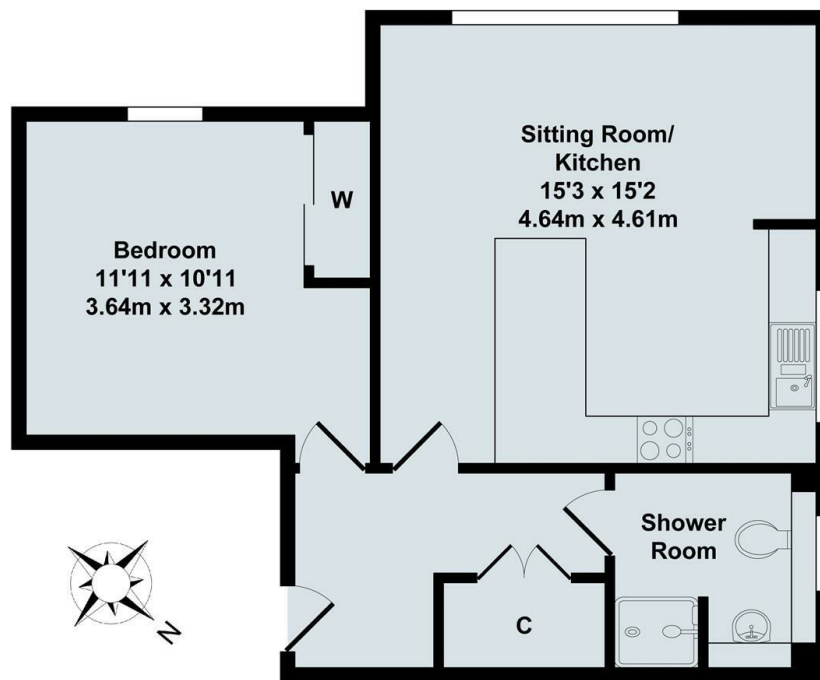

Total Approx. Floor Area 495 Sq.Ft. (46.0 Sq.M.)
All items illustrated on this plan are included in the "Total Approx Floor Area"

Directions

Viewings

Viewings by arrangement only. Call 01865 515900 to make an appointment.

Council Tax Band

B

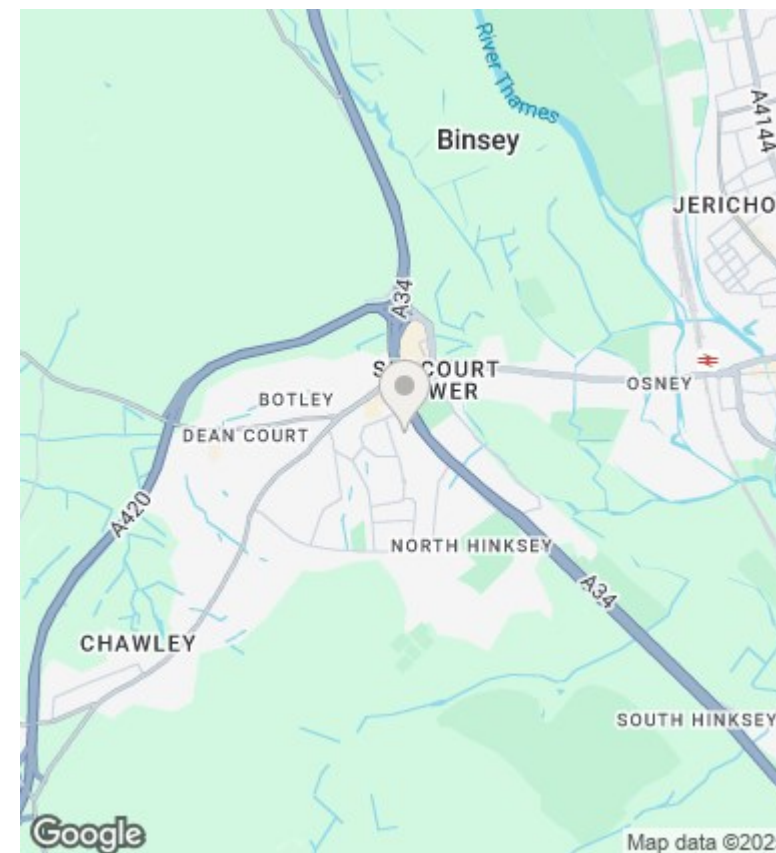

Energy Efficiency Rating		
	Current	Potential
Very energy efficient - lower running costs		
(92 plus) A		
(81-91) B	84	84
(69-80) C		
(55-68) D		
(39-54) E		
(21-38) F		
(1-20) G		
Not energy efficient - higher running costs		
England & Wales	EU Directive 2002/91/EC	