



## 25 Hometree House London Road, Bicester, OX26 6BP

£925 - 27th July 2024.

- One bedroom retirement flat for the over 60s only
- Refurbished kitchen and shower room
- Mains electricity and water
- Council Tax Band B
- Unfurnished
- Electric heating
- Use of car park on first come first served basis
- Lift
- Communal laundry room
- EPC rating B

Approximate Gross Internal Area 473 sq ft – 44 sq m

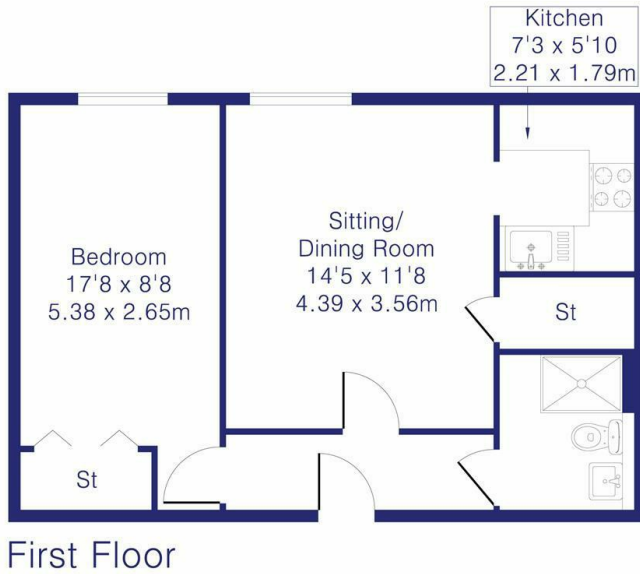

Although Pink Plan Ltd ensures the highest level of accuracy, measurements of doors, windows and rooms are approximate and no responsibility is taken for error, omission or misstatement. These plans are for representation purposes only as defined by RICS code of measuring practice. No guarantee is given on total square footage of the property within this plan. The figure icon is for initial guidance only and should not be relied on as a basis of valuation.

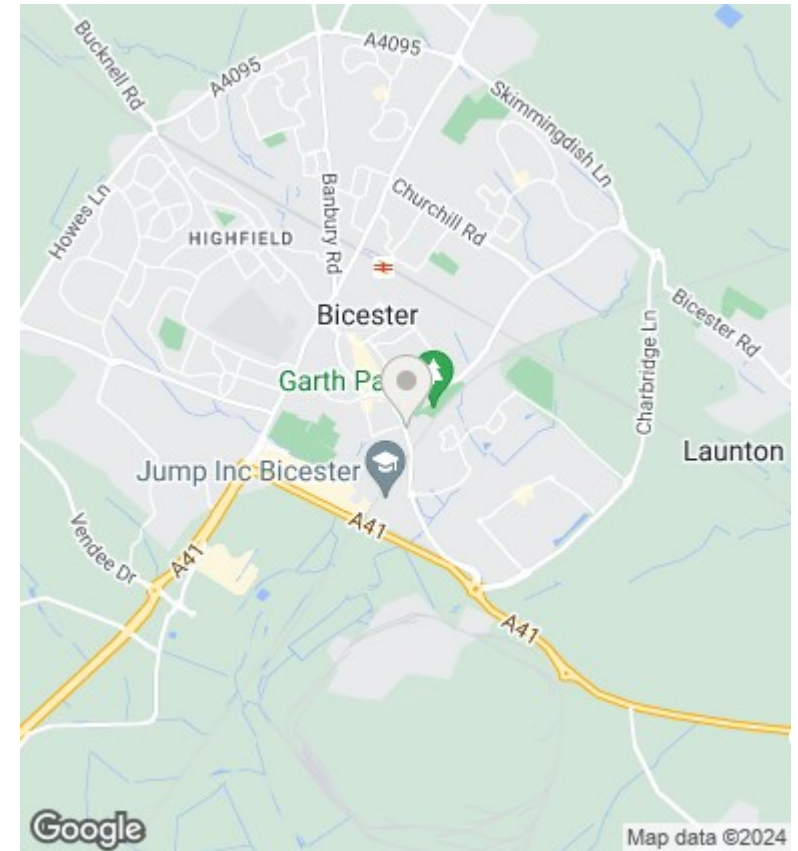

## Directions

## Viewings

Viewings by arrangement only. Call 01865 515900 to make an appointment.

## Council Tax Band

B

## EPC Rating:

B

Energy Efficiency Rating		Current	Potential
<i>Very energy efficient - lower running costs</i>			
(92 plus) <b>A</b>			
(81-91) <b>B</b>		86	86
(69-80) <b>C</b>			
(55-68) <b>D</b>			
(39-54) <b>E</b>			
(21-38) <b>F</b>			
(1-20) <b>G</b>			
<i>Not energy efficient - higher running costs</i>			
<b>England &amp; Wales</b>		EU Directive 2002/91/EC	