

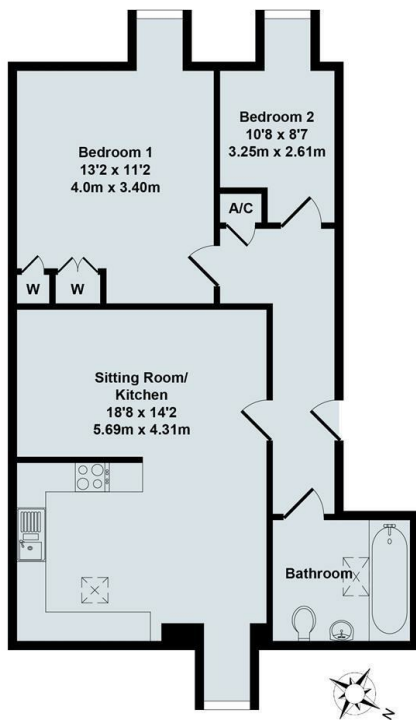

## 21 Bowood Court, Oxford Road, Kidlington, OX5 1FN

£1,400 PCM - 2nd August 2024.

- Two Bedroom Apartment
- Open Plan Living/Dining/Kitchen Area
- Allocated Parking for One Car
- Council Tax Band C
- Second Floor
- Whitegoods Included
- Mains gas, electric and water
- Available Unfurnished
- Gas Central Heating
- EPC Rating B



Total Approx. Floor Area 631 Sq.Ft. (58.60 Sq.M.)  
 All items illustrated on this plan are included in the "Total Approx Floor Area"

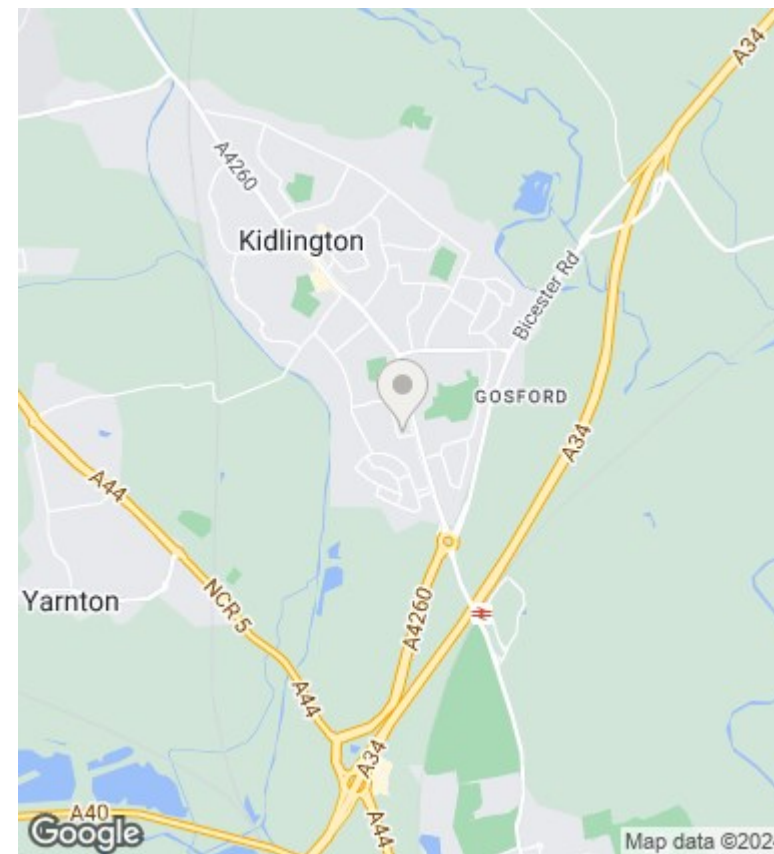

## Directions

## Viewings

Viewings by arrangement only. Call 01865 515900 to make an appointment.

## Council Tax Band

C

## EPC Rating:

Energy Efficiency Rating		Current	Potential
<i>Very energy efficient - lower running costs</i>			
(92 plus) <b>A</b>			
(81-91) <b>B</b>			
(69-80) <b>C</b>			
(55-68) <b>D</b>			
(39-54) <b>E</b>			
(21-38) <b>F</b>			
(1-20) <b>G</b>			
<i>Not energy efficient - higher running costs</i>			
<b>England &amp; Wales</b>		EU Directive 2002/91/EC	