

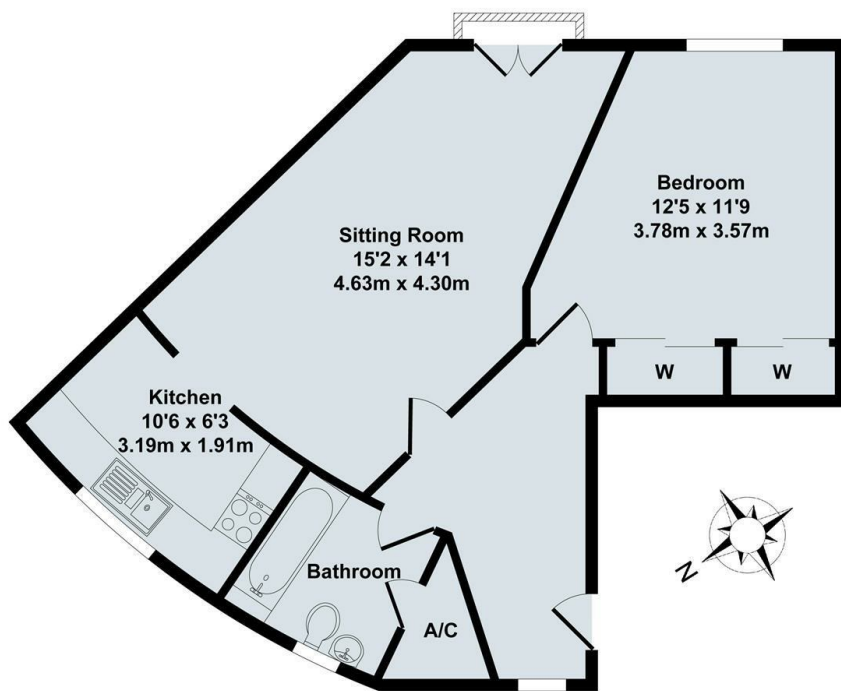

139 Heron Drive, Bicester, OX26 6YZ

£1,000 - 3rd August 2024.

- Second floor apartment
- Electric heating
- Allocated parking for 1 car
- Mains water and electricity
- One bedroom
- Juliette Balcony
- EPC rating C
- Unfurnished with white goods
- Communal garden
- Council Tax Band B



Total Approx. Floor Area 545 Sq.Ft. (50.60 Sq.M.)
 All items illustrated on this plan are included in the "Total Approx Floor Area"

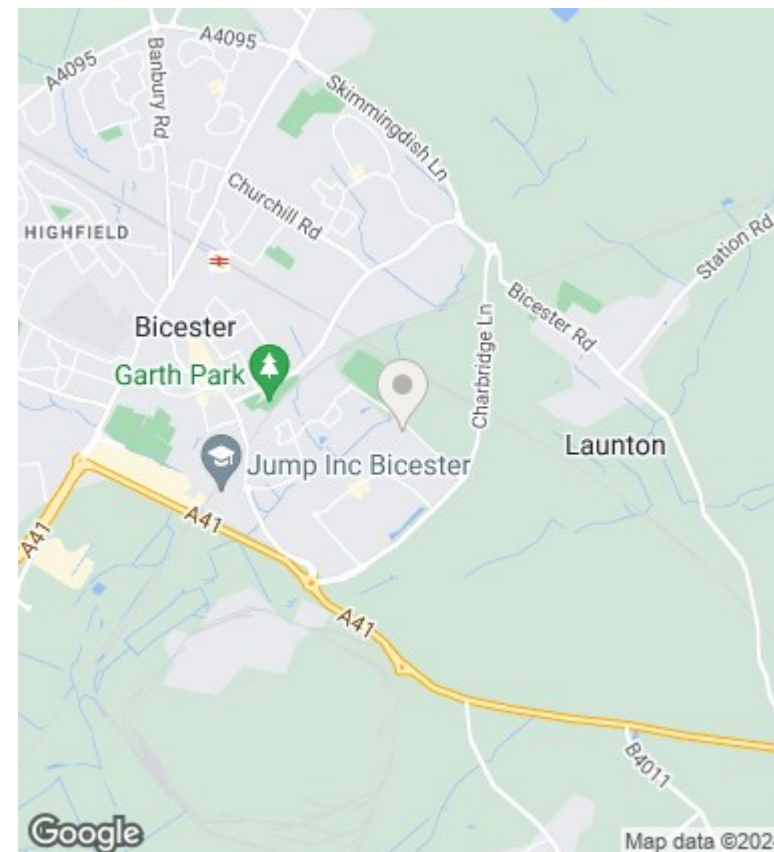

Directions

Viewings

Viewings by arrangement only. Call 01865 515900 to make an appointment.

Council Tax Band

B

EPC Rating:

C

Energy Efficiency Rating		Current	Potential
<i>Very energy efficient - lower running costs</i>			
(92 plus) A			
(81-91) B			
(69-80) C		71	72
(55-68) D			
(39-54) E			
(21-38) F			
(1-20) G			
<i>Not energy efficient - higher running costs</i>			
England & Wales		EU Directive 2002/91/EC	