

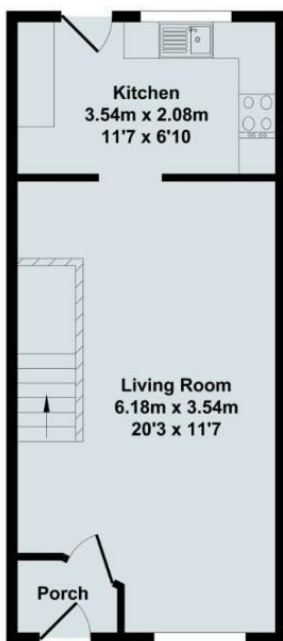

72 Wilsdon Way, Kidlington, Oxon, OX5 1TX

£1,400 PCM - 22nd July 2024.

- Two double bedrooms
- White goods included
- Parking behind property
- Mains gas, electricity and water
- Mid terrace
- Gas CH
- EPC rating C
- Unfurnished
- Rear garden with shed
- Council Tax Band C



Ground Floor
Approx. Floor Area 29.59 Sq.M. (319 Sq.Ft.)

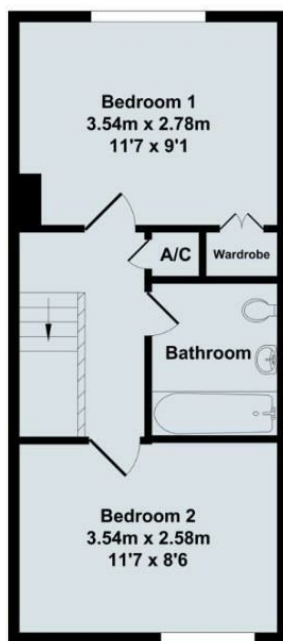

First Floor
Approx. Floor Area 29.59 Sq.M. (319 Sq.Ft.)

Total Approx. Floor Area 59.18 Sq.M. (637 Sq.Ft.)

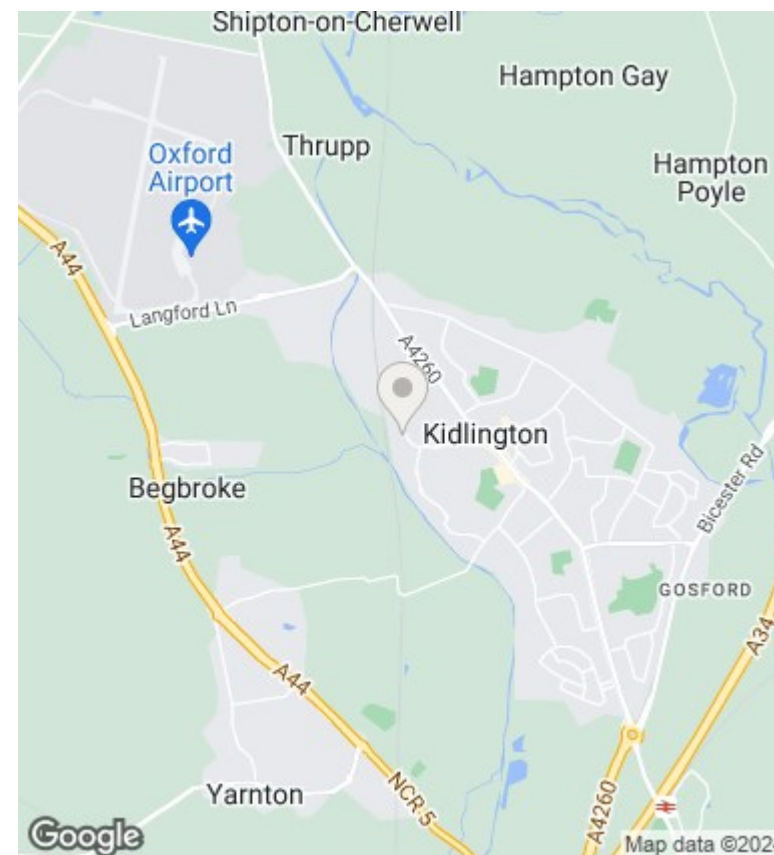

Directions

Viewings

Viewings by arrangement only. Call 01865 515900 to make an appointment.

Council Tax Band

C

EPC Rating:

C

Energy Efficiency Rating		Current	Potential
<i>Very energy efficient - lower running costs</i>			
(92 plus) A			91
(81-91) B		77	
(69-80) C			
(55-68) D			
(39-54) E			
(21-38) F			
(1-20) G			
<i>Not energy efficient - higher running costs</i>			
England & Wales		EU Directive 2002/91/EC	