

Brennan Ayre O'Neill

Estate Agents | Surveyors | Property Managers

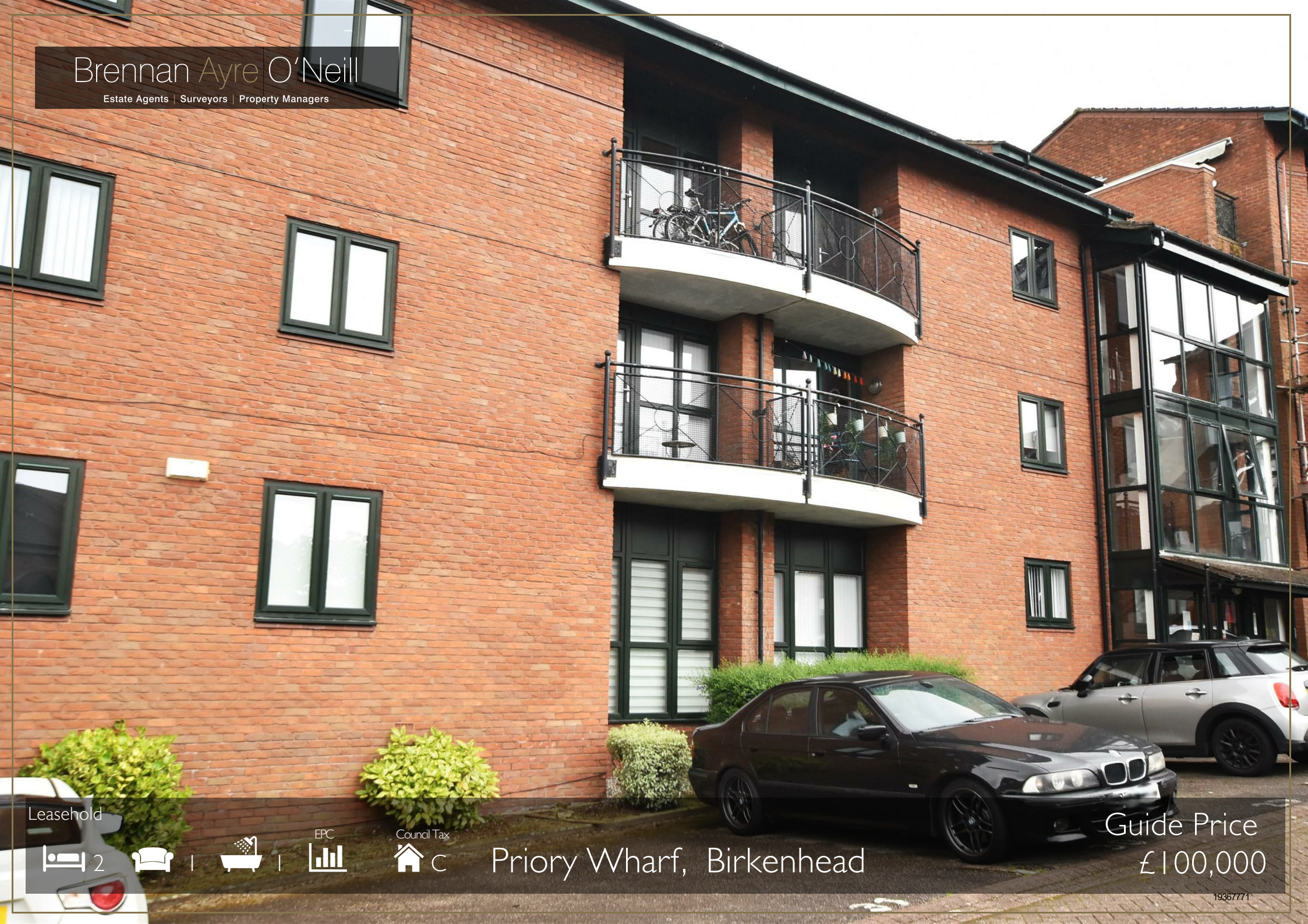

Leasehold

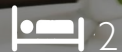

Priory Wharf, Birkenhead

Guide Price
£100,000

This is a second floor apartment with front and rear facing balconies - and with a glimpse of the river eastward from the rear bedroom balcony as you take morning coffee from its south east orientation....A vacant apartment with two bedrooms, a combined bathroom and a living room with open plan kitchen within a separate area. The communal areas are smart and refurbished over recent years making a welcoming entrance. There is dedicated parking and visitor parking too.

Walk around behind this development and enjoy access to the water front a few minutes stroll away. For business and pleasure the station is a ten minute walk at most to jump the train for Liverpool. For directions please Sat Nav: CH41 5LB

Tenure

This apartment has a long lease of 999 years from 1990. A fixed ground rent of £50 per annum applies. Current service charges are £1,866.36 per annum. Managing agents are Keppie Massey







Floor Plan

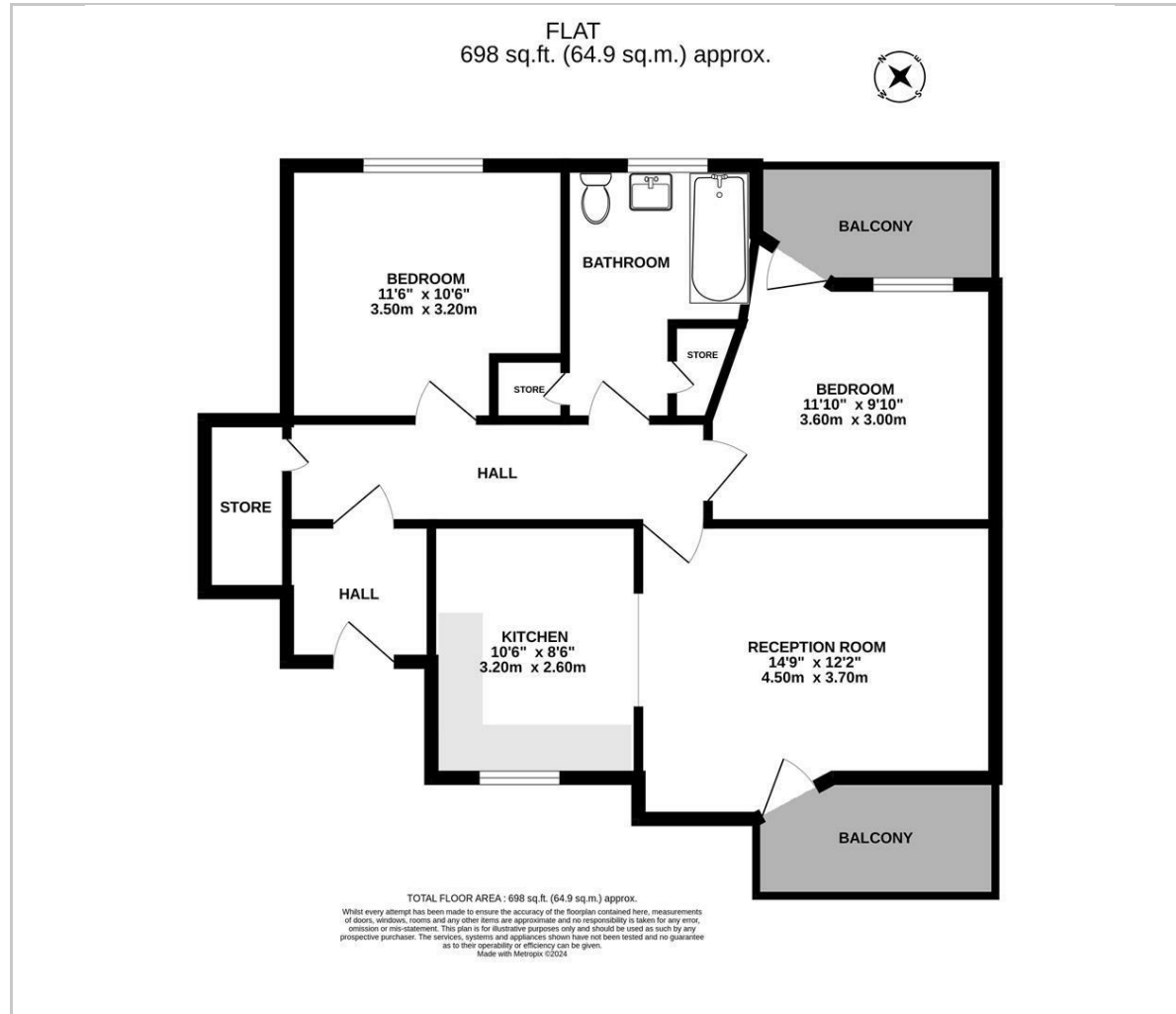

Viewing

Please contact our Brennan Ayre O'Neill - Prenton Office on 0151 608 8586 if you wish to arrange a viewing appointment for this property or require further information.

These particulars, whilst believed to be accurate are set out as a general outline only for guidance and do not constitute any part of an offer or contract. Intending purchasers should not rely on them as statements of representation of fact, but must satisfy themselves by inspection or otherwise as to their accuracy. No person in this firm's employment has the authority to make or give any representation or warranty in respect of the property.

Brennan Ayre O'Neill

Estate Agents | Surveyors | Property Managers

377 Woodchurch Road, Prenton, Wirral,

Tel: 0151 608 8586

Email: prenton@b-a-o.com

www.b-a-o.com



19367771