



Broomfield, Guildford, GU2 8LQ

£375,000

*** NO ONWARD CHAIN**** A well presented two-bedroom semi-detached house ideally situated in a quiet residential area of Guildford. This delightful home offers an ideal opportunity for first-time buyers, young professionals, or those looking to downsize.



Description

*** NO ONWARD CHAIN**** A well presented two-bedroom semi-detached house ideally situated in a quiet residential area of Guildford. This delightful home offers an ideal opportunity for first-time buyers, young professionals, or those looking to downsize.

The property boasts a spacious living room filled with natural light, and fitted kitchen with ample storage. Upstairs, you'll find two well-proportioned bedrooms, including a generous master, and a family bathroom.

Outside, the property features a large private rear garden, ideal for relaxing or al fresco dining and offering the possibility to extend (subject to planning permission). Located within easy reach of Guildford town centre, excellent local schools, and mainline stations, this home offers both convenience and comfort.

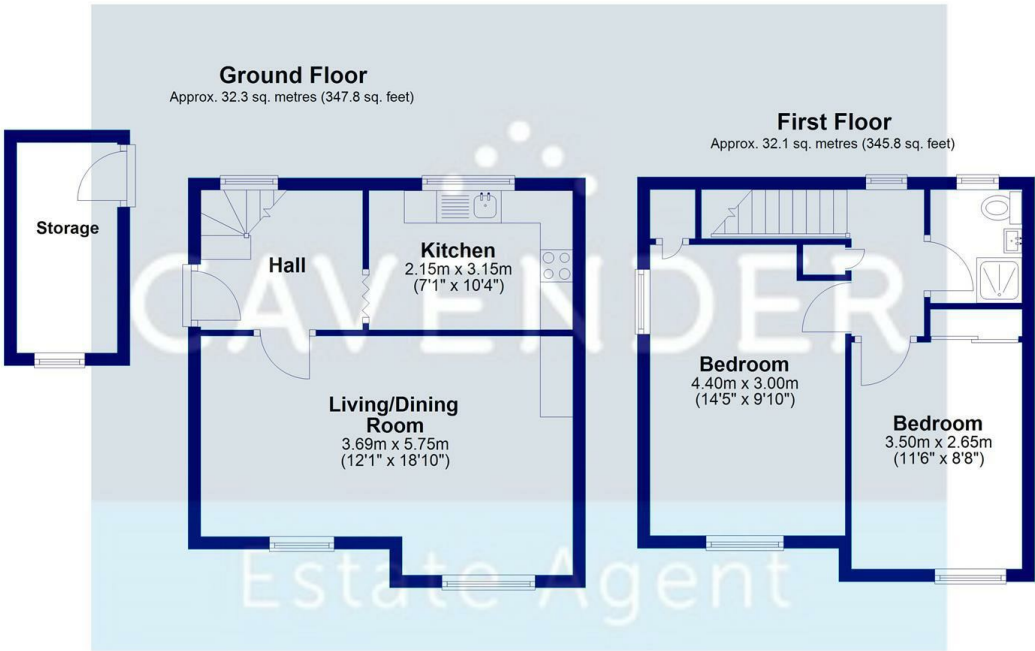

Total area: approx. 64.4 sq. metres (693.6 sq. feet)

