

Alexander Bond & Company

Estate Agents | Property Management



448 Canterbury Way, Stevenage, SG1 4EA

£950 PCM





448 Canterbury Way

Stevenage, SG1 4EA

- Six Month Tenancy
- One Double Bedroom
- Gas Central Heating
- Modern Bathroom
- Lots of Storage Space
- Spacious Apartment
- Ground Floor Position
- Fitted Kitchen
- Spacious Lounge
- NO PETS

A generously sized one-bedroom ground floor apartment, available for a 6 month tenancy. The accommodation includes an entrance hall, a spacious lounge/dining area, a fitted kitchen, bathroom, and ample built-in storage. Additional benefits include gas central heating via radiators and double glazing throughout. Externally, the property enjoys access to communal gardens, with parking available nearby. The apartment is available from May 2025. No pets permitted.



ENTRANCE HALL

LOUNGE

14'2" x 11'2" (4.32 x 3.40)

KITCHEN

8'5" x 8'4" (2.57 x 2.54)

BEDROOM

11'2" x 8'7" x 11'5" (3.40 x 2.62 x 3.48)

BATHROOM

OUTSIDE





Directions



Floor Plans

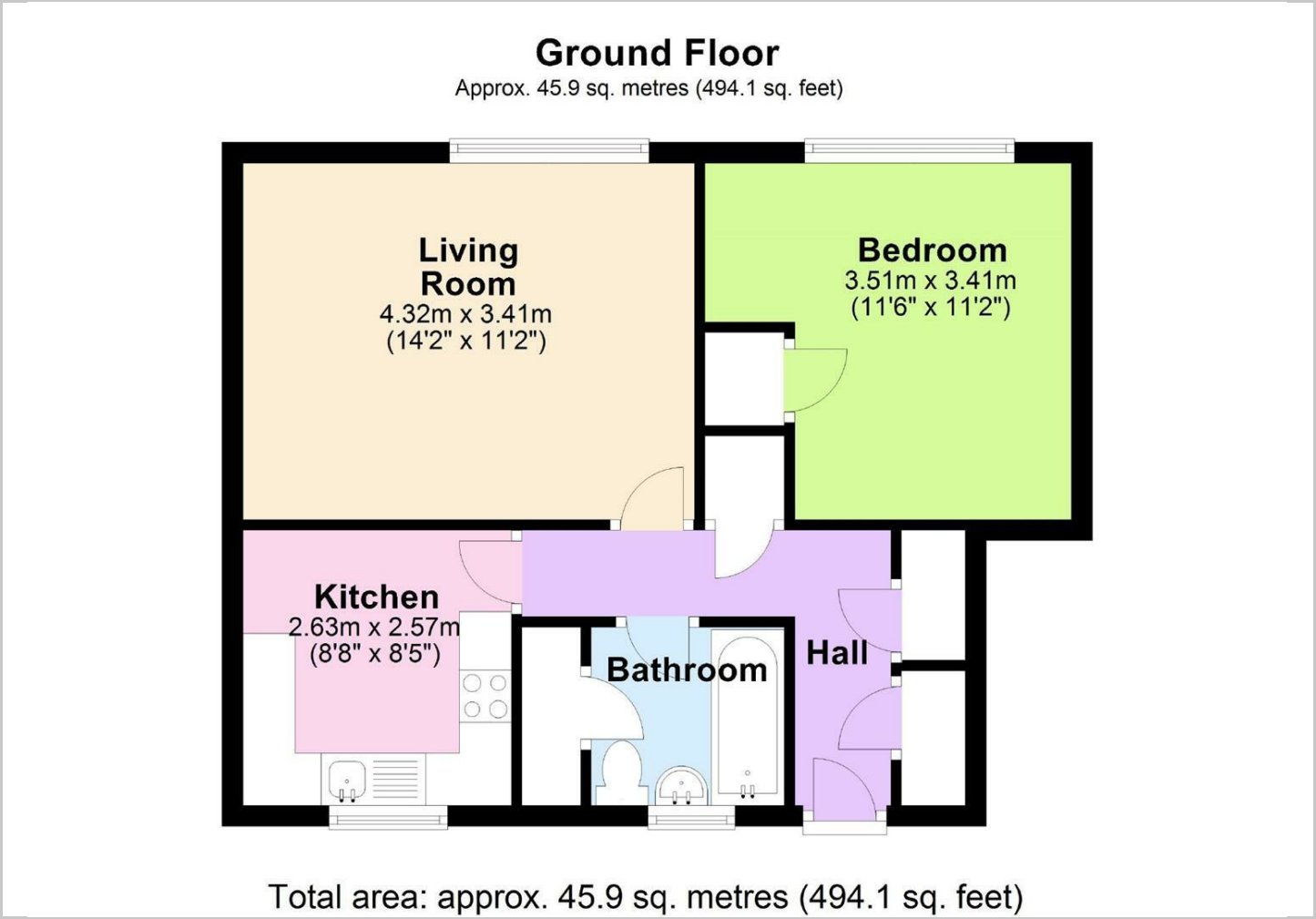

Viewing

Please contact our Lettings Office on 01438 811511 if you wish to arrange a viewing appointment for this property or require further information.

The particulars are set out as a general outline only for the guidance of intended purchasers or lessees, and do not constitute, any part of a contract. Nothing in these particulars shall be deemed to be a statement that the property is in good structural condition or otherwise nor that any of the services, appliances, equipment or facilities are in good working order. Purchasers should satisfy themselves of this prior to purchasing.

Location Map

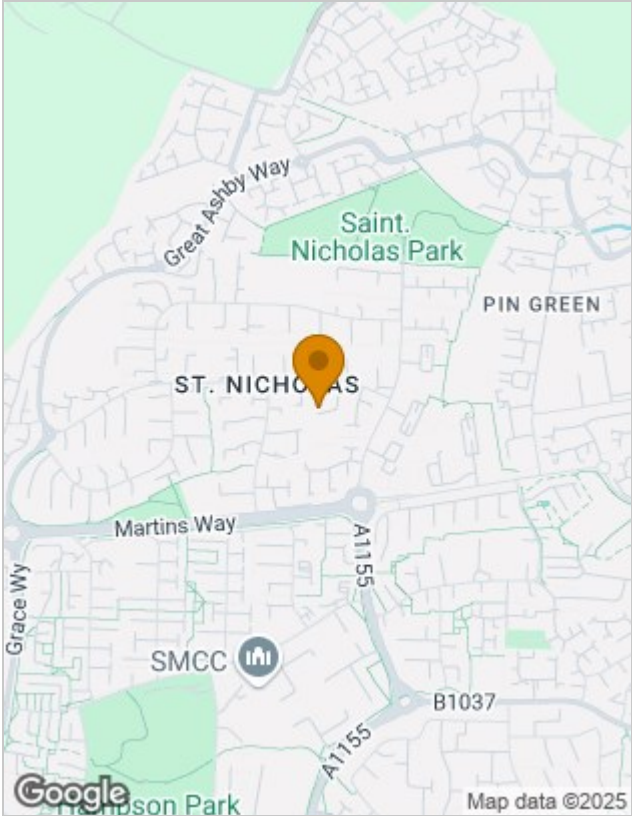

Energy Performance Graph

