

These particulars, whilst believed to be accurate are set out as a general outline only for guidance and do not constitute any part of an offer or contract. Intending purchasers should not rely on them as statements of representation of fact, but must satisfy themselves by inspection or otherwise as to their accuracy. No person in this firm's employment has the authority to make or give any representation or warranty in respect of the property.

Please contact our Nuneaton Office on 02476 388863
 if you wish to arrange a viewing appointment for this property or require further information.

For Illustrative Purposes Only.

Not to Scale. Produced by The Plan Portal 2024

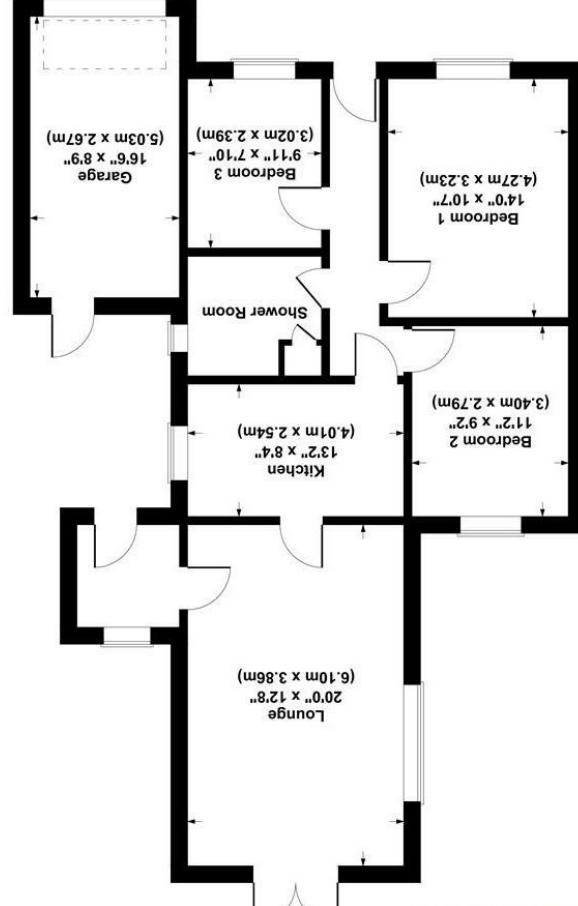

Stonewell Cres
 Approximate Area = 1023 sq ft / 95 sq m

Floor Plan

Energy Efficiency Rating	
Current	Potential
79	41

Energy Efficiency Graph

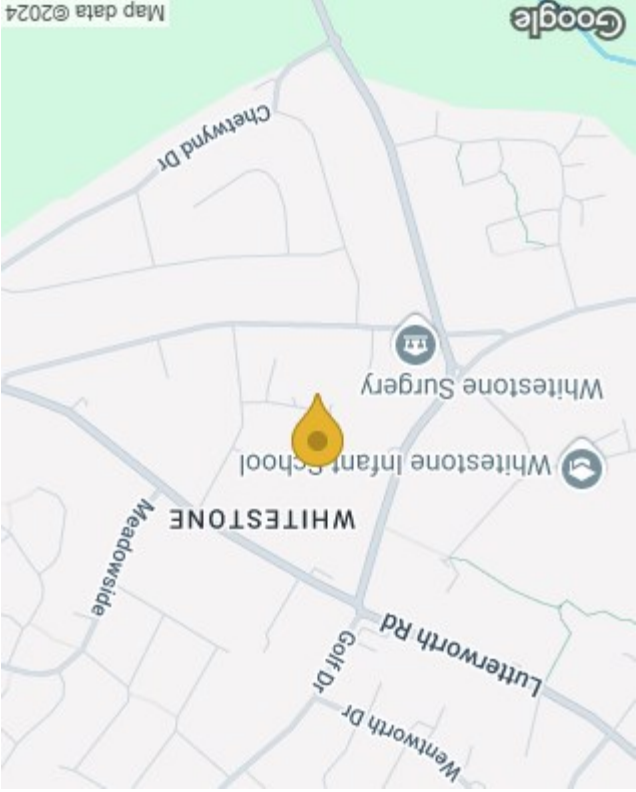

Area Map

DOUNCIL TAX



94 Stonewell Crescent
 Nuneaton, CV11 4TB
 £367,500

3
 1
 1
 E
 COUNCIL TAX BAND

94 Stonewell Crescent

Nuneaton, CV11 4TB

****NO UPWARD CHAIN**THREE BEDROOMS**EXTENDED****

Carters are very pleased to offer this beautifully presented three-bedroom detached bungalow, situated in the highly sought-after location of Whitestone. Conveniently close to local amenities and the A444, providing excellent links to the Midlands, this property is ideal for those seeking a well-connected yet peaceful residence.

Offered with the significant advantage of no upward chain, this bungalow occupies a generous plot. The accommodation briefly comprises an inviting entrance hall, three well-proportioned bedrooms, a modern shower room, a fitted kitchen, and a spacious lounge with elegant double French-style doors leading to the rear verandah.

Outside, the property impresses with a large frontage laid to lawn, complemented by a tarmac driveway leading to a parking area and garage, providing ample parking space for numerous vehicles.

The rear of the property features a stunning garden, showcasing two paved patios, a charming timber verandah, and a meticulously maintained lawn bordered by an array of vibrant plants and shrubs.



This beautiful outdoor space is perfect for relaxation, entertaining, and enjoying the outdoors.

With its prime location and the benefit of no upward chain, this property is expected to be highly sought after. Don't miss the opportunity to make this delightful bungalow your new home. Book your viewing today to experience the exceptional potential and charm this property has to offer.

