



CARTERS
ESTATE AGENTS



26 Barleyfield Road

Nuneaton, CV10 0FP

£270,000



****GREAT LOCATION**MODERN VERSTILE LIVING****

Carters are delighted to present this well presented and recently built three bedroom semi detached family home, nestled in a modern development close to local amenities and with excellent transport links, including the A5, facilitating easy commuting to the Midlands.

This contemporary property makes it an ideal choice for first-time buyers or young families seeking a versatile, modern lifestyle with all the conveniences of a new build.

The well appointed accommodation comprises a welcoming entrance hall, a cosy lounge, and a convenient guest cloakroom/WC. The highlight of the home is the stunning open-plan kitchen/diner, featuring a range of sleek, modern units with contrasting work surfaces. Double French doors open onto the rear patio, effortlessly blending indoor and outdoor living spaces, perfect for entertaining guests or enjoying family time.



Area Map



Floor Plans

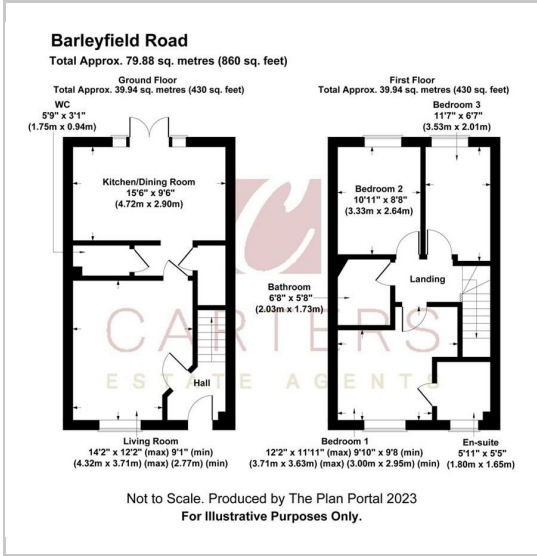
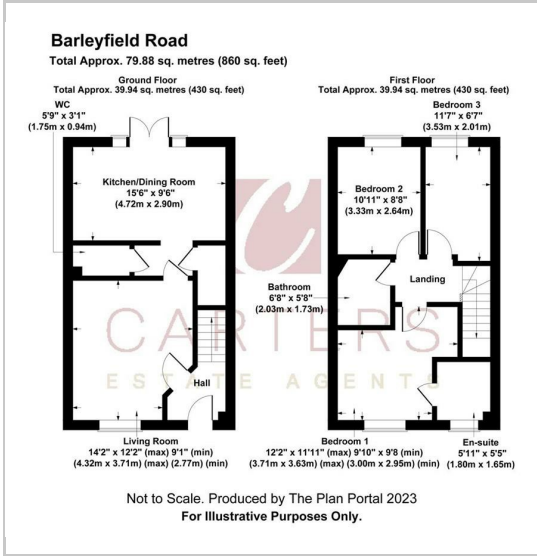

Energy Efficiency Graph

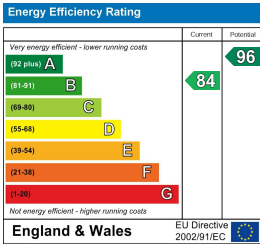

These particulars, whilst believed to be accurate are set out as a general outline only for guidance and do not constitute any part of an offer or contract. Intending purchasers should not rely on them as statements of representation of fact, but must satisfy themselves by inspection or otherwise as to their accuracy. No person in this firms employment has the authority to make or give any representation or warranty in respect of the property.