



CARTERS
ESTATE AGENTS



18 Sunningdale Close

Warwickshire, CV11 6NB

£1,100 PCM



A well presented and recently decorated 3 bed mid terraced house located in the popular Whitestone area of Nuneaton. The property benefits from double glazing and electric heating and briefly comprises: entrance porch; open plan lounge/diner with feature fireplace with gas fire; stairs leading to the first floor and doors to the sun room; newly fitted kitchen with a range of matching base and wall units and freestanding electric oven; sun room with patio doors leading to the rear garden. To the first floor there are three bedrooms, two with built in storage and the family bathroom with white suite & shower over the bath.

Externally there is a mature garden to the front of the property and an enclosed low maintenance garden to the rear. The rear garden is accessed via a communal gated walkway. There is a detached garage at the rear of the property.

No pets. Council tax band B. EPC rating E.

RENT £1100.00 PCM ** HOLDING DEPOSIT £253.00 ** SECURITY DEPOSIT £1269.00



Area Map



Floor Plans

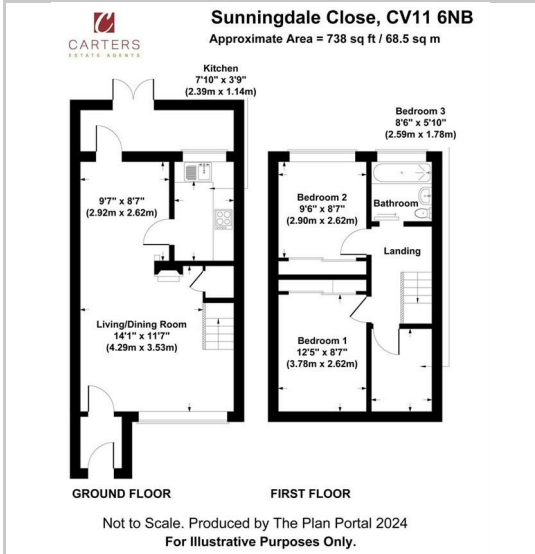
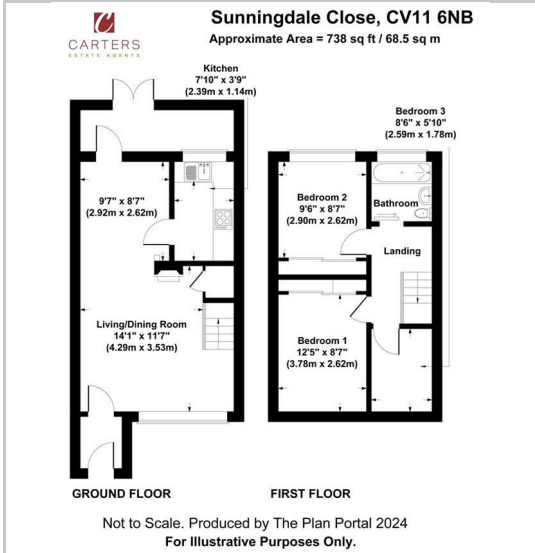

Energy Efficiency Graph

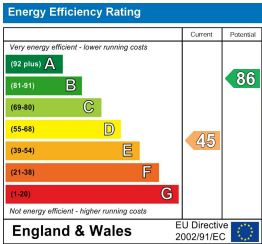

These particulars, whilst believed to be accurate are set out as a general outline only for guidance and do not constitute any part of an offer or contract. Intending purchasers should not rely on them as statements of representation of fact, but must satisfy themselves by inspection or otherwise as to their accuracy. No person in this firm's employment has the authority to make or give any representation or warranty in respect of the property.