



CARTERS  
ESTATE AGENTS



## Plot 3 Hillside Drive

Nuneaton, CV10 0LF

Asking Price £275,000



\*LAST PLOT REMAINING\* \*CORNER PLOT 3\*

\*LEGAL & VALUATION FEES COVERED TO RESIDENTIAL PURCHASERS\*

An exclusive development of superbly designed detached new homes located in a desirable location with convenient access to the Nuneaton town centre and within easy reach of major rail and road network links. These generous well-planned properties offer well thought out living accommodation, come with a 10 year new build warranty and are finished to a high specification throughout. Benefiting from fantastic views to the rear of the properties with viewing highly advised to appreciate. The property is finished to a high standard and is fully carpeted and with Amtico flooring, along with upgraded power showers and integrated appliances. Externally there are also outside taps and electric points.

This plot is 'show home ready' and available to purchase and move into immediately. The other plots on the development are also available, with the developers offering significant customisation on fixtures and fittings.



\*LEGAL & VALUATION FEE SUBJECT TO SELLER APPROVAL PRIOR TO PURCHASE\* \*ONLY AVAILABLE TO RESIDENTIAL HOME BUYERS, NOT INVESTORS\*

## Area Map



## Floor Plans

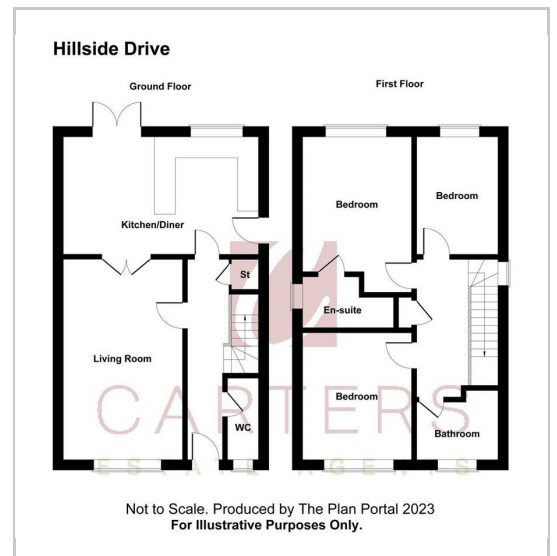
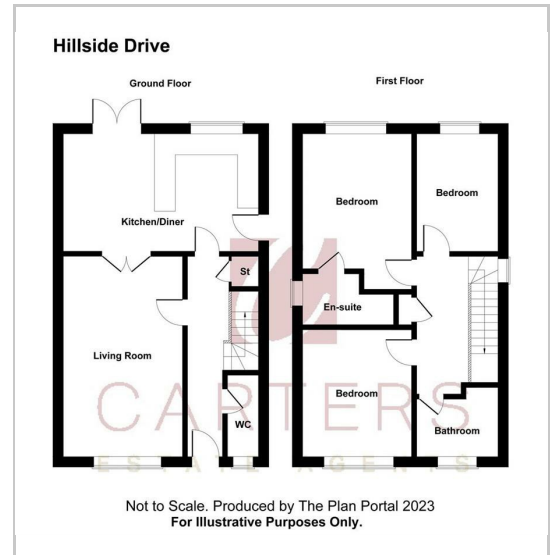

## Energy Efficiency Graph

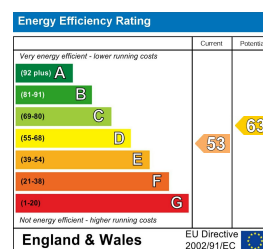

These particulars, whilst believed to be accurate are set out as a general outline only for guidance and do not constitute any part of an offer or contract. Intending purchasers should not rely on them as statements of representation of fact, but must satisfy themselves by inspection or otherwise as to their accuracy. No person in this firm's employment has the authority to make or give any representation or warranty in respect of the property.