



CARTERS
ESTATE AGENTS



6 Ash Croft

Atherstone, CV9 3RY

£1,500 Per Calendar Month



A brilliant 3 bedroom detached house situated in the little village of Sheepy Magna in Atherstone. The property benefits from gas central heating, double glazing & driveway leading to garage. Inside comprises of a spacious living room/dining area with patio doors leading to the rear; kitchen with a range of matching fitted base and wall units including integrated fridge, microwave, dishwasher and double oven with extractor; a utility room with direct access to the garage and large rear garden. To the first floor there are three bedrooms; main bedroom with fitted wardrobes, a family bathroom and a separate w/c. Pets considered.

EPC Rating - C. Council Tax Band - D.

Rent £1500.00 PCM *Holding Deposit £346.00* *Security Deposit £1730.00*



Area Map



Floor Plans

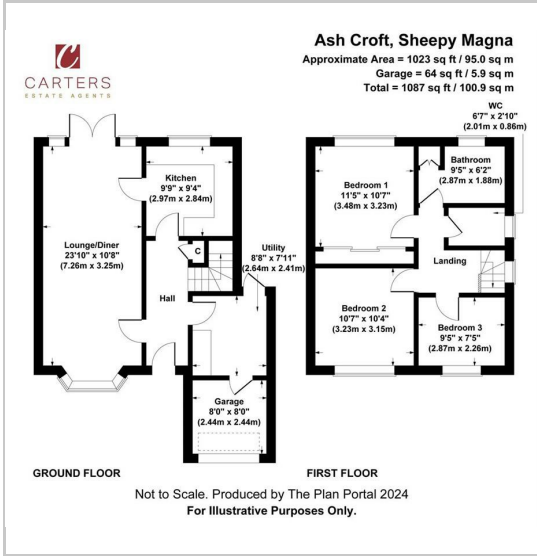
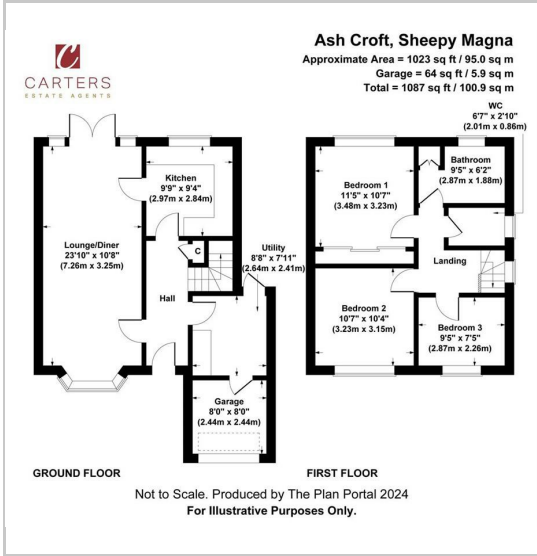

Energy Efficiency Graph

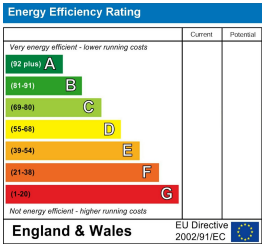

These particulars, whilst believed to be accurate are set out as a general outline only for guidance and do not constitute any part of an offer or contract. Intending purchasers should not rely on them as statements of representation of fact, but must satisfy themselves by inspection or otherwise as to their accuracy. No person in this firm's employment has the authority to make or give any representation or warranty in respect of the property.