

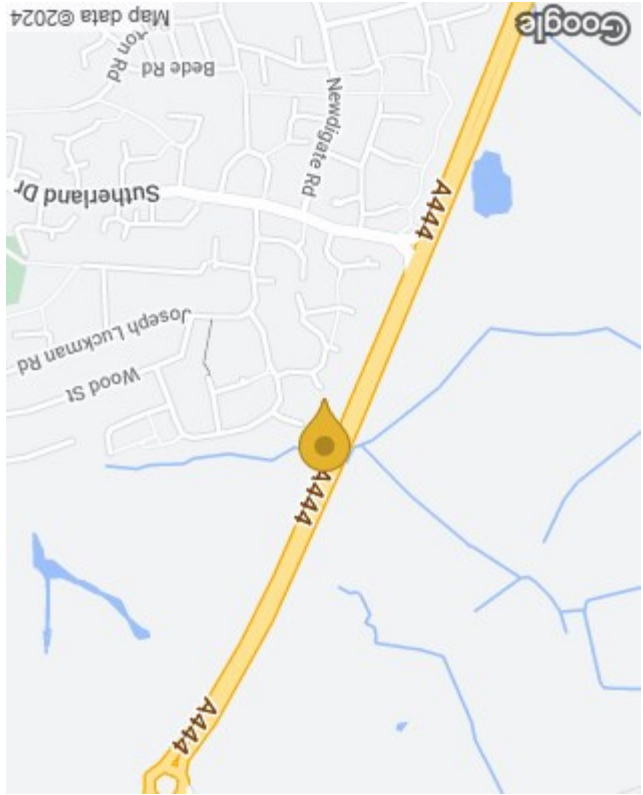

10 Gainsborough Drive
 Bedworth, CV12 8DB
 £1,150 PCM

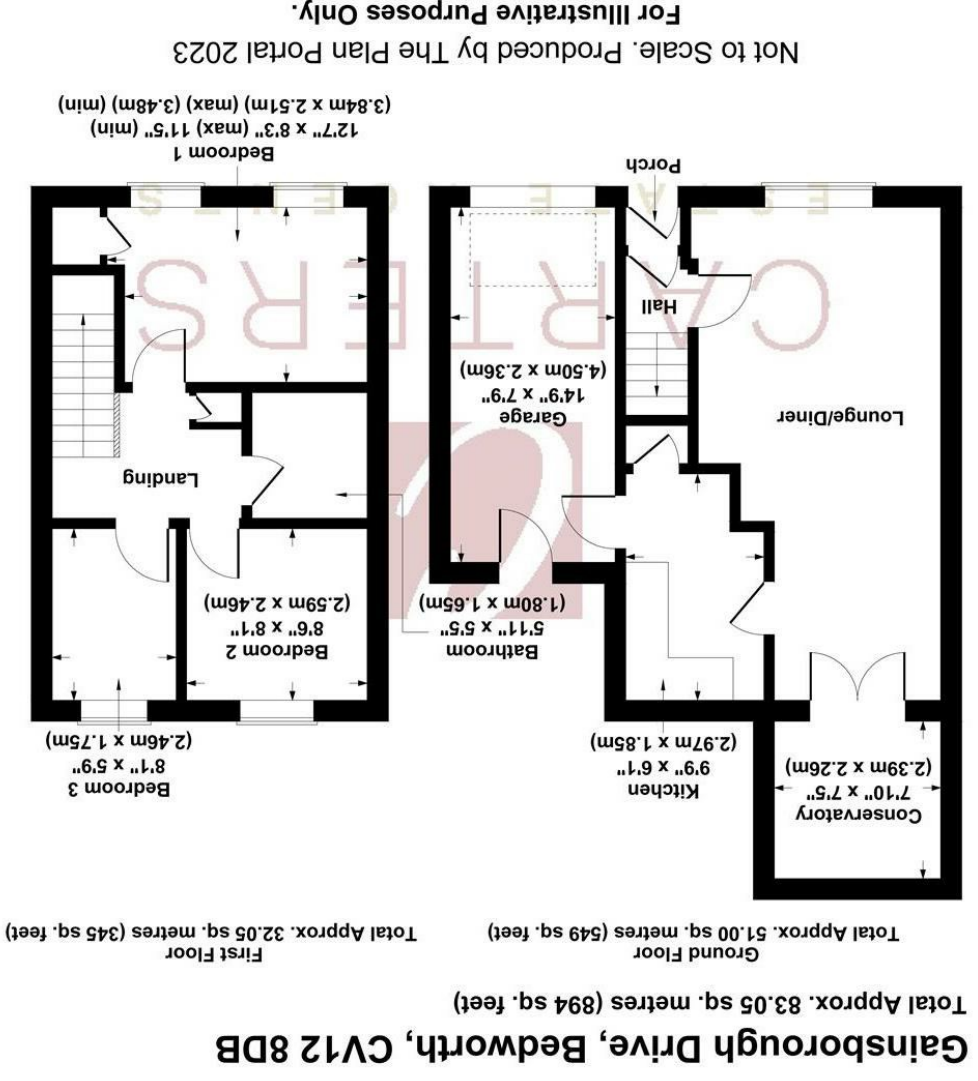

Floor Plan



Energy Efficiency Graph

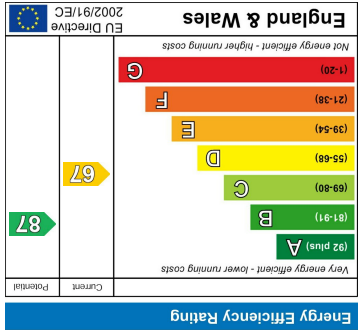

10 Gainsborough Drive

Bedworth, CV12 8DB

A well presented 3 bedroom link detached house located in this sought after area of Bedworth and providing easy access to Bedworth town centre and the local transport network. The property benefits from gas central heating, double glazing and house alarm and briefly comprises: entrance porch leading to a hallway with stairs to the first floor; dual aspect lounge/diner with double doors leading to the conservatory; modern fitted kitchen with a range of matching base and wall units, built in oven, hob & extractor and plumbing for a washing machine, built in storage cupboard and access to the integral garage which benefits from electric doors. To the first floor there are three bedrooms & the family bathroom with white suite, jacuzzi bath and shower over the bath. Externally there is a driveway and garden to the front of the property and an enclosed low maintenance garden to the rear. Pets considered. Council tax band C. EPC rating D.

****RENT £1150.00 ** HOLDING DEPOSIT £265.00** SECURITY DEPOSIT £1326.00****



Referencing Information

Prospective tenants will be required to complete a credit referencing application upon payment of a holding deposit equivalent to one weeks rent. Should your reference check be successful we will refund your holding deposit unless you wish to utilise it towards your first month's rent. Upon successful completion of referencing, one month's rent in advance and a security deposit equivalent to five weeks rent will be payable.