



DavidJames
the estate agent

Hatherleigh Close, Mapperley Plains, Nottingham, NG3 5SF

£850 Per Calendar Month



About This Property

A well-presented end-terrace house situated in a quiet cul-de-sac in a sought-after location. The property boasts a spacious living room and a kitchen with an integrated oven, hob, and extractor fan. Upstairs, there are two bedrooms and a bathroom/WC fitted with a white suite and a shower over the bath. Externally, the garden is thoughtfully arranged with a small lawn, decking area for outdoor dining, and a raised gravel bed, offering low-maintenance outdoor space. An off-street parking space is located at the rear of the property, while ample on-street parking is also available to the front, providing convenient access for residents and visitors alike. Set in a peaceful residential area with excellent local amenities and transport links nearby, this is a superb home not to be missed.

TENANCY DETAILS

Available From: 16th June 2025

Tenancy Term: Minimum 6 months

Furnishing: Unfurnished

EPC Rating: C

Council Band: B

Pets: Not permitted

- Well-presented end-terrace house
- Two bedrooms
- Spacious living room
- Kitchen with integrated oven, hob & extractor
- Bathroom/Wc with white suite & shower over bath
- UPVC double glazed windows
- Gas central heating
- Garden with small lawn area, decking and raised gravel bed
- Off-street parking space to the rear and on-street parking to the front of the property
- Quiet cul-de-sac location just off Spring Lane





Ground Floor
Approx. 26.6 sq. metres (286.4 sq. feet)

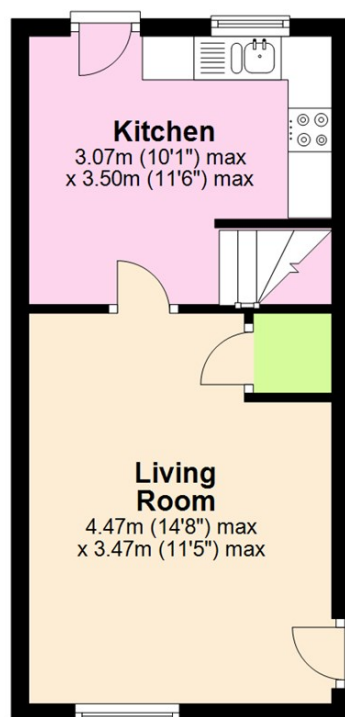

First Floor
Approx. 26.9 sq. metres (289.5 sq. feet)

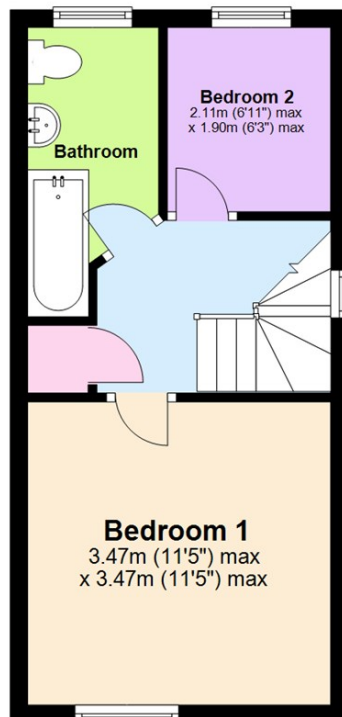

Total area: approx. 53.5 sq. metres (575.9 sq. feet)

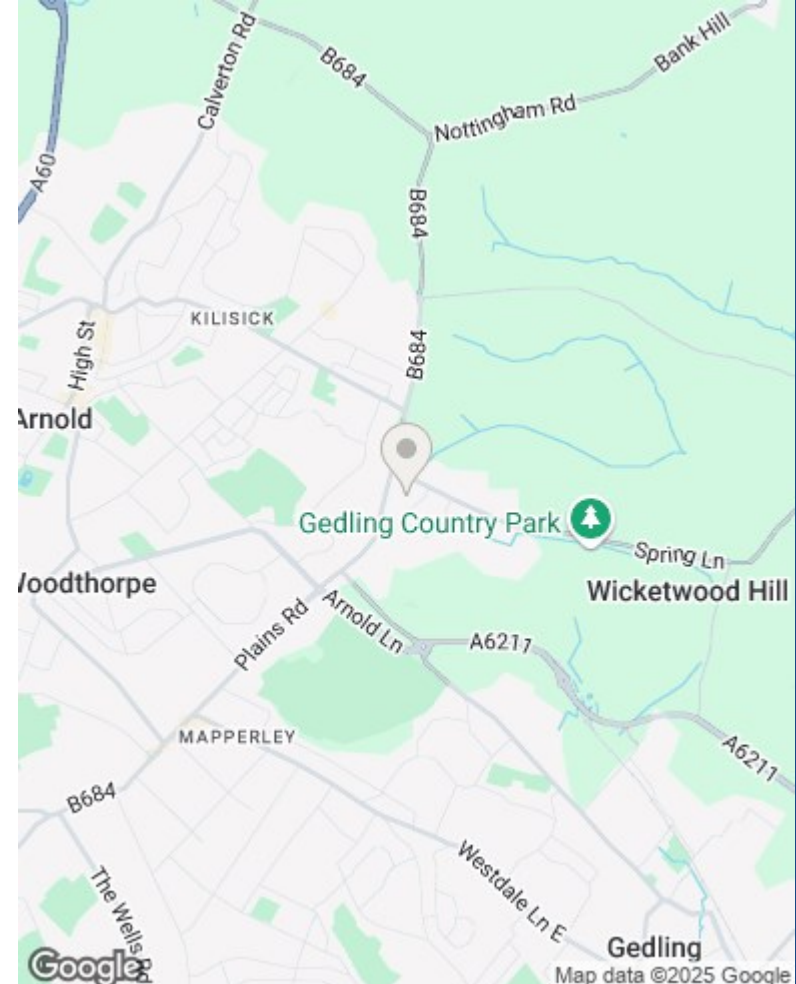

Council Tax Band: B
Gedling Borough Council

These particulars are produced in good faith, are set out as a general guide only and do not constitute any part of a contract. No person in the employment of David James Estate Agents Ltd has any authority to make any representation whatsoever in relation to the property. All services, together with electrical fittings or fitted appliances have NOT been tested. All the measurements given in the details are approximate. Floor plans are for illustrative purposes only and are not drawn to scale. The position and size of doors, windows, appliances and other features are approximate only. The photographs of this property have been taken with a 10mm wide-angle lens. No responsibility can be accepted for any loss or expense incurred in viewing. If you have a property to sell you may wish to take advantage of our free valuation service. David James Estate Agents have established professional relationships with third-party suppliers for the provision of services to Clients. As remuneration for this professional relationship, the agent receives referral commission from the third-party company. David James Estate Agents receives the following commission from each third party supplier on a per referral basis: W A Barnes Ltd: £60 including VAT. All Moves UK Ltd: 18% including VAT of the invoice total (£107 including VAT average). MoveWithUs Limited: £188 including VAT (average).

DavidJames
the estate agent

David James Estate Agents
45b Plains Road, Mapperley, Nottingham, NG3 5JU
t: 0115 962 4213 e: lettings@david-james.com

naea | propertymark
PROTECTED

**The Property
Ombudsman**