



3



1



1



E

DavidJames
the estate agent

Manvers Street, Netherfield, NG4 2HJ

£975 Per Calendar Month

About This Property

A recently refurbished three-storey mid-terraced house situated in a convenient location with easy access to local amenities, excellent transport links, and a welcoming community atmosphere. On the ground floor, you will find a cosy living room with feature fireplace, a well-appointed kitchen with appliances, while a modern three-piece bathroom/WC with white suite and two-way mains shower completes this floor. The first floor comprises two generously sized double bedrooms and there is a further spacious double bedroom filled with natural light on the second floor. Outside, there's an enclosed, low-maintenance rear garden with a decked seating area and a fence-panelled boundary with gated access, adding both privacy and security.

TENANCY DETAILS

Available From: NOW

Tenancy Term: Minimum 12 months

Furnishing: Unfurnished

EPC Rating: E

Council Band: A

Pets: Considered with rent increase

- Recently refurbished mid-terrace house
- Three bedrooms across the first and second floors
- Living room with feature fireplace
- Contemporary kitchen/diner with appliances
- Modern ground floor bathroom/WC with white suite & two-way mains shower
- UPVC double glazing
- Gas central heating
- Enclosed rear garden with decking area
- Close to excellent transport links and amenities





Ground Floor

Approx. 38.7 sq. metres (416.1 sq. feet)

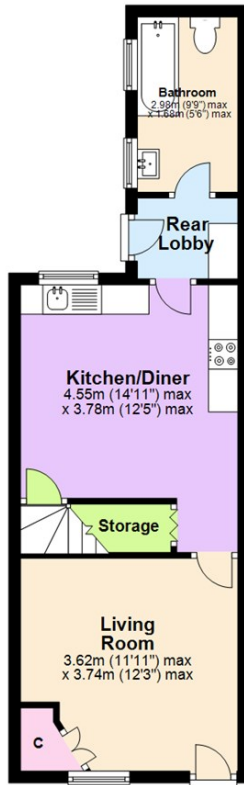

First Floor

Approx. 31.7 sq. metres (341.2 sq. feet)

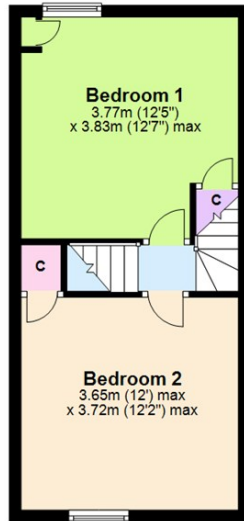

Second Floor

Approx. 24.4 sq. metres (262.4 sq. feet)

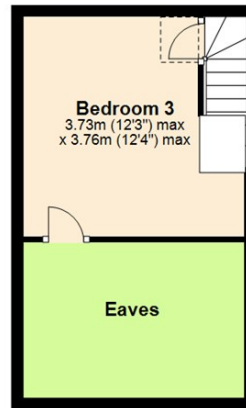

Total area: approx. 94.7 sq. metres (1019.8 sq. feet)

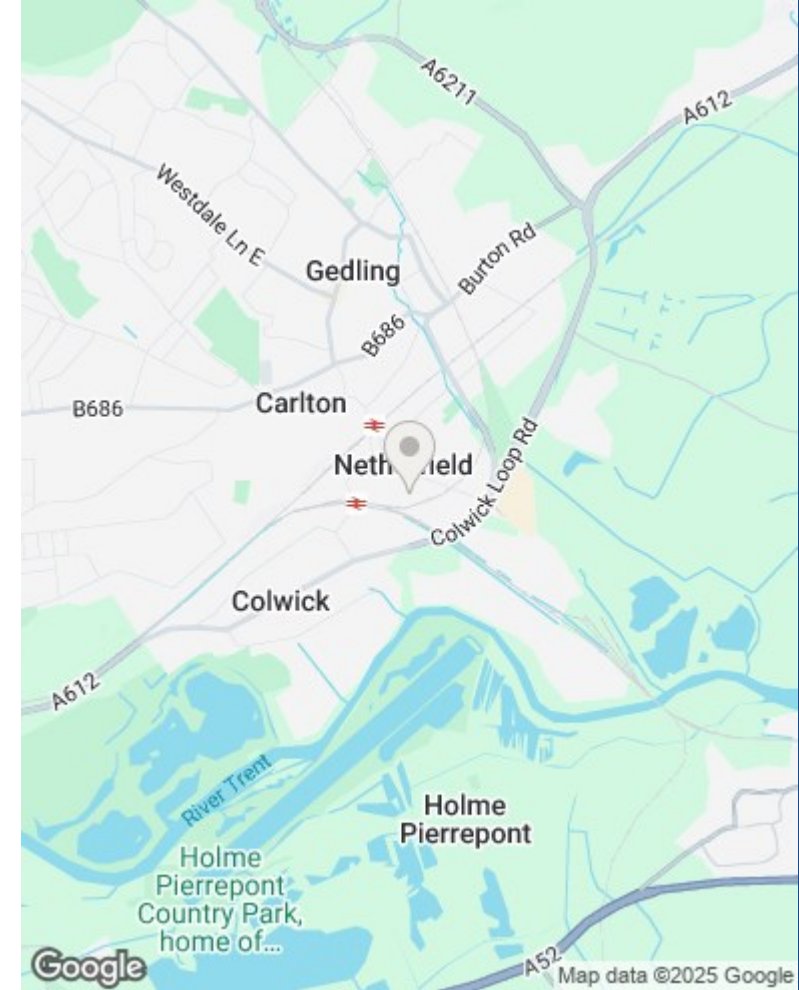

These particulars are produced in good faith, are set out as a general guide only and do not constitute any part of a contract. No person in the employment of David James Estate Agents Ltd has any authority to make any representation whatsoever in relation to the property. All services, together with electrical fittings or fitted appliances have NOT been tested. All the measurements given in the details are approximate. Floor plans are for illustrative purposes only and are not drawn to scale. The position and size of doors, windows, appliances and other features are approximate only. The photographs of this property have been taken with a 10mm wide-angle lens. No responsibility can be accepted for any loss or expense incurred in viewing. If you have a property to sell you may wish to take advantage of our free valuation service. David James Estate Agents have established professional relationships with third-party suppliers for the provision of services to Clients. As remuneration for this professional relationship, the agent receives referral commission from the third-party company. David James Estate Agents receives the following commission from each third party supplier on a per referral basis: W A Barnes Ltd: £60 including VAT. All Moves UK Ltd: 18% including VAT of the invoice total (£107 including VAT average). MoveWithUs Limited: £188 including VAT (average).

Council Tax Band: A
Gedling Borough Council

DavidJames
the estate agent

David James Estate Agents
45b Plains Road, Mapperley, Nottingham, NG3 5JU
t: 0115 962 4213 e: lettings@david-james.com

naea | propertymark
PROTECTED

**The Property
Ombudsman**