



 4

 1

 1

 E

DavidJames
the estate agent

Forge Avenue, Calverton, Nottingham, NG14 6HU

£800 Per Calendar Month

About This Property

Located in the village of Calverton, this spacious semi-detached house is perfect for families seeking a comfortable home in a quiet cul-de-sac setting. The property boasts an entrance hall with a convenient cloakroom/WC and under-stair storage, a generous kitchen/dining room featuring ample storage units, and an integrated oven, hob, and extractor, and a spacious living room, complete with a decorative fireplace and dual aspect windows. Upstairs, there are four well-appointed bedrooms and a bathroom with a white suite and an electric shower. Outside, the property enjoys well-maintained front and rear lawns, and off-street parking for up to three cars. Located just moments from local schools, Calverton Leisure Centre, and other amenities, this home is perfectly positioned for village living with easy access to Nottingham.

TENANCY DETAILS

Available From: NOW

Tenancy Term: Minimum 6 months

Furnishing: Unfurnished

EPC Rating: E

Council Band: A

Pets: Not permitted



- Spacious semi-detached house
- Four bedrooms
- Entrance hall with cloakroom/WC
- Kitchen/dining room with integrated oven, hob & extractor
- Spacious living room with decorative fireplace
- Bathroom/WC with white suite and electric shower
- Gas central heating, double glazing
- Lawned front and rear gardens
- Off-street parking for up to three cars
- Amenities close by including schools and Calverton Leisure Centre





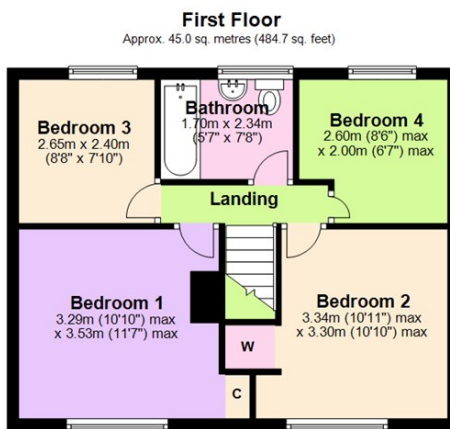
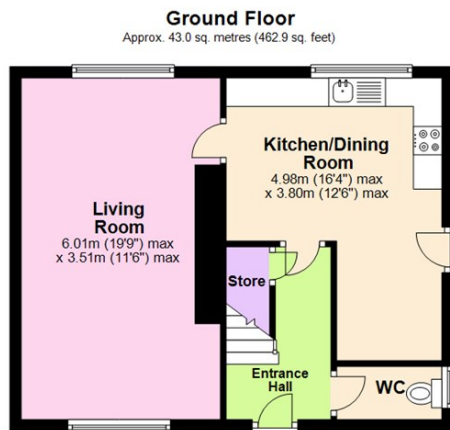

Total area: approx. 88.0 sq. metres (947.6 sq. feet)



These particulars are produced in good faith, are set out as a general guide only and do not constitute any part of a contract. No person in the employment of David James Estate Agents Ltd has any authority to make any representation whatsoever in relation to the property. All services, together with electrical fittings or fitted appliances have NOT been tested. All the measurements given in the details are approximate. Floor plans are for illustrative purposes only and are not drawn to scale. The position and size of doors, windows, appliances and other features are approximate only. The photographs of this property have been taken with a 10mm wide-angle lens. No responsibility can be accepted for any loss or expense incurred in viewing. If you have a property to sell you may wish to take advantage of our free valuation service. David James Estate Agents have established professional relationships with third-party suppliers for the provision of services to Clients. As remuneration for this professional relationship, the agent receives referral commission from the third-party company. David James Estate Agents receives the following commission from each third party supplier on a per referral basis: W A Barnes Ltd: £60 including VAT. All Moves UK Ltd: 18% including VAT of the invoice total (£107 including VAT average). MoveWithUs Limited: £188 including VAT (average).

Council Tax Band: A
Gedling Borough Council

DavidJames
the estate agent

David James Estate Agents
45b Plains Road, Mapperley, Nottingham, NG3 5JU
t: 0115 962 4213 e: lettings@david-james.com

naea | propertymark
PROTECTED

The Property Ombudsman