



 3

 1

 1

 D

DavidJames
the estate agent

Rosedale Road, Bakersfield, Nottingham, NG3 7GU

£1,100 Per Calendar Month

About This Property

This well-presented three-bedroom semi-detached house offers an ideal family home with spacious living areas and modern finishes throughout. The ground floor boasts a large lounge/dining room with a feature electric fire and dual aspect windows, filling the space with natural light, and the modern kitchen is fitted with sleek white gloss units and comes complete with an integrated oven, hob, and extractor fan. Upstairs, there are three bedrooms, two of which are generous doubles, along with a modern shower room and a separate WC for added convenience. Outside, the large rear garden features a paved patio, perfect for entertaining, while the front driveway provides off-street parking. Situated close to a variety of amenities and enjoying excellent transport links, this property is a must-see. VIDEO TOUR AVAILABLE!

TENANCY DETAILS

Available From: 10th October 2024

Tenancy Term: Minimum 6 months

Furnishing: Unfurnished

EPC Rating: D

Council Band: B

Pets: Not permitted

- Well-presented semi-detached house
- Three bedrooms (including two double bedrooms)
- Spacious lounge/dining room with feature electric fire
- Modern kitchen with integrated oven, hob & extractor
- Modern shower room and separate WC
- Double glazing
- Gas central heating
- Generous rear garden with paved patio area
- Driveway provides off-street parking
- Close to ample amenities and frequent bus links





Ground Floor

Approx. 37.5 sq. metres (403.4 sq. feet)

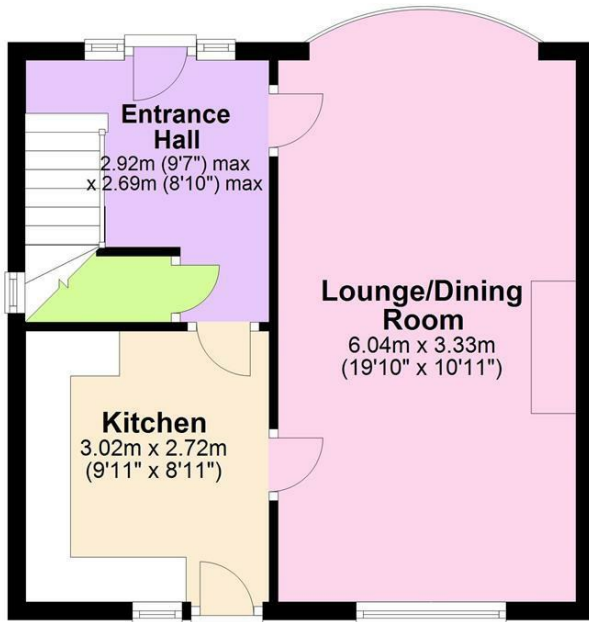

First Floor

Approx. 36.2 sq. metres (389.8 sq. feet)

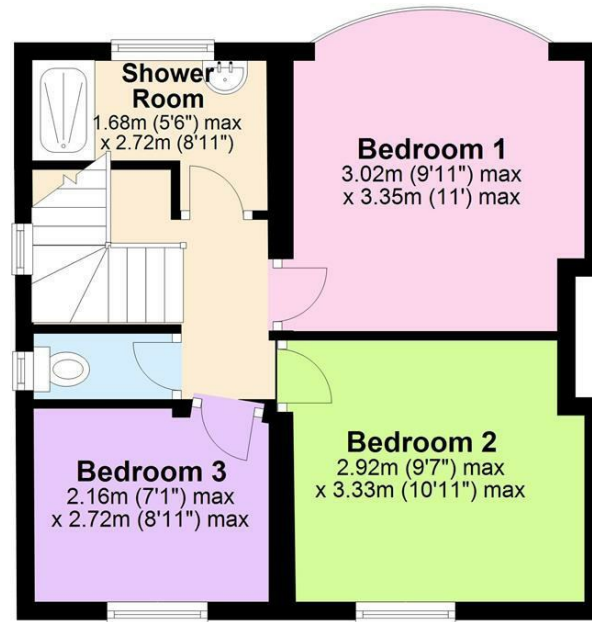

Total area: approx. 73.7 sq. metres (793.2 sq. feet)

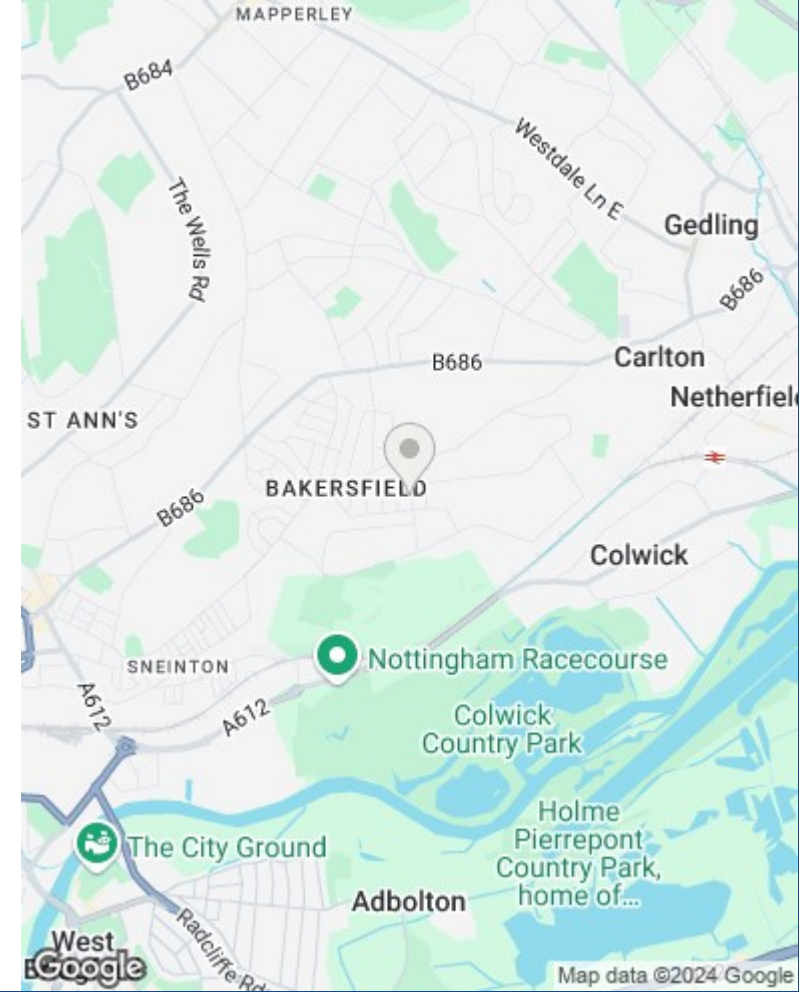

These particulars are produced in good faith, are set out as a general guide only and do not constitute any part of a contract. No person in the employment of David James Estate Agents Ltd has any authority to make any representation whatsoever in relation to the property. All services, together with electrical fittings or fitted appliances have NOT been tested. All the measurements given in the details are approximate. Floor plans are for illustrative purposes only and are not drawn to scale. The position and size of doors, windows, appliances and other features are approximate only. The photographs of this property have been taken with a 10mm wide-angle lens. No responsibility can be accepted for any loss or expense incurred in viewing. If you have a property to sell you may wish to take advantage of our free valuation service. David James Estate Agents have established professional relationships with third-party suppliers for the provision of services to Clients. As remuneration for this professional relationship, the agent receives referral commission from the third-party company. David James Estate Agents receives the following commission from each third party supplier on a per referral basis: W A Barnes Ltd: £60 including VAT. All Moves UK Ltd: 18% including VAT of the invoice total (£107 including VAT average). MoveWithUs Limited: £188 including VAT (average).

Council Tax Band: B
Nottingham City Council

DavidJames
the estate agent

David James Estate Agents
45b Plains Road, Mapperley, Nottingham, NG3 5JU
t: 0115 962 4213 e: lettings@david-james.com

naea | **propertymark**
PROTECTED

