



3



2



1



D

Eastdale Road, Bakersfield, Nottingham, NG3 7GE

DavidJames  
the estate agent

£1,300 Per Calendar Month



# About This Property

A beautifully presented, extended 3 bedroom semi-detached family home within easy reach of Carlton & Bakersfield's excellent range of amenities, variety of schools & frequent transport links to the city. There's an impressive entrance hall with cloakroom/WC, a spacious lounge with feature fireplace, versatile lean-to/conservatory, a stunning open plan dining kitchen with an excellent range of units & integrated appliances as well as a separate utility area whilst upstairs, the bedrooms are complemented by a variety of fitted wardrobes & a fantastic modern family bathroom with a separate shower cubicle. Outside, the property boasts a low maintenance rear garden as well as a generous driveway to the front. VIDEO TOUR AVAILABLE!

## TENANCY DETAILS

Available From: 27th June 2024

Tenancy Term: Minimum 6 months

Furnishing: Unfurnished

EPC Rating: D

Council Band: B

Pets: Not permitted

- Extended semi-detached family home
- Three bedrooms (including two double bedrooms with fitted wardrobes)
- Impressive entrance hall with cloakroom/WC
- Spacious lounge with feature fireplace
- Stunning dining kitchen with adjoining lean-to/conservatory
- A generous range of units & appliances with a separate utility area
- Fantastic first floor family bathroom with separate shower cubicle
- Low maintenance rear garden
- Driveway for multiple vehicles to the front
- Within easy reach of Carlton & Bakersfield's excellent range of amenities









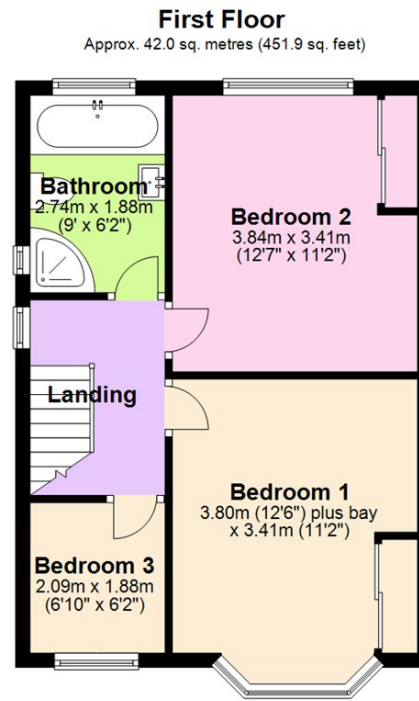
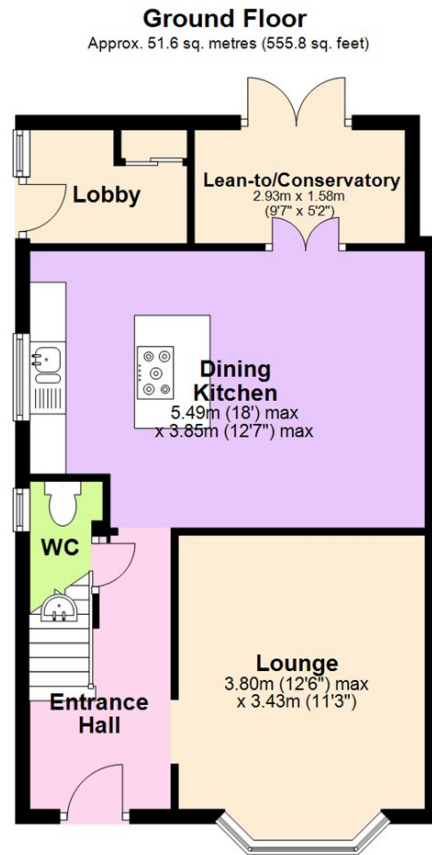

Total area: approx. 93.6 sq. metres (1007.8 sq. feet)

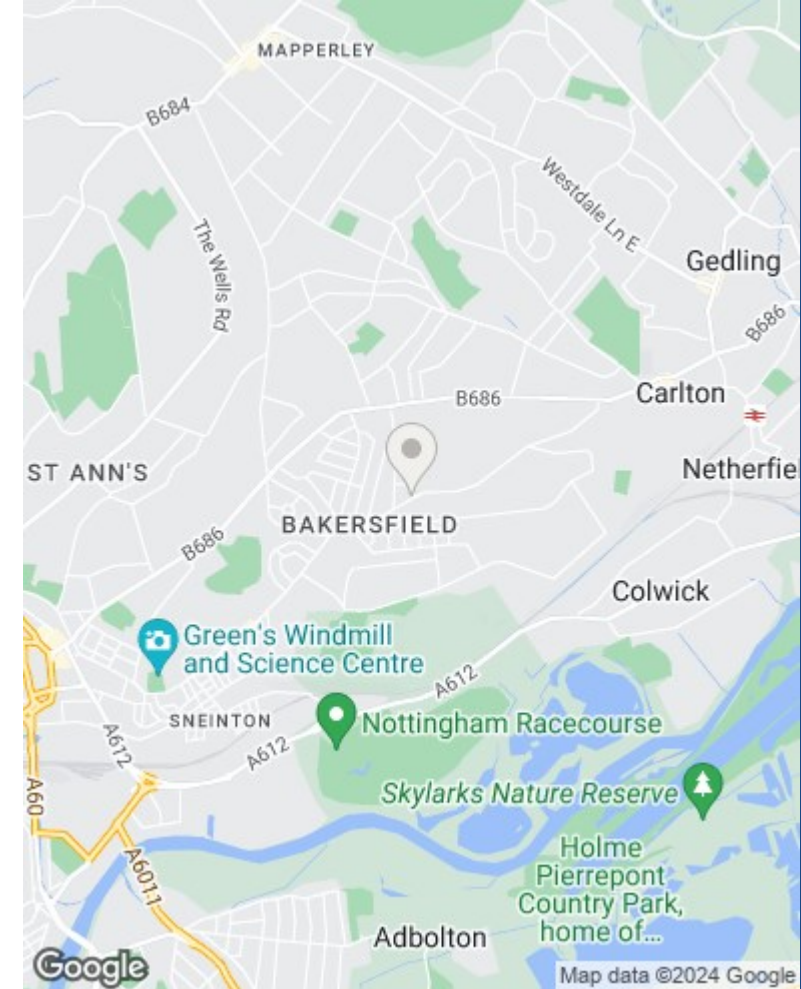

These particulars are produced in good faith, are set out as a general guide only and do not constitute any part of a contract. No person in the employment of David James Estate Agents Ltd has any authority to make any representation whatsoever in relation to the property. All services, together with electrical fittings or fitted appliances have NOT been tested. All the measurements given in the details are approximate. Floor plans are for illustrative purposes only and are not drawn to scale. The position and size of doors, windows, appliances and other features are approximate only. The photographs of this property have been taken with a 10mm wide-angle lens. No responsibility can be accepted for any loss or expense incurred in viewing. If you have a property to sell you may wish to take advantage of our free valuation service. David James Estate Agents have established professional relationships with third-party suppliers for the provision of services to Clients. As remuneration for this professional relationship, the agent receives referral commission from the third-party company. David James Estate Agents receives the following commission from each third party supplier on a per referral basis: W A Barnes Ltd: £60 including VAT. All Moves UK Ltd: 18% including VAT of the invoice total (£107 including VAT average). MoveWithUs Limited: £188 including VAT (average).

**Council Tax Band: B**  
**Nottingham City Council**

**DavidJames**  
the estate agent

David James Estate Agents  
45b Plains Road, Mapperley, Nottingham, NG3 5JU  
t: 0115 962 4213 e: lettings@david-james.com

naea | propertymark  
**PROTECTED**

**The Property Ombudsman**