



DavidJames
the estate agent

Bakewell Drive, Top Valley, Nottingham, NG5 9AE

£1,200 Per Calendar Month

About This Property

A well-presented three-storey townhouse with convenient amenities and bus links nearby. Upon entry, you're greeted by an inviting entrance hall boasting a convenient cloakroom/WC, leading to a modern kitchen equipped with appliances. The ground floor further extends into a spacious lounge/dining room with feature fireplace and French doors, seamlessly connecting indoor and outdoor living. Ascending to the first floor reveals two generously sized double bedrooms and a bathroom/WC with a white suite and mixer shower, whilst the second floor boasts a capacious double bedroom, complete with built-in wardrobes and an en-suite shower room/WC with ample space for additional storage. Outside, there is a private enclosed rear garden, an allocated off-street parking bay and garage, enhancing convenience for residents. VIDEO TOUR AVAILABLE!

TENANCY DETAILS

Available From: NOW

Tenancy Term: Minimum 6 months

Furnishing: Unfurnished

EPC Rating: C

Council Band: C

Pets: Not permitted

- Well-presented three-storey townhouse
- Three double bedrooms
- Entrance hall with cloakroom/WC
- Kitchen with appliances
- Lounge/dining room with feature fireplace & French doors
- First floor bathroom/WC with white suite & mixer shower
- En-suite shower room to bedroom one (located on the top floor)
- UPVC double glazing, gas central heating
- Private rear garden
- Off-street parking space & garage





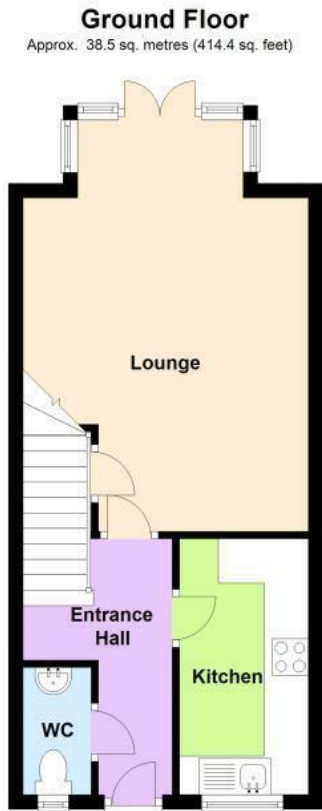

Total area: approx. 94.0 sq. metres (1011.4 sq. feet)

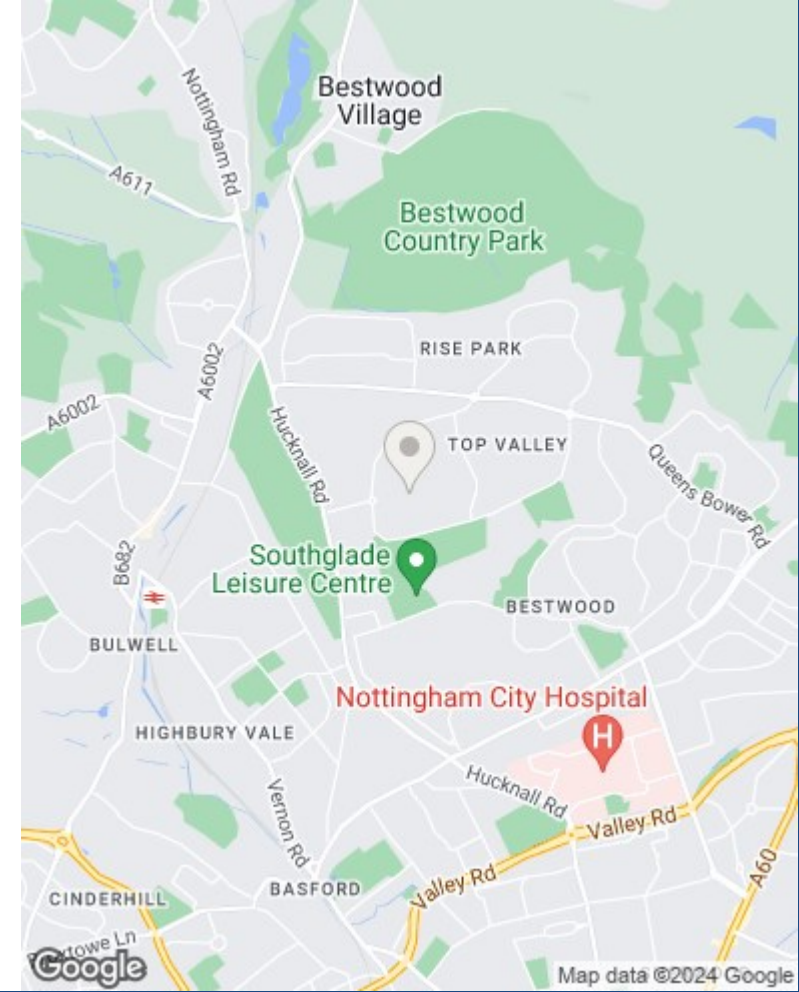

These particulars are produced in good faith, are set out as a general guide only and do not constitute any part of a contract. No person in the employment of David James Estate Agents Ltd has any authority to make any representation whatsoever in relation to the property. All services, together with electrical fittings or fitted appliances have NOT been tested. All the measurements given in the details are approximate. Floor plans are for illustrative purposes only and are not drawn to scale. The position and size of doors, windows, appliances and other features are approximate only. The photographs of this property have been taken with a 10mm wide-angle lens. No responsibility can be accepted for any loss or expense incurred in viewing. If you have a property to sell you may wish to take advantage of our free valuation service. David James Estate Agents have established professional relationships with third-party suppliers for the provision of services to Clients. As remuneration for this professional relationship, the agent receives referral commission from the third-party company. David James Estate Agents receives the following commission from each third party supplier on a per referral basis: W A Barnes Ltd: £60 including VAT. All Moves UK Ltd: 18% including VAT of the invoice total (£107 including VAT average). MoveWithUs Limited: £188 including VAT (average).

Council Tax Band: C
Nottingham City Council

DavidJames
the estate agent

David James Estate Agents
45b Plains Road, Mapperley, Nottingham, NG3 5JU
t: 0115 962 4213 e: lettings@david-james.com

naea | propertymark
PROTECTED

The Property Ombudsman