



DavidJames
the estate agent

Marnham Drive, Mapperley, Nottingham, NG3 5HG

£795 Per Calendar Month

About This Property

Introducing an exceptional opportunity in Mapperley, this BRAND NEW development presents high-spec self-contained flats. With six flats available on the 1st and 2nd floors, each residence showcases a contemporary open plan living space seamlessly integrated with modern fitted kitchens (complete with integrated fridge/freezer, washing machine, dishwasher, electric hob and oven), alongside a spacious double bedroom and a sleek shower room. The development further elevates living standards with CCTV security, and secure gated access. Ideally situated near Mapperley Top, and boasting immediate access to regular bus links to Nottingham City Centre, these flats are ideally suited for discerning working professionals seeking comfort, convenience, and contemporary living.

TENANCY DETAILS

Available From: NOW

Tenancy Term: Minimum 6 months

Furnishing: Unfurnished

Bills: Electric, heating, water and high-speed fibre broadband can be included for an additional £150pcm

EPC Rating: C

Council Band: TBC

Pets: Not permitted

- Brand new development in Mapperley
- High spec self-contained flats
- Six one-bed flats available to the 1st and 2nd floors
- Contemporary open plan living areas
- Modern fitted kitchens with integrated fridge/freezer, washing machine, dishwasher, electric hob and oven
- Sleek shower rooms
- UPVC double glazing
- CCTV, Secure gated access
- Electric, heating, water and high-speed fibre broadband can be included for an additional £150pcm.
- Ideal for working professionals!





First Floor

Approx. 31.7 sq. metres (340.8 sq. feet)

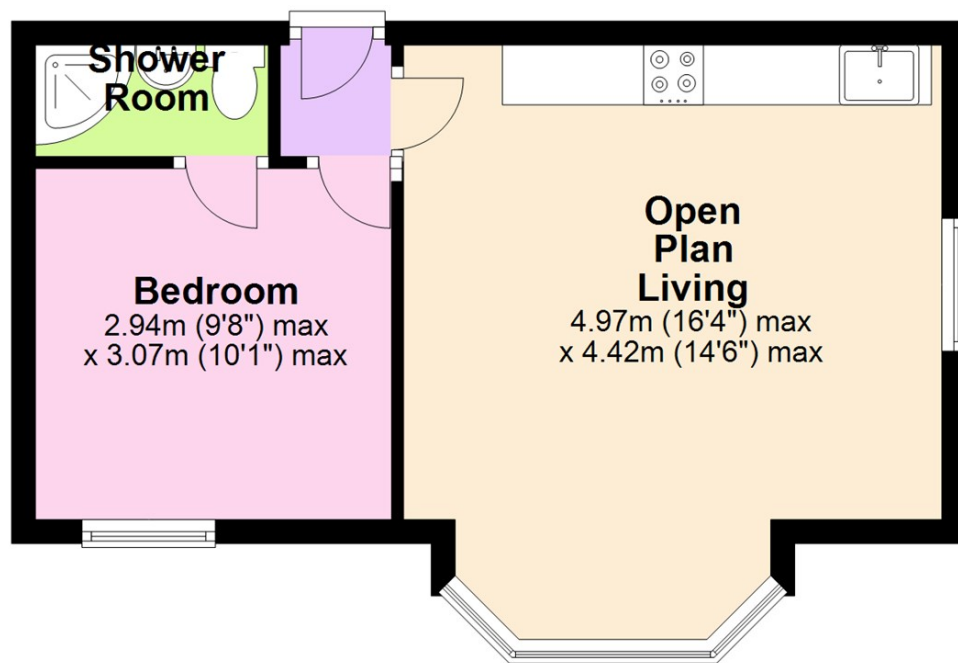

Total area: approx. 31.7 sq. metres (340.8 sq. feet)

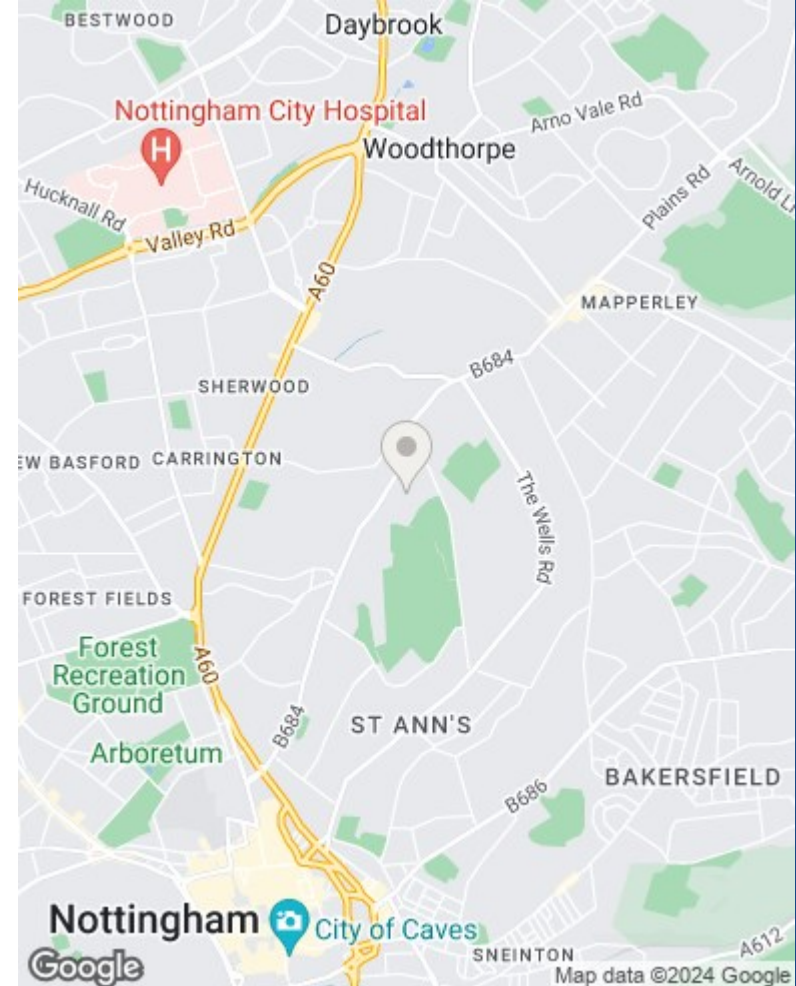

These particulars are produced in good faith, are set out as a general guide only and do not constitute any part of a contract. No person in the employment of David James Estate Agents Ltd has any authority to make any representation whatsoever in relation to the property. All services, together with electrical fittings or fitted appliances have NOT been tested. All the measurements given in the details are approximate. Floor plans are for illustrative purposes only and are not drawn to scale. The position and size of doors, windows, appliances and other features are approximate only. The photographs of this property have been taken with a 10mm wide-angle lens. No responsibility can be accepted for any loss or expense incurred in viewing. If you have a property to sell you may wish to take advantage of our free valuation service. David James Estate Agents have established professional relationships with third-party suppliers for the provision of services to Clients. As remuneration for this professional relationship, the agent receives referral commission from the third-party company. David James Estate Agents receives the following commission from each third party supplier on a per referral basis: W A Barnes Ltd: £60 including VAT. All Moves UK Ltd: 18% including VAT of the invoice total (£107 including VAT average). MoveWithUs Limited: £188 including VAT (average).

**Council Tax Band: New Build
Nottingham City Council**

DavidJames
the estate agent

David James Estate Agents
45b Plains Road, Mapperley, Nottingham, NG3 5JU
t: 0115 962 4213 e: lettings@david-james.com

naea | propertymark
PROTECTED

**The Property
Ombudsman**