



**DavidJames**  
the estate agent

**Ashwater Drive, Mapperley Plains, Nottingham, NG3 5SJ**

**£1,200 Per Calendar Month**

# About This Property

Nestled in the sought-after locale of Mapperley Plains, this deceptive detached bungalow offers an idyllic blend of comfort and convenience. Boasting a prime corner position, residents are treated to proximity to Gedling Country Park and the vibrant amenities of Mapperley. Step into the welcoming entrance hall, complete with ample storage, leading to a cloakroom/WC. There is a newly fitted kitchen, replete with modern appliances and a spacious living/dining room, accentuated by a feature fireplace, seamlessly flowing into a charming conservatory through sliding patio doors, perfect for relaxation or entertainment. There are three bedrooms, including one with fitted wardrobes, complimented by the bathroom/WC with a white suite and electric shower. Outside, a gated driveway leads to a detached garage, complemented by a low-maintenance paved rear garden, providing a serene outdoor escape. An opportunity not to be missed! VIDEO TOUR AVAILABLE!

## TENANCY DETAILS

Available From: 1st April 2024

Tenancy Term: Minimum 6 months

Furnishing: Unfurnished

EPC Rating: TBC

Council Band: D

Pets: Considered



- Deceptive detached bungalow
- Three bedrooms (bedroom one with fitted wardrobes)
- Entrance hall with useful storage and cloakroom/Wc
- Newly fitted modern kitchen with appliances
- Spacious living/dining room with feature fireplace and adjoining conservatory
- Bathroom/Wc with white suite & electric shower
- UPVC double glazing, gas central heating
- Low maintenance paved rear garden
- Gated driveway leading to a detached garage
- Close to Gedling Country Park and Mapperley's fantastic amenities





**Ground Floor**  
Approx. 102.3 sq. metres (1101.3 sq. feet)

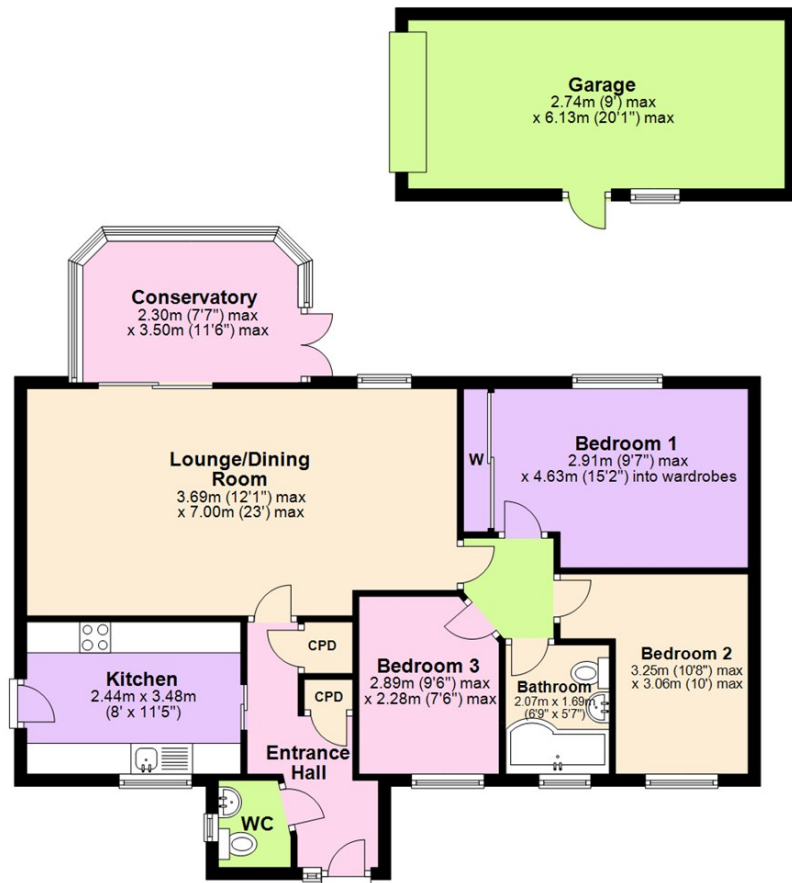

Total area: approx. 102.3 sq. metres (1101.3 sq. feet)

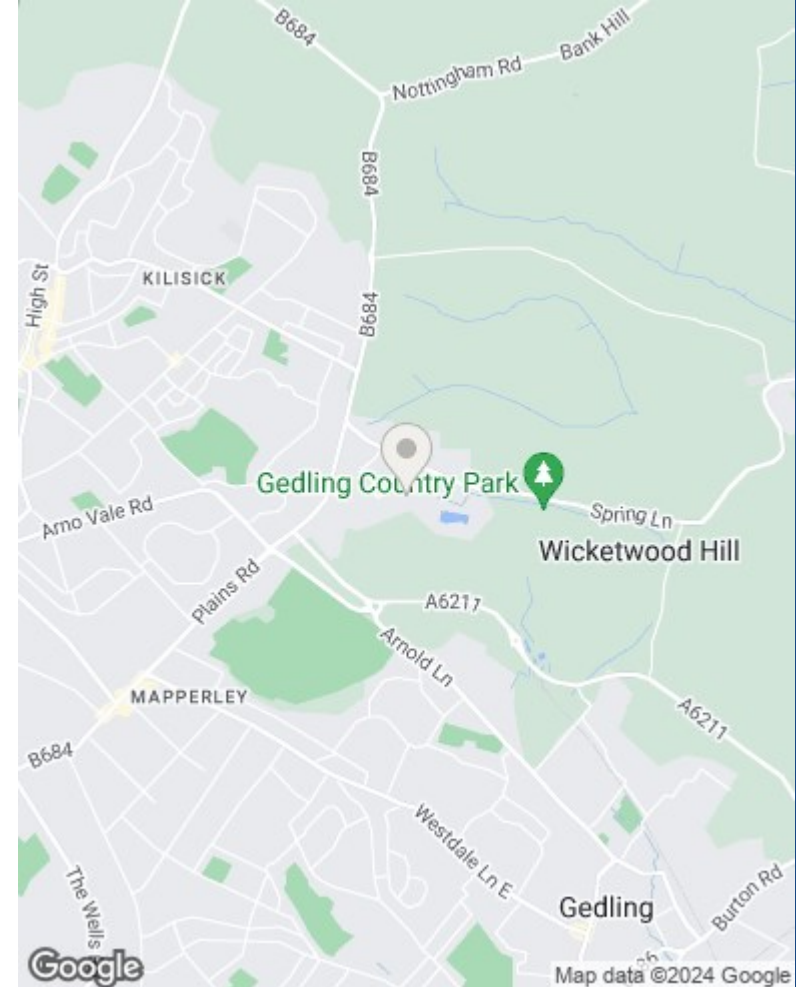

These particulars are produced in good faith, are set out as a general guide only and do not constitute any part of a contract. No person in the employment of David James Estate Agents Ltd has any authority to make any representation whatsoever in relation to the property. All services, together with electrical fittings or fitted appliances have NOT been tested. All the measurements given in the details are approximate. Floor plans are for illustrative purposes only and are not drawn to scale. The position and size of doors, windows, appliances and other features are approximate only. The photographs of this property have been taken with a 10mm wide-angle lens. No responsibility can be accepted for any loss or expense incurred in viewing. If you have a property to sell you may wish to take advantage of our free valuation service. David James Estate Agents have established professional relationships with third-party suppliers for the provision of services to Clients. As remuneration for this professional relationship, the agent receives referral commission from the third-party company. David James Estate Agents receives the following commission from each third party supplier on a per referral basis: W A Barnes Ltd: £60 including VAT. All Moves UK Ltd: 18% including VAT of the invoice total (£107 including VAT average). MoveWithUs Limited: £188 including VAT (average).

**Council Tax Band: D**  
**Gedling Borough Council**

**DavidJames**  
the estate agent

David James Estate Agents  
45b Plains Road, Mapperley, Nottingham, NG3 5JU  
t: 0115 962 4213 e: lettings@david-james.com

naea | **propertymark**  
**PROTECTED**

**The Property Ombudsman**