

the floorplan...

GROUND FLOOR
538 sq.ft. (50.0 sq.m.) approx.

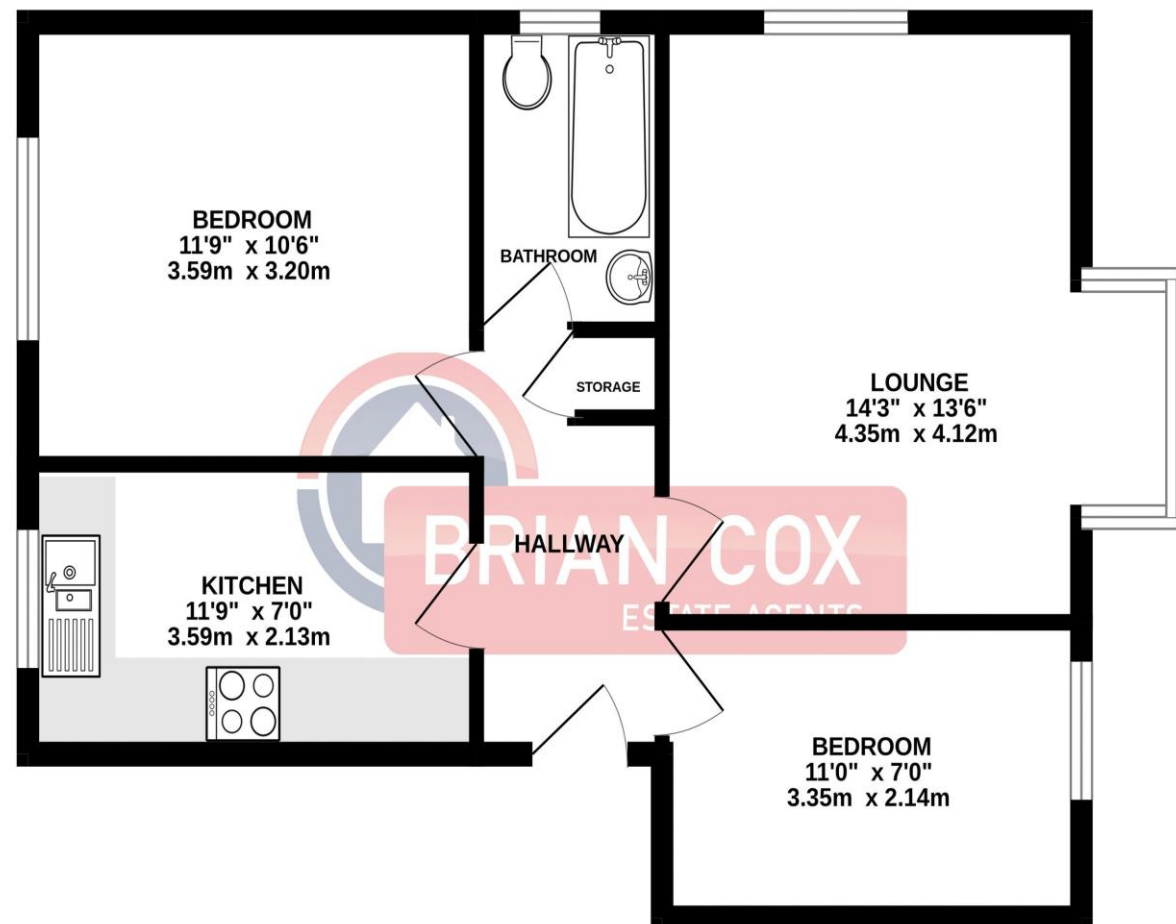

TOTAL FLOOR AREA : 538 sq.ft. (50.0 sq.m.) approx.
Whilst every attempt has been made to ensure the accuracy of the floorplan contained here, measurements of doors, windows, rooms and any other items are approximate and no responsibility is taken for any error, omission or mis-statement. This plan is for illustrative purposes only and should be used as such by any prospective purchaser. The services, systems and appliances shown have not been tested and no guarantee as to their operability or efficiency can be given.
Made with Metropix ©2025

more details from...

call: **Brian Cox Greenford: 0208 912 0006**

email: **daniel.jed@brian-cox.co.uk**

web: **www.brian-cox.co.uk**



Consumer Protection from Unfair Trading Regulations 2008 We have not tested any apparatus, equipment, fixtures, fittings or services and so cannot verify that they are in working order or fit for purpose. You are advised to obtain verification from your solicitor or surveyor. References to the tenure of a property are based on information supplied by the seller. We have not had sight of the title documents and a buyer is advised to obtain verification from their solicitor. Items shown in photographs are not included unless specifically mentioned within the sales particulars, but may be available by separate negotiation. We advise you to book an appointment to view before embarking on any journey to see a property, and check its availability.



0208 912 0006
brian-cox.co.uk



*** 500 POUND CASHBACK WHEN BOUGHT THROUGH BRIAN COX *** TWO BEDROOM - GROUND FLOOR - GARAGE - NO CHAIN. Brian Cox and Company are delighted to bring to the market this newly modernised two-bedroom purpose-built ground floor flat. The property is conveniently located within easy reach of harrow town centre as well as numerous other local amenities. It briefly comprises two double bedrooms, a bright 14ft lounge, family bathroom and a modern fitted kitchen. Further benefits include permit parking, garage and no onward chain. Viewings are available now so call to arrange yours and avoid disappointment!!



£340,000
Leasehold

Neptune Road, Harrow HA1 4YN



in brief...

- Two Bedroom
- Ground Floor Purpose Built Flat
- Newly Refurbished
- Permit Parking
- Garage
- Electric Heating Throughout



the location...

nearest stations ...

West Harrow (0.4 miles)
Harrow-on-the-Hill (0.4 miles)
North Harrow (0.8 miles)

Harrow is a large suburban town in the London Borough of Harrow, North West London, England. It is centred 10.5 miles (16.9 km) North West of Charing Cross.

Harrow has two large shopping centres which are St Anns and St Georges with its many large department stores, restaurants, cafes and cinema.

There are many local schools in the area some of these include Norbury School, Vaughan Primary School, St Anselm's Catholic Primary School, The Jubilee Academy and Whitmore High School.



0208 912 0006

brian-cox.co.uk