

the floorplan...

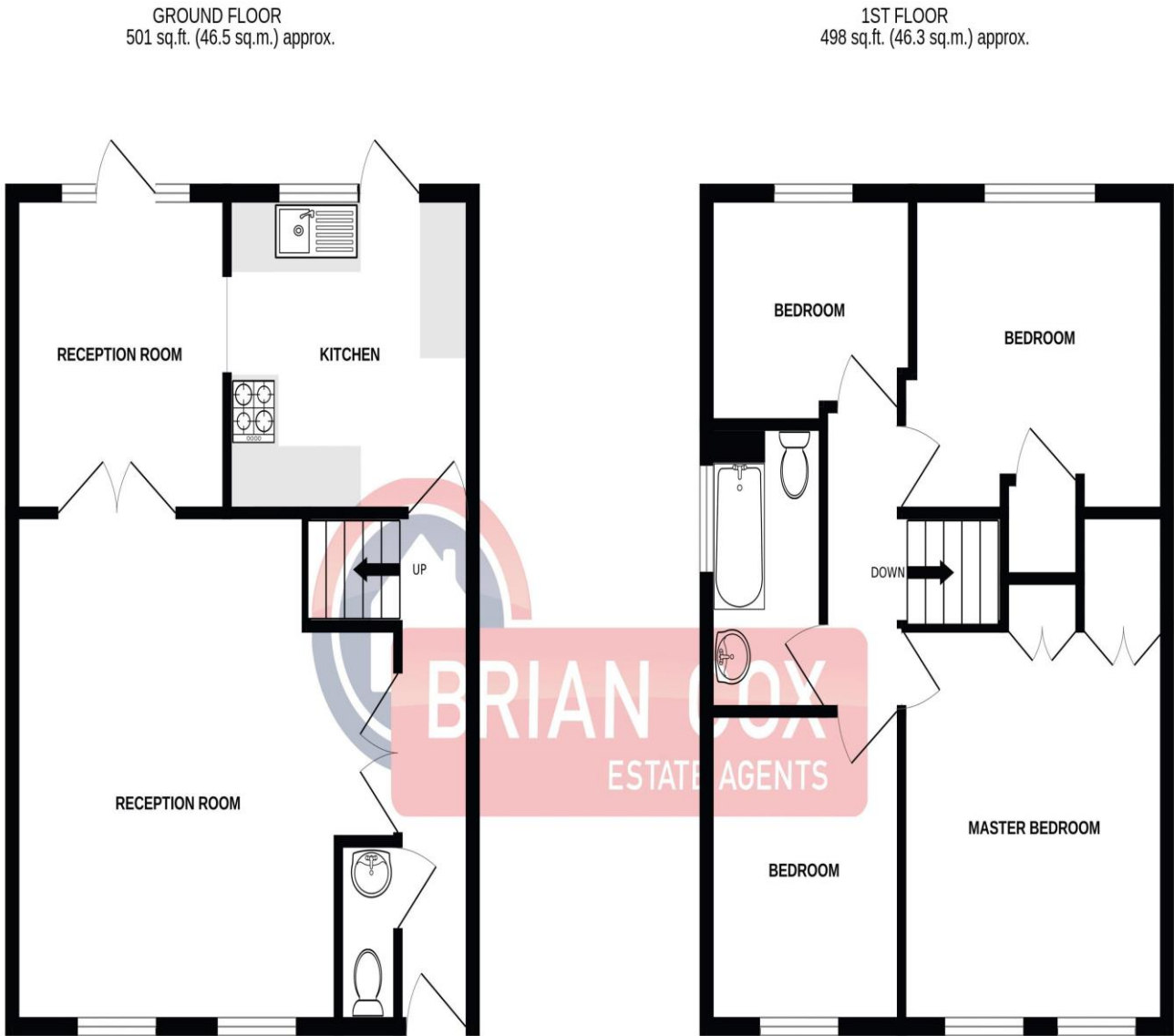

TOTAL FLOOR AREA : 999 sq.ft. (92.8 sq.m.) approx.
Whilst every attempt has been made to ensure the accuracy of the floorplan contained here, measurements of doors, windows, rooms and any other items are approximate and no responsibility is taken for any error, omission or mis-statement. This plan is for illustrative purposes only and should be used as such by any prospective purchaser. The services, systems and appliances shown have not been tested and no guarantee as to their operability or efficiency can be given.
Made with Metropix ©2025

more details from...

call: **Brian Cox Harrow: 0208 912 0006**
email: **info@brian-cox.co.uk**
web: **www.brian-cox.co.uk**



Consumer Protection from Unfair Trading Regulations 2008 We have not tested any apparatus, equipment, fixtures, fittings or services and so cannot verify that they are in working order or fit for purpose. You are advised to obtain verification from your solicitor or surveyor. References to the tenure of a property are based on information supplied by the seller. We have not had sight of the title documents and a buyer is advised to obtain verification from their solicitor. Items shown in photographs are not included unless specifically mentioned within the sales particulars, but may be available by separate negotiation. We advise you to book an appointment to view before embarking on any journey to see a property, and check its availability.



0208 912 0006
brian-cox.co.uk



Brian Cox & Company are proud to present to the market this bright and spacious four-bedroom mock Georgian style property situated on a quiet cul de sac, a stones throw away from Harrow- on-the-Hill Village. The property benefits from a large lounge leading into a dining area with featured doors leading out onto a spacious rear garden with raised lawn area with magnificent views over the surrounding landscape. To the first floor there are four bedrooms with fitted wardrobes, and a family bathroom. To the outside there is private parking and a garage in a nearby neighbouring block. With its unique combination of both tranquility and convenience, this property must be seen to be fully appreciated.



£750,000
Freehold

Pickwick Place, Harrow HA1 3BG



in brief...

- SEMI DETACHED
- 4 BEDROOMS
- CHAIN FREE
- IDYLIC LOCATION
- PARKING
- GARAGE



the location...

nearest stations ...

Harrow-on-the-Hill (0.2 miles)
West Harrow (0.7 miles)
Northwick Park (0.9 miles)

Harrow is a large suburban town in the London Borough of Harrow, North West London, England. It is centred 10.5 miles (16.9 km) North West of Charing Cross.

Harrow has two large shopping centres which are St Anns and St Georges with its many large department stores, restaurants, cafes and cinema.

There are many local schools in the area some of these include Norbury School, St Anselm's Catholic Primary School, Marlborough Primary School and Elmgrove Primary School & Nursery.