

the floorplan...

GROUND FLOOR
585 sq.ft. (54.3 sq.m.) approx.

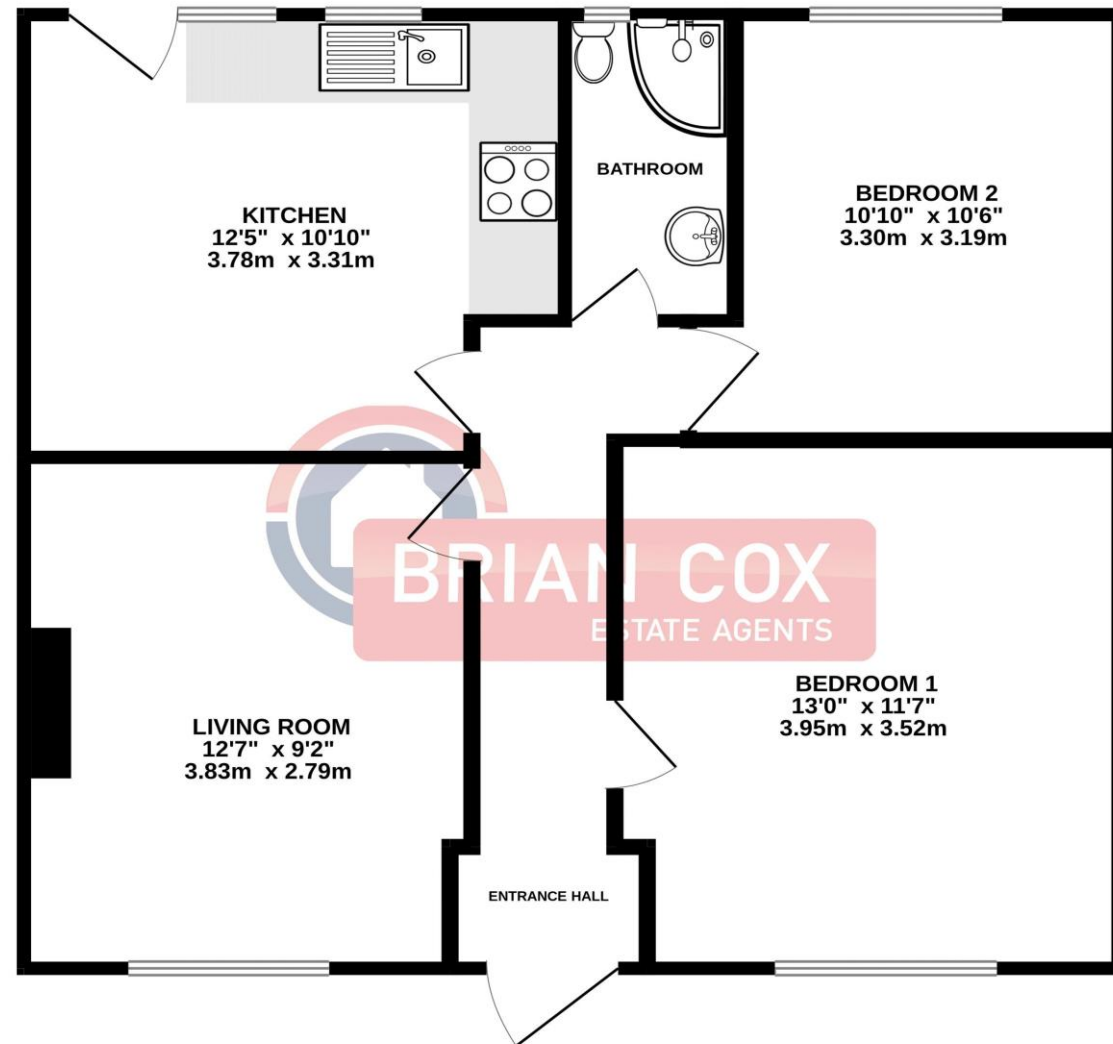

TOTAL FLOOR AREA : 585 sq.ft. (54.3 sq.m.) approx.
Whilst every attempt has been made to ensure the accuracy of the floorplan contained here, measurements of doors, windows, rooms and any other items are approximate and no responsibility is taken for any error, omission or mis-statement. This plan is for illustrative purposes only and should be used as such by any prospective purchaser. The services, systems and appliances shown have not been tested and no guarantee as to their operability or efficiency can be given.
Made with Metropix ©2024

more details from...

call: **Brian Cox Harrow: 020 8912 0006**
email: info@brian-cox.co.uk
web: www.brian-cox.co.uk



Consumer Protection from Unfair Trading Regulations 2008 We have not tested any apparatus, equipment, fixtures, fittings or services and so cannot verify that they are in working order or fit for purpose. You are advised to obtain verification from your solicitor or surveyor. References to the tenure of a property are based on information supplied by the seller. We have not had sight of the title documents and a buyer is advised to obtain verification from their solicitor. Items shown in photographs are not included unless specifically mentioned within the sales particulars, but may be available by separate negotiation. We advise you to book an appointment to view before embarking on any journey to see a property, and check its availability.



020 8912 0006
brian-cox.co.uk



Brian Cox and Company are delighted to bring to the market this immaculately presented two bedroom second floor flat on the borders of Kenton and Queensbury. The Property briefly comprises two double bedrooms, a bright lounge, fitted kitchen/diner and a modern shower room. Further benefits include double glazing, electric heating, no onward chain and a new lease on completion. Viewings are recommended so call now to arrange yours!!



£275,000
Leasehold

Queensbury Circle Parade,
HA3 9HH



in brief...

- Two Bedroom
- Second Floor Apartment
- Immaculate Condition
- No Chain
- Popular Location
- View Now



the location...

nearest stations ...

- Queensbury (0.7m)
- Canons Park (1.1m)
- Kingsbury (1.2m)

Queensbury is an area of northwest London, England, in the southeast of the London Borough of Harrow on the boundary with the London Borough of Brent. The area is split between four postal districts: Harrow HA3, Stanmore HA7, Edgware HA8, and London NW9.

Kenton is an area in North West London, England, partly in the London Borough of Harrow and partly in the London Borough of Brent. Kenton is served by three train stations these are Kenton Station (Bakerloo Line & Watford DC Line), South Kenton Station (Bakerloo Line & Watford DC) and Northwick Park Station (Metropolitan Line)

The Queensbury suburb was built by Percy Harold Edwards (1886-1937). The name was chosen in a newspaper competition he inaugurated. From 1916 Queensbury was the site of the Stag Lane Aerodrome.

The area around Queensbury Circle and Honeypot Lane is in the HA postcode area and the area south east of Queensbury tube station is in the NW postcode area. Queensbury tube station is on the Jubilee line. Queensbury neighbours the district of Kingsbury in the London Borough of Brent.

