

the floorplan...

GROUND FLOOR
33 sq. ft. (3.1 sq.m.) approx.

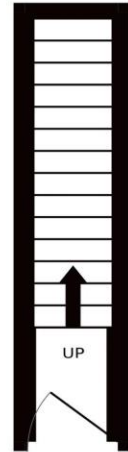

FIRST FLOOR
429 sq. ft. (39.9 sq.m.) approx.

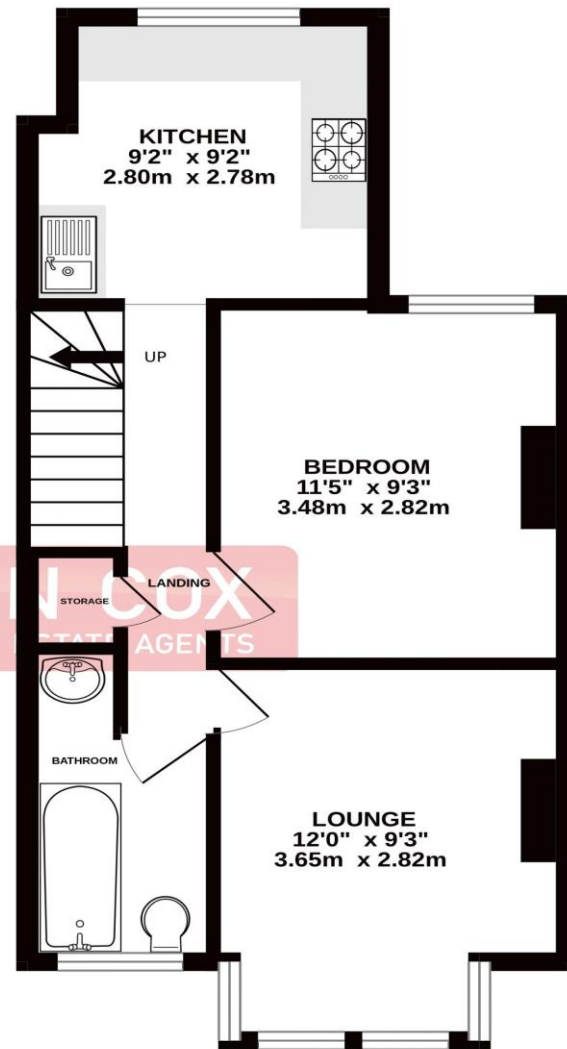

TOTAL FLOOR AREA : 463 sq.ft. (43.0 sq.m.) approx.

Whilst every attempt has been made to ensure the accuracy of the floorplan contained here, measurements of doors, windows, rooms and any other items are approximate and no responsibility is taken for any error, omission or mis-statement. This plan is for illustrative purposes only and should be used as such by any prospective purchaser. The services, systems and appliances shown have not been tested and no guarantee as to their operability or efficiency can be given.
Made with Metropix ©2024

more details from...

call: **Brian Cox Harrow: 020 8912 0006**
email: info@brian-cox.co.uk
web: www.brian-cox.co.uk



Consumer Protection from Unfair Trading Regulations 2008 We have not tested any apparatus, equipment, fixtures, fittings or services and so cannot verify that they are in working order or fit for purpose. You are advised to obtain verification from your solicitor or surveyor. References to the tenure of a property are based on information supplied by the seller. We have not had sight of the title documents and a buyer is advised to obtain verification from their solicitor. Items shown in photographs are not included unless specifically mentioned within the sales particulars, but may be available by separate negotiation. We advise you to book an appointment to view before embarking on any journey to see a property, and check its availability.



020 8912 0006
brian-cox.co.uk



Brian Cox and Company are thrilled to bring to the market this rarely available one bedroom first floor flat. The property is located within an easy 0.2 mile walk of Harrow Wealdstone tube and overground station which make this a very convenient location for those commuting. Further benefits include gas central heating, no onward chain and an 11ft main bedroom. Viewings are highly recommended so call now to arrange yours!!



Offers in Excess of
£210,000

Herga Road, Harrow
HA3 5AU



in brief...

- One Bedroom
- First Floor Flat
- In Need of Modernisation
- No Chain
- Convenient Location
- View Now



the location...

nearest stations ...

Harrow & Wealdstone (0.2 miles)
Harrow-on-the-Hill (0.9 miles)
North Harrow (1.0 miles)

Harrow is a large suburban town in the London Borough of Harrow, North West London, England. It is centred 10.5 miles (16.9 km) North West of Charing Cross.

Harrow has two large shopping centres which are St Anns and St Georges with its many large department stores, restaurants, cafes and cinema.

There are many local schools in the area some of these include Elmgrove Primary School & Nursery, Marlborough Primary School, Belmont School, The Sacred Heart Language College and Whitefriars School.